

CARBURETOR MODEL: DY-10A
 "Thermo King" Rail Car Refrigeration
 Unit W/Crosley, 4 Cyl. Engine.

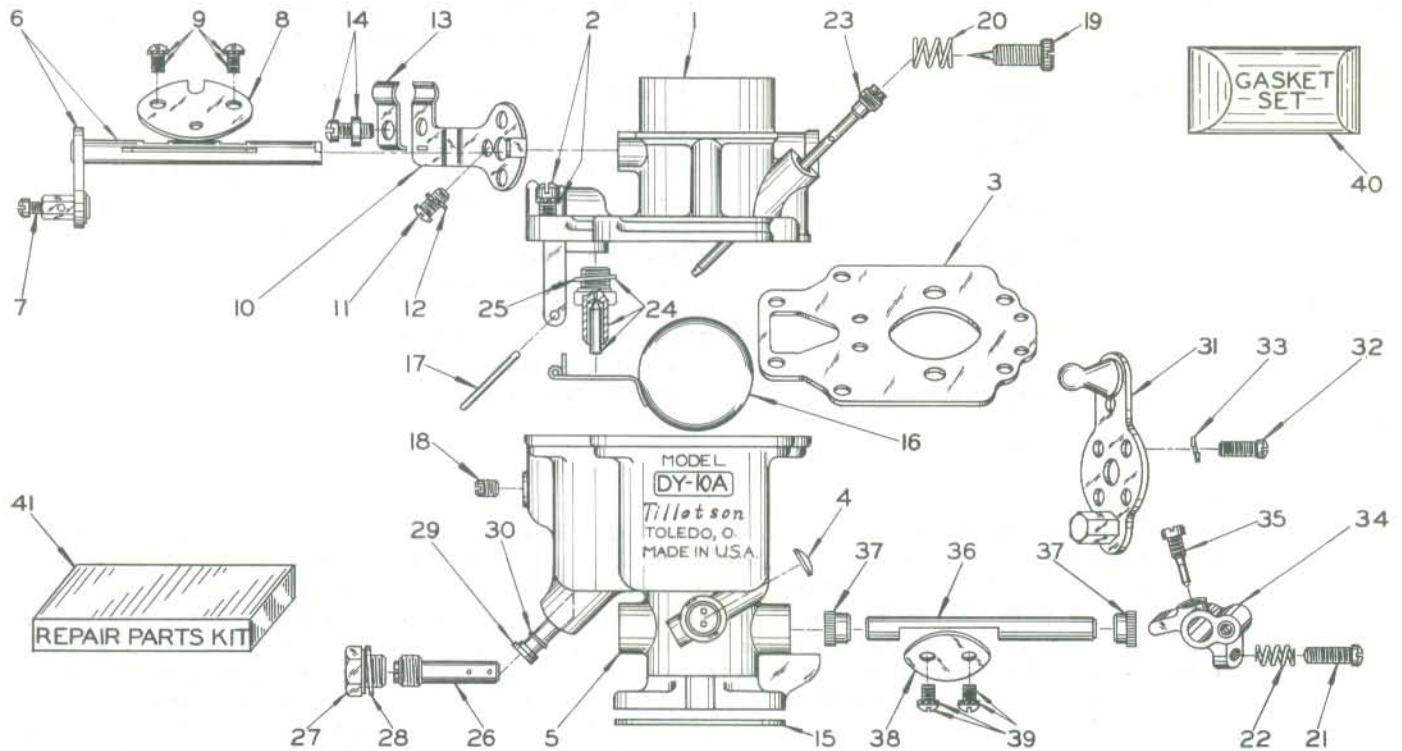

WHEN ORDERING, PLEASE SPECIFY FULL CARBURETOR MODEL AND COMPLETE PART NUMBER, NAME AND PRICE.

Ref. No.	DY-10A Part No.	Part Name
1	07809	Air Horn
2	08420	Air Horn Retaining Screw & Lockwasher (6)
3	06409	Air Horn Gasket
4	02531	*Body Channel Welch Plug
5	09228	Body (Includes Shaft & Shutter)
6	08334	Choke Shaft & Lever
7	058	*Choke Wire Retaining Screw
8	07437	Choke Shutter
9	08317	Choke Shutter Screw & Lockwasher (2)
10	05404	Choke Wire Bracket
11	01974	Choke Wire Bracket Retaining Screw (2)
12	0992	Choke Wire Bracket Retaining Screw Lockwasher (2)
13	03028	Choke Wire Clamp
14	0799	Choke Wire Clamp Bolt & Nut
15	0278	Flange Gasket
16	06436	Float
17	06233	*Float Lever Pin

TILLOTSON MANUFACTURING CO.
 PARTS AND SERVICE DIVISION
 TOLEDO 12, OHIO, U. S. A.

Specifications or part numbers subject to change.

Ref. No.	DY-10A Part No.	Part Name
18	03311	*Float Bowl Inspection Screw
19	06336	*Idle Adjustment Screw
20	0737	*Idle Adjustment Spring
21	05095	Idle Speed Regulating Screw
22	0788	*Idle Speed Regulating Screw Spring
23	07009	*Idle Tube
24	06287	*Inlet Needle, Seat & Gasket
25	0676	Inlet Seat Gasket
26	09226	*Main Nozzle
27	0649	*Main Nozzle Channel Plug Screw
28	0225	Main Nozzle Channel Plug Screw Gasket
29	06406	Main Nozzle Outlet Tube
30	06407	Main Nozzle Outlet Tube Gasket
31	08546	Throttle Lever
32	0240	Throttle Lever Retaining Screw
33	0992	Throttle Lever Retaining Screw Lockwasher
34	06355	Throttle Stop Lever
35	051	*Throttle Stop Lever Retaining Screw
36	06363	*Throttle Shaft
37	02661	Throttle Shaft Bushing (2)
38	07008	Throttle Shutter
39	08317	*Throttle Shutter Screw & Lockwasher (2)
40	07145	*GASKET & PACKING SET
41	09329	REPAIR PARTS KIT

(*) Indicates contents of REPAIR PARTS KIT.

FLOAT LEVEL: To correctly set Float Level, remove Upper Body Assembly containing complete float mechanism. Turn upside down and with Float Lever resting on the Inlet Needle, carefully bend EACH Lever Arm, if necessary, to give a distance of one and twenty-nine sixty-fourths (1-29/64ths) inches from face of Air Horn Gasket to the then top of raised seam encircling each Float. The measurements must be maintained with both Floats to obtain proper performance. As a guide, the Fuel Level will be found, after carburetor assembly, just below lowest portion of Fuel Level Inspection Hole. When inspection indicates level continues to rise beyond setting point, remove Inlet Needle and Seat, clean their seating surfaces with a soft clean cloth. Place Inlet Needle in its Seat and tap very lightly, turning Inlet Needle with thumb and forefinger several times to reseat. Reinstall, and if proper level is not maintained, install a new Inlet Needle, Seat and Gasket. DO NOT CHANGE GASOLINE LEVEL FROM MANUFACTURERS SPECIFICATIONS.

IDLE MIXTURE ADJUSTMENT: Open Idle Adjustment Screw (Ref. 19) one (1) full turn open from closed position. This should approximate the final setting for the Idle Adjustment Screw. After making this adjustment, choke engine and start in usual manner.

Revised 7/52