

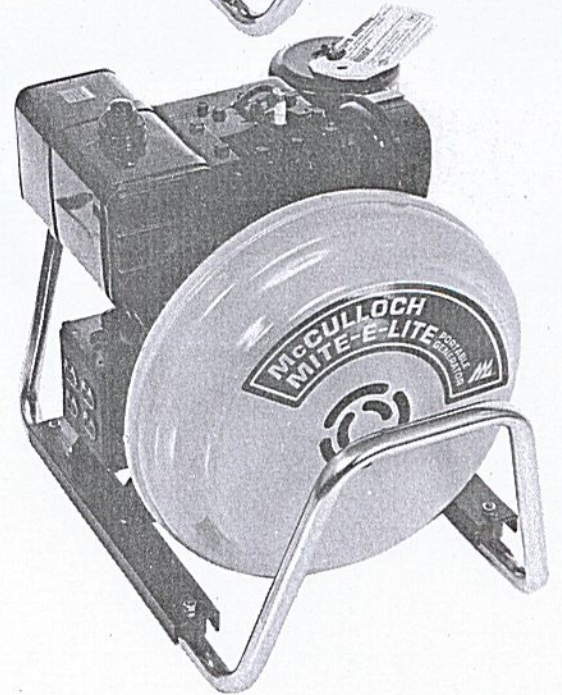

# PORTABLE GENERATORS

**McCULLOCH MODELS: RA-120, RA-150, RA-200, RA-330**

MODEL	MODEL NO.
RA-120	11400473 D
RA-150	11400470 D
RA-200	11400471 D
RA-330	11400472 D

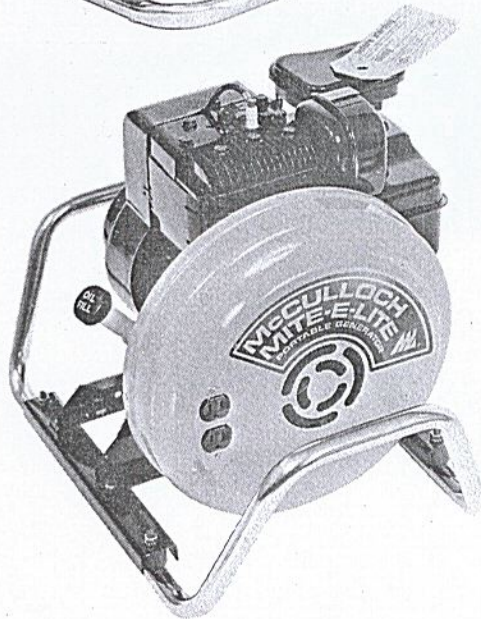
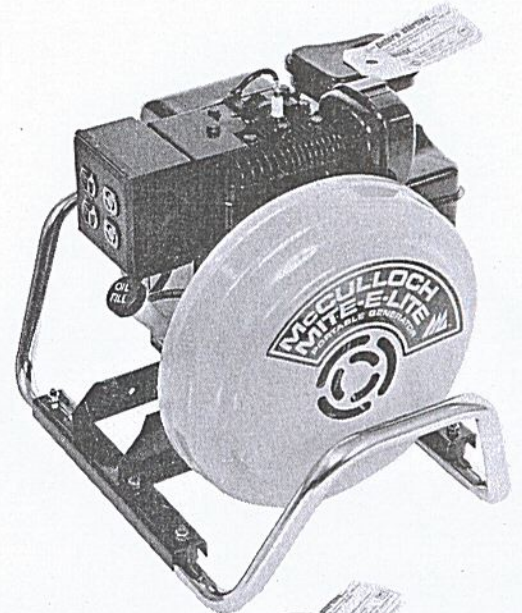
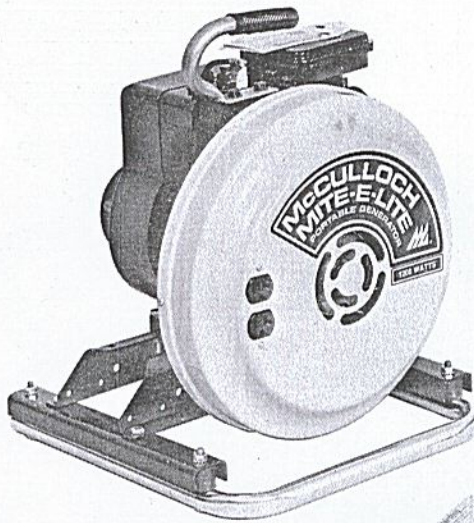

**McCULLOCH  
MITE-E-LITE  
INCORPORATED**  
WELLSVILLE, NEW YORK 14895

**McCULLOCH  
CORPORATION**  
5400 ALLA ROAD  
LOS ANGELES, CA 90009

APRIL 78

WHEN ORDERING PARTS, PLEASE SPECIFY GENERATOR MODEL AND TYPE NO.

Spark arrester screens and deflectors for exhaust mufflers are required in many areas. It is recommended that you check local regulations before going into restricted areas to determine if special equipment is required. Spark arrester equipment is available through Briggs & Stratton dealers under the following part numbers:

For Generator Model RA-120  
For Generator Models RA-150, 200 and 330

P/N 392191  
P/N 392195

Circled Numbers are not common to all Models. Check Parts List Descriptions.

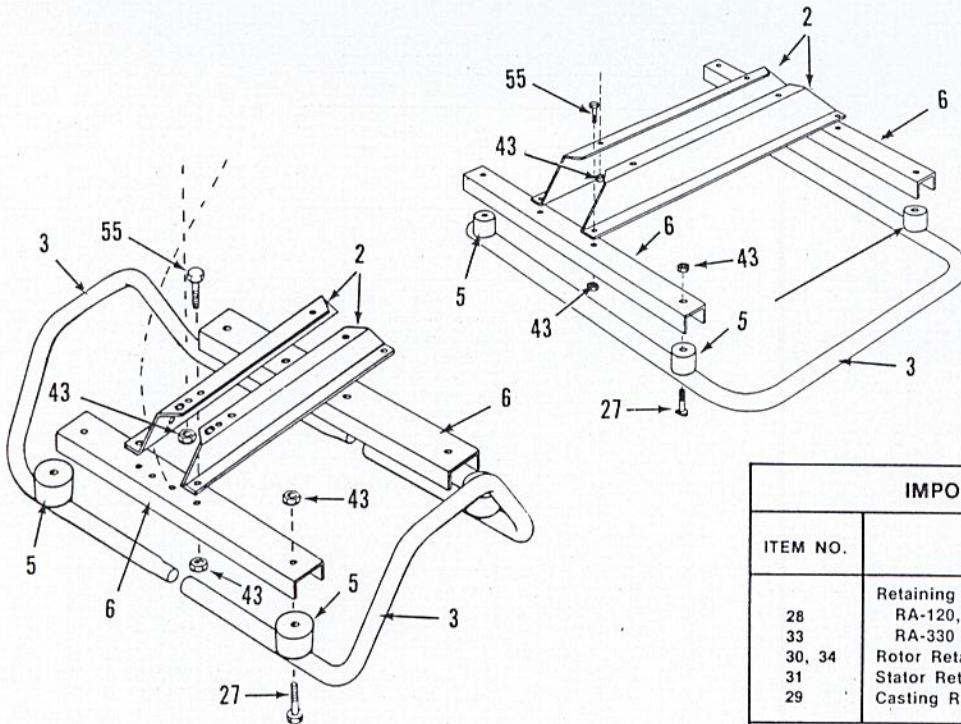
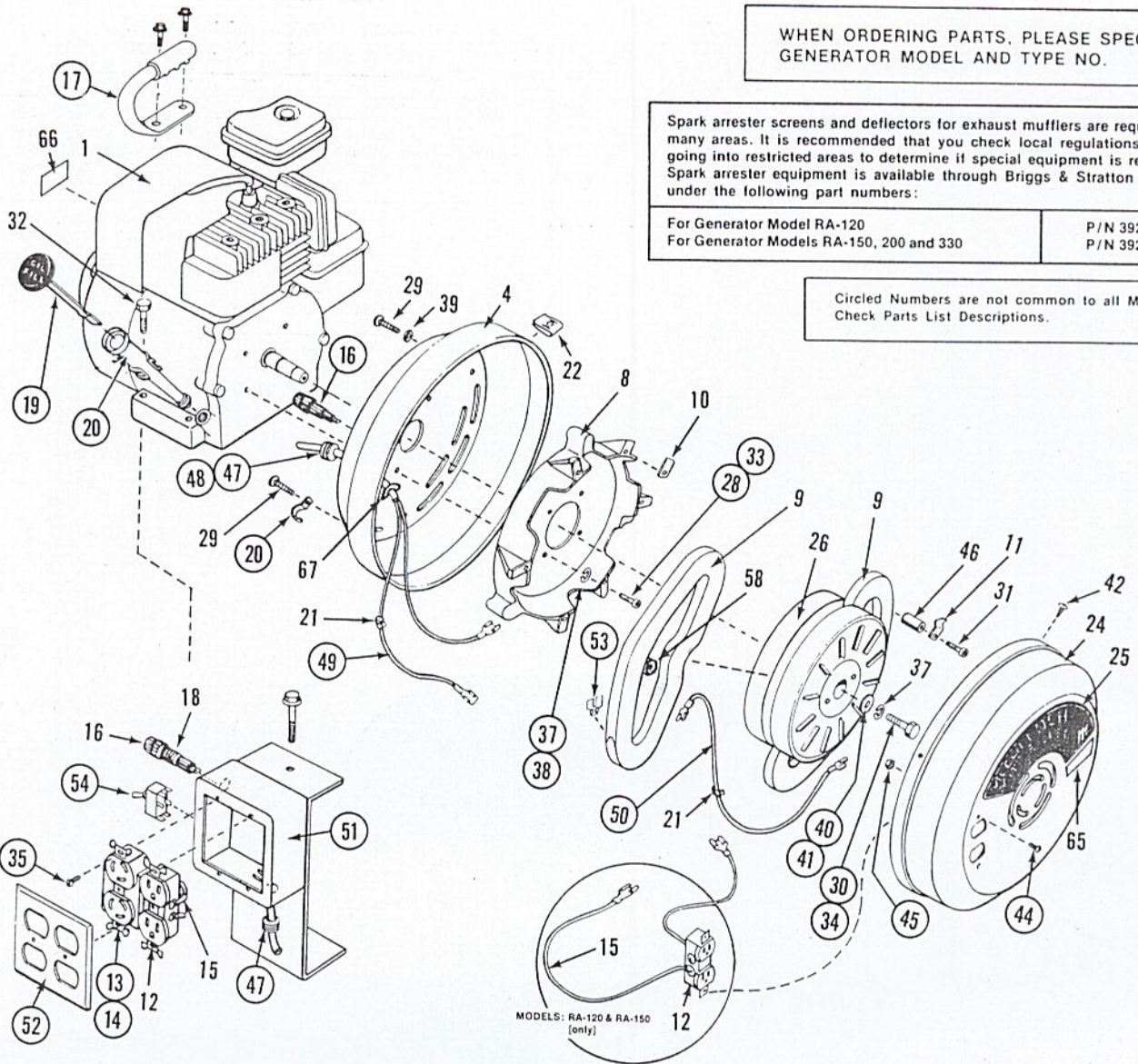

PROPANE CONVERSION KIT	
MODEL	P/N
RA-120	21708
RA-150	21708
RA-200	21708
RA-330	21502
SPECIAL TOOLS	
DESCRIPTION	P/N
Tool Kit Complete	21881
• Rotor Holding Wrench	21880
• Stator Clearance Gauge	21295
• Stator Shim Gauge	21877
• Rotor Gap Gauge	21896
• Rotor Puller Bolt [8" Rotor]	21882
• Rotor Puller Bolt [9½"]	21883

IMPORTANT TORQUE VALUES		
ITEM NO.	DESCRIPTION	TORQUE VALUE in./lbs.
28	Retaining Bolts Engine to Back Cover RA-120, RA-150 & RA-200	120 - 144
33	RA-330 & RA-330ES	216 - 240
30, 34	Rotor Retaining Bolt	240 - 264
31	Stator Retaining Screws	55 - 60
29	Casting Retaining Bolts	60 - 70

All remaining hardware to be securely tightened within reasonable limits

DESCRIPTION	RA-120		RA-150		RA-200		RA-330	
	P/N	QTY.	P/N	QTY.	P/N	QTY.	P/N	QTY.
1 Engines	21728	1	21729	1	21784	1	21785	1
2 Rails, Engine	21844	2	21844	2	21844	2	21844	2
3 Cradle/Tube Base	21592	1	21901	1	21901	1	21862	1
4 Back Cover	21602	1	21602	1	21602	1	21681	1
5 Isolators	21804	4	21804	4	21804	4	21804	4
6 Isolator Channels	21845	2	21845	2	21845	2	21846	2
8 Casting, Stator Mount	21847	1	21847	1	21847	1	21865	1
9 Stator Half	21871	2	21871	2	21848	2	21866	2
10 • Includes Shim 1/32 [pkg.3]	21884	1	21884	1	21884	1	21884	1
10 • Includes Shim 1/16 [pkg.3]	21885	1	21885	1	21885	1	21885	1
11 Holding Springs, Stator	21850	6	21850	6	21850	6	21850	6
12 Receptacle, 110V.	21150	1	21150	1	21150	1	21150	1
13 Receptacle, Twist 110V.	nr	nr	nr	nr	21625	1	nr	nr
14 Receptacle, 220V.	nr	nr	nr	nr	nr	nr	21392	1
15 Wiring Harness [wires only]	21872	1	21872	1	21620	1	21709	1
16 Fuse Holder	21270	1	21270	1	21270	1	21070	2
17 Handle Ass'y.	21671	1	nr	nr	nr	nr	nr	nr
18 Fuses	21841	1	21280	1	21281	1	21280	2
19 Dipstick	nr	nr	21989	1	21989	1	nr	nr
20 Dipstick Tube Ass'y.	nr	nr	21853	1	21853	1	nr	nr
21 Wire Keepers	21643	6	21643	6	21643	6	21643	5
22 Speed Nuts	21726	4	21726	4	21726	4	21726	4
24 Front Cover	21666	1	21666	1	21612	1	21690	1
25 Decal, Front Cover	21856	1	21856	1	21856	1	21868	1
26 Rotary Ass'y.	21597	1	21731	1	21731	1	21103	1
27 Bolts, Curve Hd.5/16-18x1-1/2	21876	4	21876	4	21876	4	21876	4
28 Capscrews, Hex Hd.5/16-24x7/8	21645	4	21645	4	21645	4	nr	nr
29 Capscrews, Hex Hd.1/4-20x3/4	21020	3	21020	3	21020	3	21020	4
30 Capscrew, Hex Hd.5/16-24x2-3/8	21857	1	21857	1	21857	1	nr	nr
31 Capscrews, Hex Hd.1/4-20x1-1/4	21950	6	21950	6	21950	6	21950	6
32 Capscrews, Hex Hd.5/16-18x1-3/4	21878	4	21878	4	21878	4	21878	4
33 Capscrews, Hex Hd.3/8-16x1	nr	nr	nr	nr	nr	nr	21003	1
34 Capscrew, Hex Hd.5/16-24x1-1/2	nr	nr	nr	nr	nr	nr	21143	1
35 Screws, Truss Hd. No. 8	nr	nr	nr	nr	21703	4	21703	4
37 Washer, Lock Split 5/16	21657	5	21657	5	21657	5	21657	1
38 Washers, Lock Split 3/8	nr	nr	nr	nr	nr	nr	21130	4
39 Washers, Lock Split 1/4	21658	3	21658	3	21658	3	21658	4
40 Washer, Flat 5/16x1/4	nr	nr	nr	nr	nr	nr	21704	1
41 Washer, Flat 5/16x3/16	21859	1	21859	1	21859	1	nr	nr
42 Screws, Pan No. 8 Sht.Mtl.	21650	4	21650	4	21650	4	21650	4
43 Nuts, Keps 5/16-18	21653	12	21653	12	21653	12	21653	14
44 Screw, Rd. Hd. Mach. No. 8-32x1/2	21899	2	21899	2	nr	nr	nr	nr
45 Nuts, Keps No. 8-32	21675	2	21675	2	nr	nr	nr	nr
46 Bushings, Stator	21860	4	21860	4	21860	4	21860	4
47 Grommets, Strain Relief	nr	nr	nr	nr	21851	1	21789	2
48 Grommet, Rubber	nr	nr	nr	nr	21642	1	nr	nr
49 Wire Cable	nr	nr	nr	nr	21867	1	21864	1
50 Jumpers, Wire	21861	2	21861	2	21861	2	nr	nr
51 Box & Bracket	nr	nr	nr	nr	21852	1	21943	1
52 Receptacle Cover	nr	nr	nr	nr	21632	1	21632	1
53 Fast On Tabs	21874	2	21874	2	21874	2	nr	nr
54 Switch DPDT	nr	nr	nr	nr	nr	nr	21971	1
55 Capscrews, Hex Hd.5/16-18x1	21647	4	21647	4	21647	4	21647	6
58 Cam Bushings	21897	2	21897	2	21897	2	21897	2
65 Wattage Label	21919	1	21920	1	21921	1	21922	1
66 Engine Label	21926	1	21926	1	21926	1	21926	1
67 Butterfly Clip	nr	nr	nr	nr	21767	1	nr	nr

**INTRODUCTION:** The McCulloch Portable Generator is one of the world's first successful entries in the field of permanent magnet alternators. McCulloch's unique Axial Air Gap design has enabled us to produce one of the lightest, most compact, trouble-free alternators in the industry. It is powered by a 4-cycle, air-cooled gasoline engine, producing 60-cycle, AC current, at 3600 RPM.

**WIRING SCHEMATICS:**

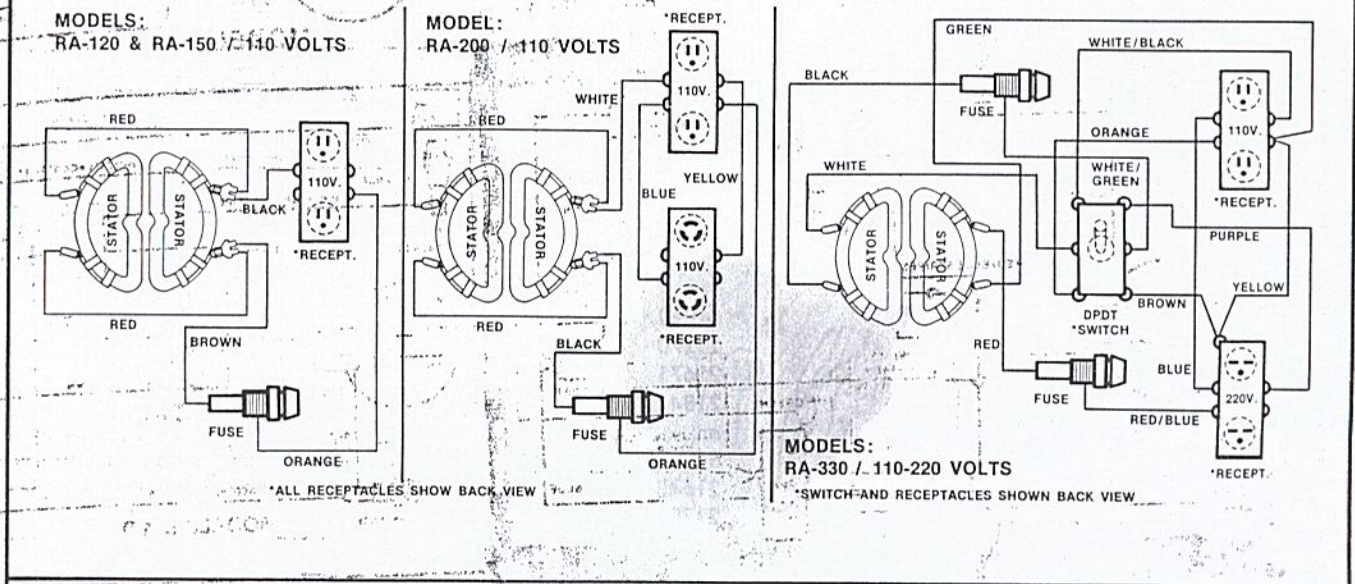

**PERFORMANCE SPECIFICATIONS**

MODEL	VOLTAGE	AMPERAGE	*RATED CAPACITY	HERTZ / CYCLES	*RATED CAPACITY is based on factory tests on typical units and is subject to and limited by the temperature, altitude, fuel, and of the conditions specified by the manufacturer of the applicable engine.
RA-120	110	10.9	1200*	60	
RA-150	110	13.6	1500*	60	
RA-200	110	18.2	2000*	60	
RA-330	110/220	30.0/15.0	3300*	60	

**OPERATING INSTRUCTIONS:**

1. Fill engine crankcase with oil — use a high-quality detergent oil, classified for service — SC, SD, SE, or MS. **Nothing** should be added to the recommended oil. (See Briggs & Stratton engine manual for proper oil weight for winter or summer.)
2. Start engine and allow a few minutes warm-up before applying desired load. Refer to Briggs & Stratton manual for detailed instructions. **(Never attempt to start engine with a load on generator.)**
3. Apply desired load, making sure that the load **does not** exceed the rated capacity of your model generator. See identification tag on the generator for rated output.
4. **Always** check engine crankcase oil with each tank of gas to insure long, dependable service.

<b>CAUTION:</b>	Be sure to change the oil as recommended by Briggs & Stratton: new engine after first five (5) hours — every 25 hours thereafter.
	Do not change switch while alternator is under load.
<b>NOTE:</b>	The McCulloch Mite-E-Lite, Inc. limited warranty does not cover the engine; all engine warranty and service must be taken to an authorized Briggs & Stratton dealer.

**MAINTENANCE:** Due to the fact that there are no slip rings or brushes, there is no specific maintenance required for the generator itself. During routine engine maintenance though, check to be sure all nuts, bolts, and other fasteners are secure, all wires are in good condition and not frayed or worn, and the entire unit is in good working order. Once again, engine maintenance is essential for dependable generator service.