

# McCULLOCH PORTABLE GENERATOR

MODEL H-3000  
TYPE 11-400466A,B,C,D,E

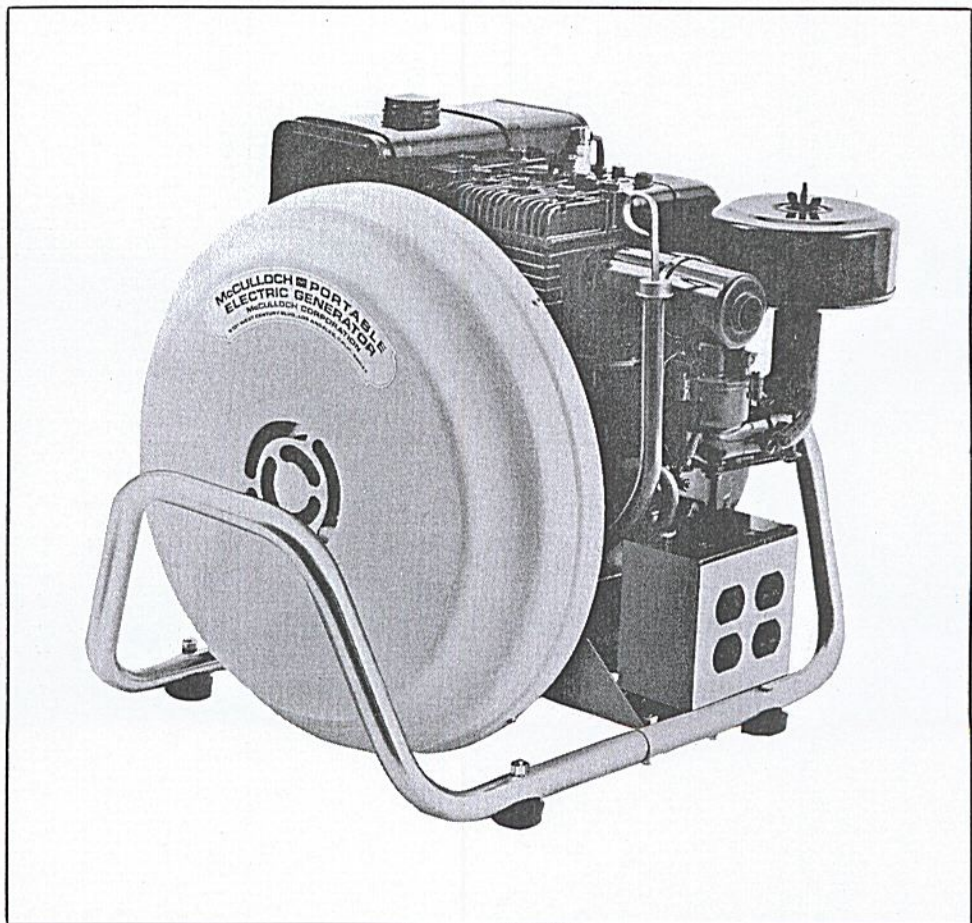

The McCulloch H-3000 Portable Generator is a light-weight, high power unit that is versatile and flexible. It is available as a 110 Vac, 220 Vac, or combination unit. Output voltage frequencies of either 50 Hz (International Standard) or 60 Hz (American Standard) are available, and can be adjusted by your authorized McCulloch Servicing Dealer, or McCulloch Master Service Center. Power output up to 2550 W continuous (3000 W intermittent) is available, depending on the application for which the generator is adjusted.



**McCULLOCH CORP.**  
6101 WEST CENTURY BOULEVARD  
LOS ANGELES, CALIFORNIA 90045



WHEN ORDERING PARTS, PLEASE SPECIFY  
GENERATOR MODEL AND TYPE NO.

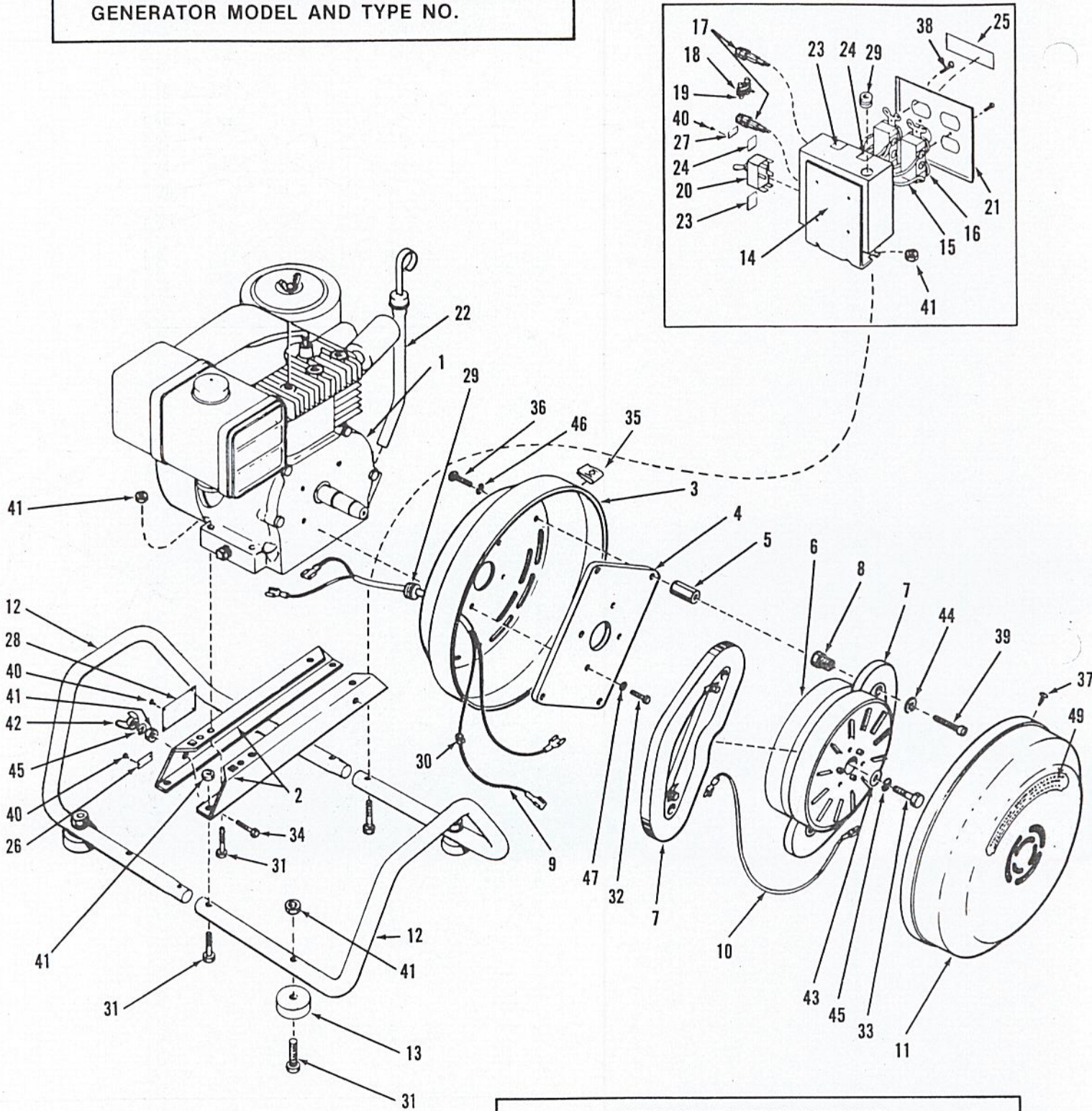

IMPORTANT TORQUE VALUES		
ITEM NO.	DESCRIPTION	TORQUE VALUE in. /lbs.
32	Retaining Bolts Engine to Back Cover	216-240
33	Rotor Retaining Bolt	240-264
36	Stator Post Retaining Bolt	120-140
39	Stator Retaining Screw	55-60

All remaining hardware to be securely tightened within reasonable limits



ITEM	DESCRIPTION	PART NO.	TYPE	TYPE	TYPE	TYPE	TYPE
			11400466A UPA	11400466B UPA	11400466C UPA	11400466D UPA	11400466E UPA
1	Engine Assy.	21043	1	1	1	1	1
2	Rail Assy.	21601	2	2	2	2	2
3	Cover, Back	21681	1	1	1	1	1
4	Plate, Stator Support	21682	1	1	1	1	1
5	Post, Stator Support	21683	4	4	4	4	4
6	Rotor Assy.	21103	1	1	1	1	1
7	Stator Assy. Half	21685	nr	2	2	2	nr
	Stator Assy. Half	21713	2	nr	nr	nr	2
8	Screw, Adjusting	21608	4	4	4	4	4
9	Wire Cable Assy.	21686	1	nr	nr	nr	nr
	Wire Cable Assy.	21687	nr	1	1	1	nr
	Wire Cable Assy.	21688	nr	nr	nr	nr	1
10	Wire, Jumper	21689	1	nr	nr	nr	1
11	Cover, Front	21690	1	1	1	1	1
12	Cradle Frame Assy.	21613	1	1	1	1	1
13	Mount, Rubber	21190	4	4	4	4	4
14	Rcpt. Box Brckt. Assy.	21712	1	1	nr	1	1
	Rcpt. Box Brckt. Assy.	21714	nr	nr	1	nr	nr
*15	Wire Harness Set	21617	1	nr	nr	nr	nr
	Wire Harness Set	21692	nr	nr	1	nr	nr
	Wire Harness Set	21693	nr	1	nr	1	nr
	Wire Harness Set	21621	nr	nr	nr	nr	1
16	Rcpt. 115V Dplx. Std.	21150	nr	nr	1	1	nr
	Rcpt. 230V Australian	21626	1	nr	nr	nr	nr
	Rcpt. 230V European	21627	nr	nr	nr	nr	1
	Rcpt. 230V Dplx. Std.	21392	nr	nr	1	1	1
	Rcpt. 125V 30A Twist	21715	nr	1	1	nr	nr
	Rcpt. 277V 15A Twist	21716	nr	1	nr	nr	nr
17	Holder, Fuse	21270	1	2	nr	2	1
	Holder, Fuse	21718	nr	nr	2	nr	nr
18	Holder, Spare Fuse	21290	1	1	nr	1	1
19	Fuse, ABC 15A	21280	nr	4	nr	4	nr
	Fuse, ABC 10A	21723	3	nr	nr	nr	3
	Fuse, BAF 15A	21724	nr	nr	2	nr	nr
20	Switch, DPDT	21402	nr	1	1	1	nr
21	Cover, Rcpt. Domestic	21632	nr	nr	nr	1	nr
	Cover, Rcpt. Aust.	21634	1	nr	nr	nr	nr
	Cover, Rcpt. European	21635	nr	nr	nr	nr	1
	Cover, Rcpt.	21719	nr	1	nr	nr	nr
	Cover, Rcpt.	21720	nr	nr	1	nr	nr
22	Tube, Oil Fill & Dip Stick	21695	1	1	1	1	1
23	Tag, "220 Volt"	21697	nr	1	nr	1	nr
	Tag, Switch Positioning	21721	nr	nr	1	nr	nr
24	Tag, "110 Volt"	21696	nr	1	nr	1	nr
25	Tag, Voltage I.D.	21722	nr	nr	1	nr	nr
26	Tag, Ground	21638	1	1	1	1	1
27	Tag, "Fuse 15 Amp"	21698	nr	nr	2	nr	nr
28	Tag, Serial Number	21640	1	1	nr	1	1
	Tag, Serial Number	21699	nr	nr	1	nr	nr
29	Grommet	21642	2	nr	nr	nr	2
	Grommet	21700	nr	2	2	2	nr
30	Keeper, Wire	21643	5	5	5	5	5
31	Capscrew, 5/16-18 x 1-1/2	21050	12	12	12	12	12
32	Capscrew, 3/8-16 x 1	21003	4	4	4	4	4
33	Capscrew, 5/16-24 x 1-1/2	21143	1	1	1	1	1
34	Capscrew, 5/16-18 x 1	21647	1	1	1	1	1
35	Speed Nut	21726	4	4	4	4	4
36	Capscrew, 1/4-20 x 1	21649	4	4	4	4	4
37	Screw, Pan Head Phillips #8	21650	4	4	4	4	4
38	Screw, Truss Head Slotted #8	21703	4	4	4	4	4
39	Screw, Socket Head 1/4-20 x 1-1/4	21651	4	4	4	4	4
40	Screw, Drive #2 x 1/4 Type U	21652	nr	nr	6	nr	nr
41	Nut, Keps 5/16-18	21080	13	13	13	13	13
42	Nut, Wing 5/16-18	21654	1	1	1	1	1
43	Washer, Flat 5/16 x 1/4 thick	21704	1	1	1	1	1
44	Washer, Flat 1/4 x 1/8 thick	21656	4	4	4	4	4
45	Lock Washer, Star 5/16	21725	2	2	2	2	2
46	Washer, Lock 1/4	21030	4	4	4	4	4
47	Washer, Lock 3/8	21130	4	4	4	4	4
48	Parts List Illustrated	21740	1	1	1	1	1
49	Decal, McCulloch	21727	1	1	1	1	1

\* Wire Harness Set includes all hook-up wires to the receptacle and switch; does not include receptacles or switch.



## INTRODUCTION:

The McCulloch Portable Generator is one of the world's first successful entries in the field of permanent magnet alternators, McCulloch's unique axial air gap design has enabled us to produce one of the lightest, most compact, trouble free alternators in the industry. It is powered by a 4-cycle air cooled gasoline engine, producing 60 cycle A.C. current, at 3600 r.p.m. or 50 cycle A.C. current at 3000 r.p.m.

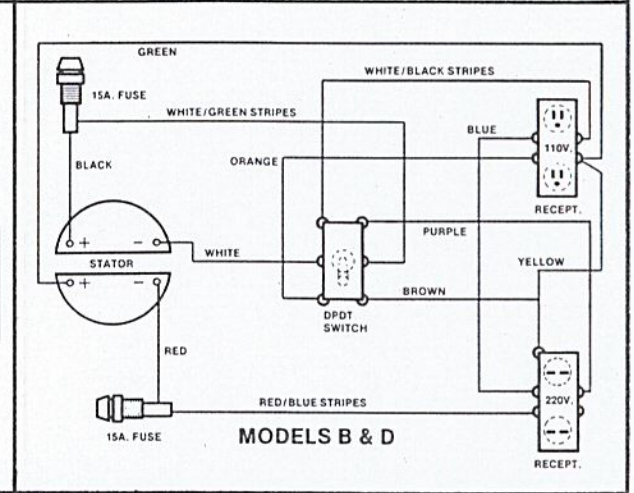
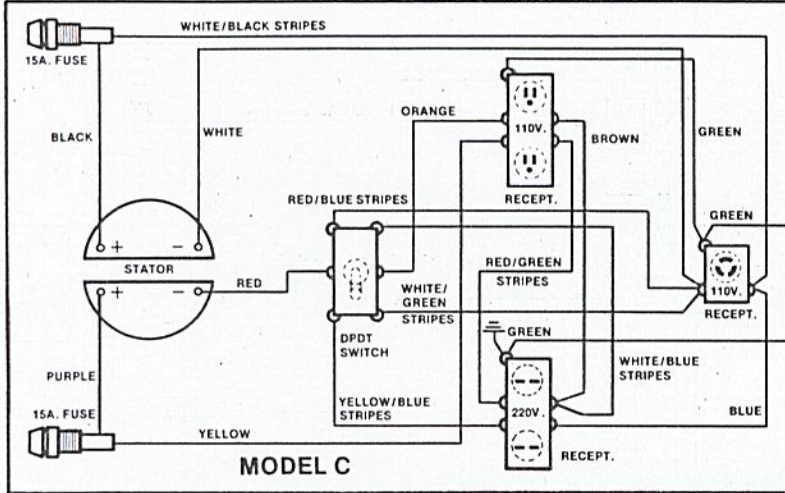
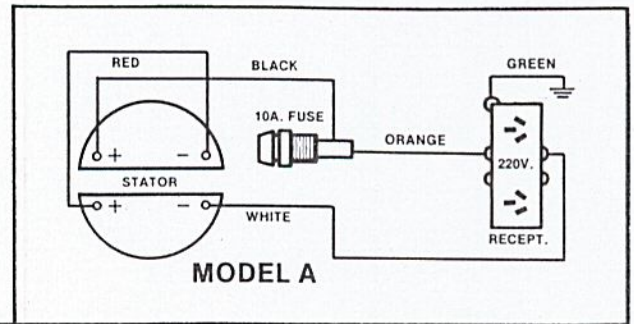

PERFORMANCE SPECIFICATIONS					
MODEL	CYCLES [Hz]	VOLTAGE	MAXIMUM AMPERAGE	WATTAGE OUTPUT	
				CONTINUOUS	INTERMITTENT
A, E	50	220	12.2	2300	2700
B, C, D	50	110/220	24.5/12.3	2300	2700
B, C, D	60	110/220	27.2/13.6	2550	3000

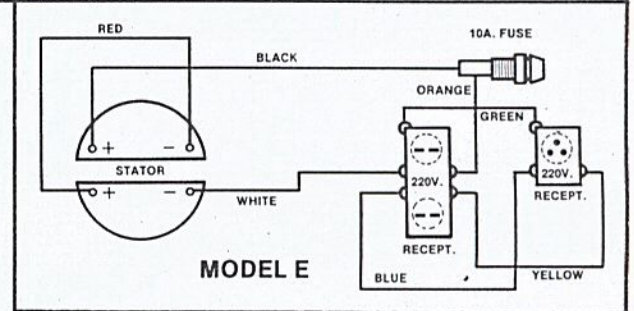

## OPERATING INSTRUCTIONS:

1. Before starting engine read the enclosed Briggs & Stratton instruction booklet for proper oil and maintenance.
2. After the proper oil and gasoline has been installed, start engine and allow a few minutes warm up time before applying desired load. (**Never start unit under load.**)
3. Apply desired load, making sure that load **does not** exceed the rated capacity of your model alternator.
4. **Always** check oil with each tank of gasoline, to insure long dependable service.
5. When using 110 voltage the switch must be in the 110 position as marked. With this switch position, the 220 volt receptacle is dead. The maximum wattage available at 110 volts is 3000 watts. With the switch in the 220 volt position as marked both the 110 and the 220 receptacles are alive. In this position the 110 volt load must not exceed 1500 watts, and the total 110 and 220 volt must not exceed 3000 watts.

<b>CAUTION:</b>	Be sure to change and check oil as recommended by Briggs & Stratton. Dirty oil will wear engine bearings, resulting in damage to the engine as well as the alternator.
	Do not change switch while alternator is under load.

## ACCESSORIES:

Accessories for the H-3000 Generator include a 12-Vdc starter/generator, liquid petroleum gas (LPG) conversion kit, and "Lo-Tone" muffler, all of which are available through your McCulloch Dealer.

## MAINTENANCE:

Because there are no slip rings or brushes, there is no specific maintenance required for the generator itself. During routine engine maintenance, check to be sure all nuts, bolts, and other fasteners are secure, all wires are in good condition and not frayed or worn, and the entire unit is clean and free from oil, dust, and debris.