

Sept. 1 1970

McCULLOCH MITE-E-LITE MAC 2000 GENERATOR ILLUSTRATED PARTS LIST

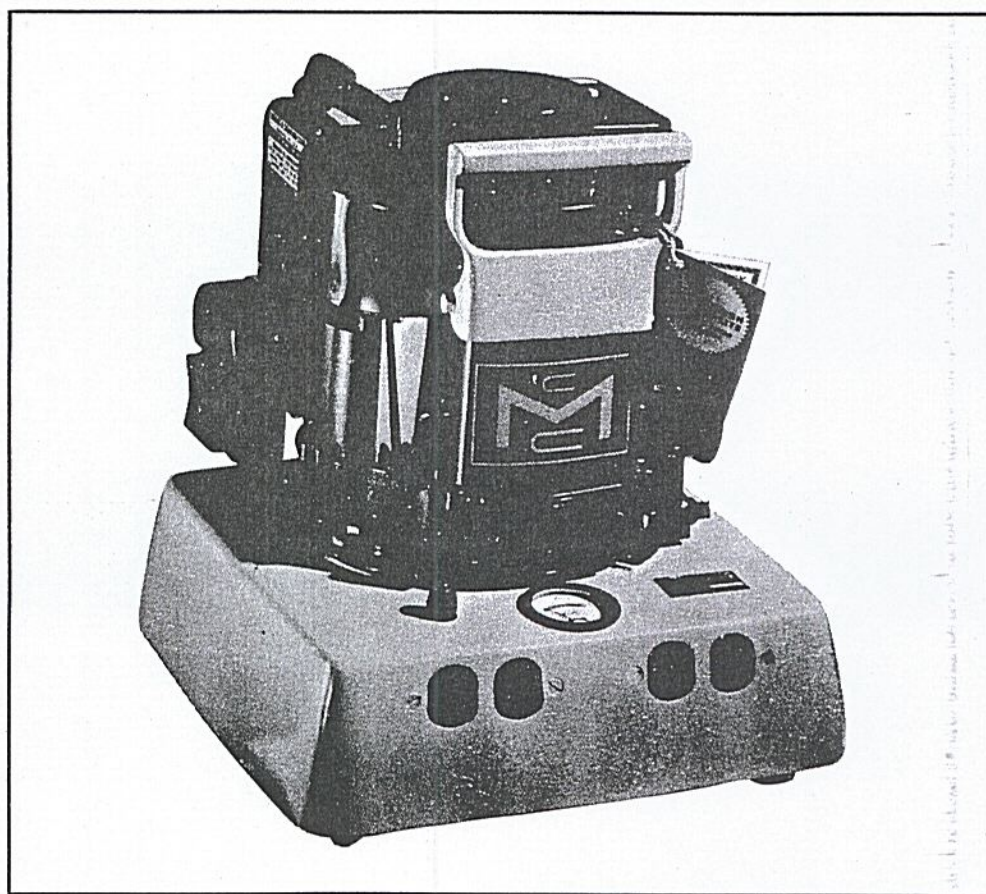

McCULLOCH CORPORATION

6101 West Century Boulevard

Los Angeles, California 90045

BULLETIN 0201

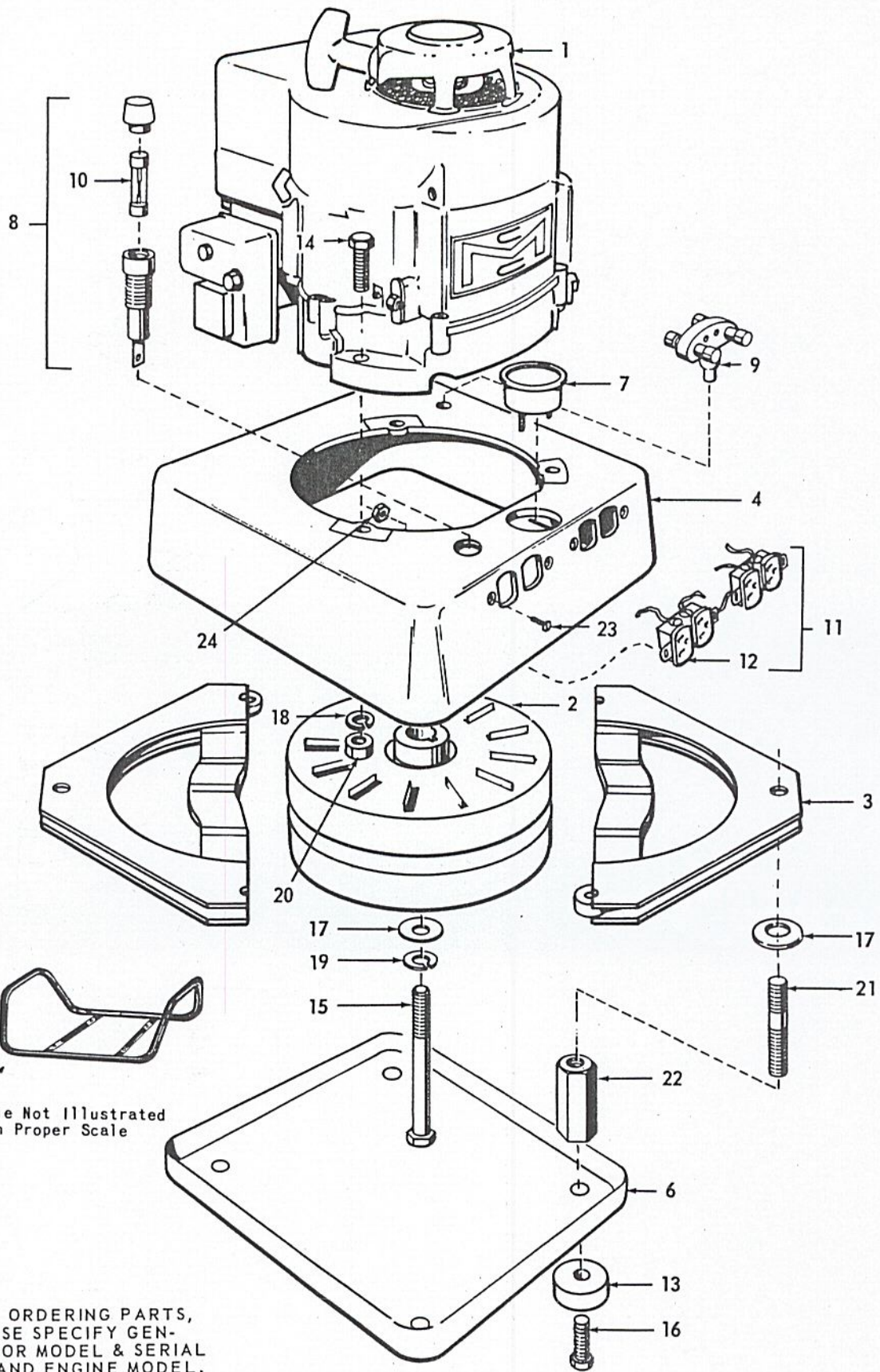

5
 Cradle Not Illustrated
 In Proper Scale

WHEN ORDERING PARTS,
 PLEASE SPECIFY GEN-
 ERATOR MODEL & SERIAL
 NO., AND ENGINE MODEL.

Index No.	Part Number	Description	Units Per Assy
1	21041	Engine (100902)	1
2	21107	Rotor Assembly	1
3	21116	Stator Assembly	1
4	21091	Base Casting	1
5	21015	Carrying Cradle	1
6	21181	Base Cover	1
7	21301	Voltmeter	1
8	21270	Fuse Holder	1
9	21290	Holder — Spare Fuse	1
10	21281	Fuses (20 Amp)	3
11	21336	Wiring Harness	1
12	21150	Receptacles (115V)	2
13	21190	Rubber Mounts	4
14	21050	Capscrew — 5/16-18 x 1-1/2	3
15	21140	Capscrew — 3/8-24 x 3-1/4	1
16	21057	Capscrew — 5/16-18 x 1	6
17	21210	Flat Washer — 3/8	5
18	21070	Lockwasher — 5/16 Medium	3
19	21130	Lockwasher — 3/8 Medium	1
20	21080	Nut — 5/16-18	3
21	21340	Stud — 5/16-18	4
22	21350	Spacer — 5/8	4
23	21160	Screw — Pan Head	4
24	21170	Nut — 10-24	4

INTRODUCTION

The Mite-E-Lite portable generator is one of the world's first successful entries in the field of permanent magnet alternators. Mite-E-Lite's unique axial air gap design has enabled us to produce one of the lightest, most compact, trouble free alternators in the industry. It is powered by a 4 cycle air cooled gasoline engine, producing 60 cycle A.C. current, at 3600 r.p.m.

OPERATING INSTRUCTIONS

1. Before starting engine read the enclosed Briggs and Stratton instruction booklet for proper oil and maintenance.
2. After the proper oil and gasoline has been installed, start engine and allow a few minutes warm up time before applying desired load. (Never start unit under load.)
3. Place engine throttle in fast position to obtain full A.C. 60 cycle current. A slower speed may be used in operating light bulbs, but should never be used in operating equipment.
4. Apply desired load, making sure that load does not exceed the rated capacity of your model alternator.
5. Always check oil with each tank of gasoline, to insure long dependable service.

SPECIFICATIONS

Model	Watts	Voltage	Amps	Amps (Dead Short)	Cycle	Weight	Size
Mac 2000	2000	115	15.3	54	60	71 lbs.	15"x14"x17-1/2"

CAUTION

1. Never operate alternator in loose sand or fine gravel, as foreign matter may be drawn into alternator causing extreme and expensive damage.
2. Be sure to change and check oil as recommended by Briggs & Stratton. Dirty oil will wear engine bearings, resulting in damage to the engine as well as the alternator.

MAINTENANCE

Our alternator has no brushes or slip rings, therefore, there is virtually no maintenance on the alternator portion of this machine. However, the engine bearings support the alternator making proper engine maintenance important to deliver many hours of trouble free service.

WIRING DIAGRAM

