

Sept. 1 1970

# **McCULLOCH MITE-E-LITE MAC 1500 GENERATOR ILLUSTRATED PARTS LIST**

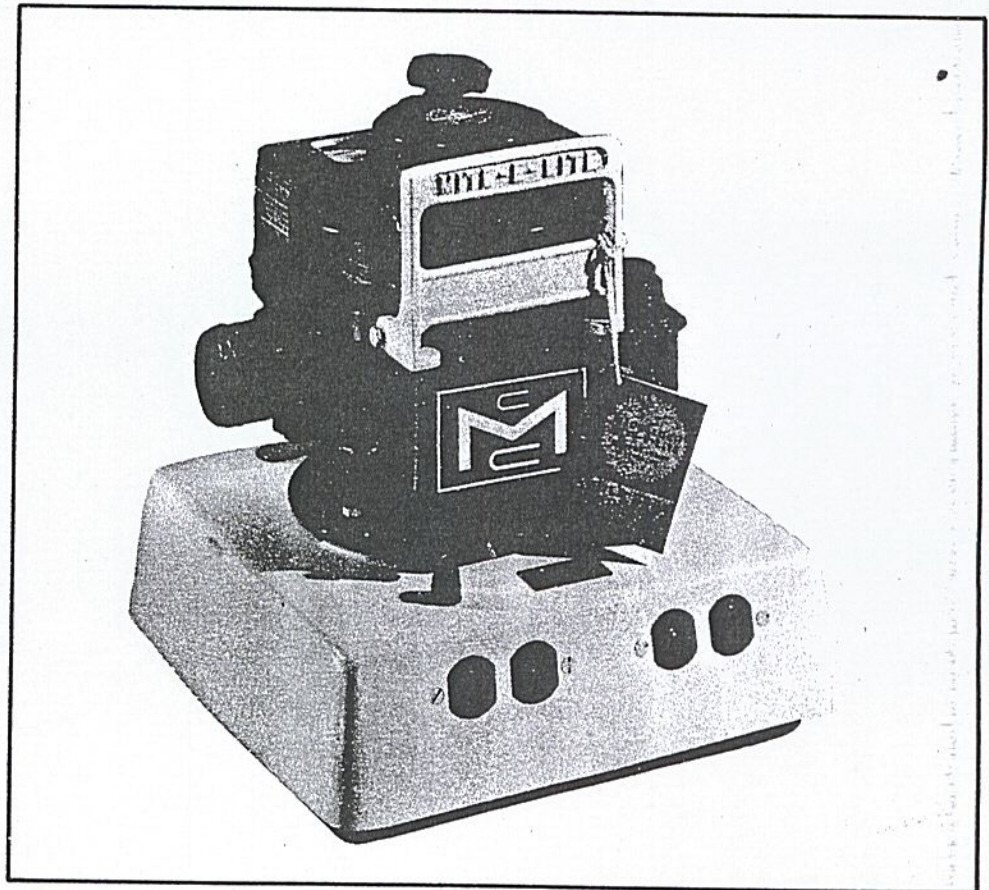

**McCULLOCH CORPORATION**

6101 West Century Boulevard

Los Angeles, California 90045

BULLETIN 0102

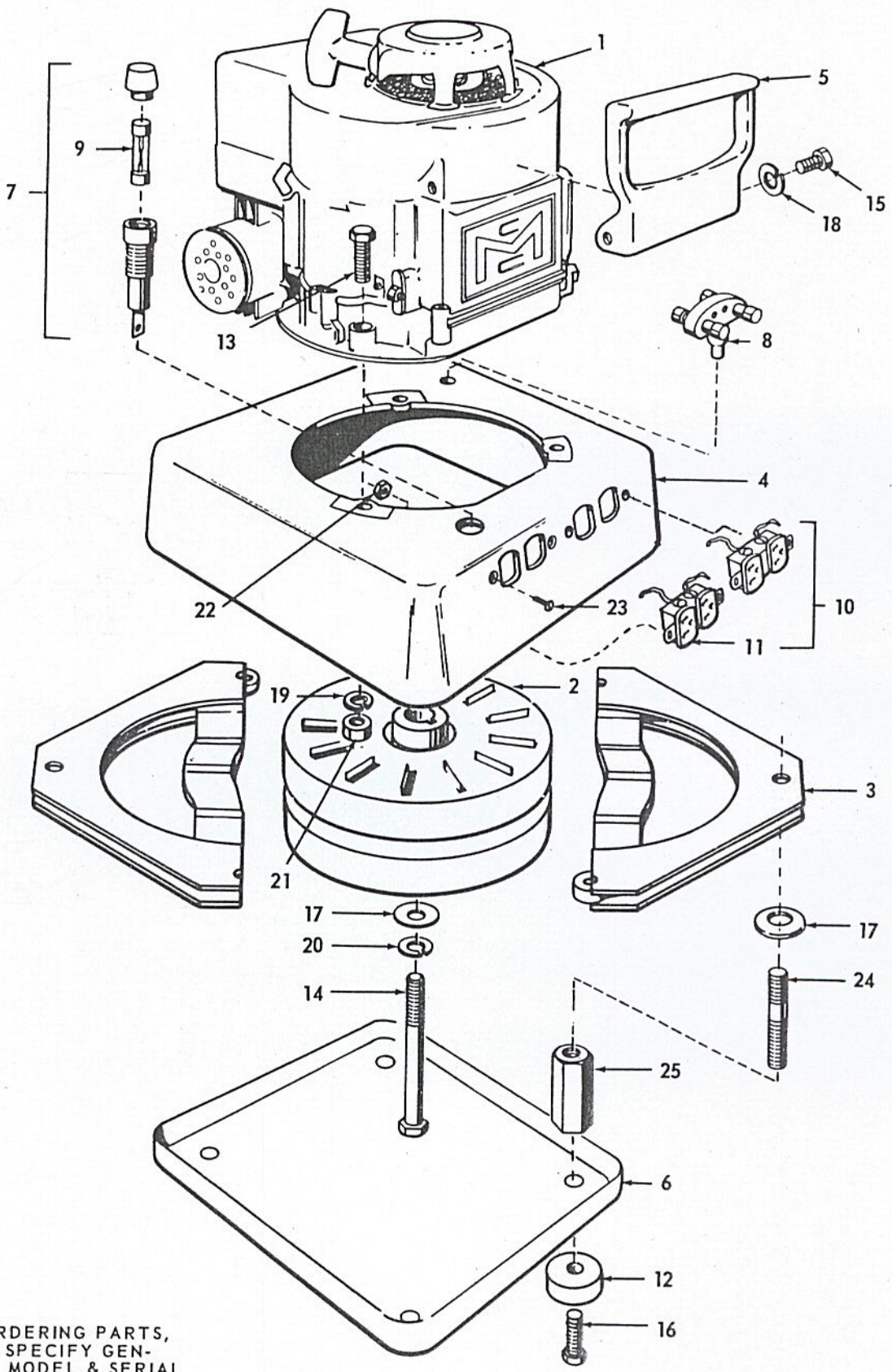

WHEN ORDERING PARTS,  
PLEASE SPECIFY GEN-  
ERATOR MODEL & SERIAL  
NO., AND ENGINE MODEL.

Index No.	Part Number	Description	Units Per Assy
1	21040	Engine (90902) .....	1
2	21106	Rotor Assembly .....	1
3	21116	Stator Assembly .....	1
4	21098	Base Casting .....	1
5	21011	Carrying Handle .....	1
6	21181	Base Cover .....	1
7	21270	Fuse Holder .....	1
8	21290	Holder – Spare Fuse .....	1
9	21280	Fuses (12 Amp) .....	3
10	21334	Wiring Harness .....	1
11	21150	Receptacle .....	2
12	21190	Rubber Mounts .....	4
13	21050	Capscrew – 5/16-18 x 1-1/2 .....	7
14	21140	Capscrew – 3/8-24 x 3-1/4 .....	1
15	21020	Capscrew – 1/4-20 x 3/4 .....	2
16	21057	Capscrew – 5/16-18 x 1 .....	4
17	21210	Flat Washers – 3/8 .....	5
18	21030	Lockwashers – 1/4 Medium .....	2
19	21070	Lockwashers – 5/16 Medium .....	3
20	21130	Lockwashers – 3/8 Medium .....	1
21	21080	Nuts – 5/16-18 .....	3
22	21170	Nuts – 10-24 .....	4
23	21160	Screw – Pan Head – 10-24 .....	4
24	21340	Stud – 5/16-18 .....	4
25	21350	Spacer – 5/8 .....	4

## INTRODUCTION

The Mite-E-Lite portable generator is one of the world's first successful entries in the field of permanent magnet alternators. Mite-E-Lite's unique axial air gap design has enabled us to produce one of the lightest, most compact, trouble free alternators in the industry. It is powered by a 4 cycle air cooled gasoline engine, producing 60 cycle A.C. current, at 3600 r.p.m.

## OPERATING INSTRUCTIONS

1. Before starting engine read the enclosed Briggs and Stratton instruction booklet for proper oil and maintenance.
2. After the proper oil and gasoline has been installed, start engine and allow a few minutes warm up time before applying desired load. (Never start unit under load.)
3. Place engine throttle in fast position to obtain full A.C. 60 cycle current. A slower speed may be used in operating light bulbs, but should never be used in operating equipment.
4. Apply desired load, making sure that load does not exceed the rated capacity of your model alternator.
5. Always check oil with each tank of gasoline, to insure long dependable service.

## SPECIFICATIONS

Model	Watts	Voltage	Amps	Amps (Dead Short)	Cycle	Weight	Size
Mac 1500	1500	115	13.5	54	60	61 lbs.	12"x12"x15-1/2"

## CAUTION

1. Never operate alternator in loose sand or fine gravel, as foreign matter may be drawn into alternator causing extreme and expensive damage.
2. Be sure to change and check oil as recommended by Briggs & Stratton. Dirty oil will wear engine bearings, resulting in damage to the engine as well as the alternator.

## MAINTENANCE

Our alternator has no brushes or slip rings, therefore, there is virtually no maintenance on the alternator portion of this machine. However, the engine bearings support the alternator making proper engine maintenance important to deliver many hours of trouble free service.

