

Remington

COMPONENT PARTS

Models Bantam G Assembly No. 61500 & Bantam GP Assembly No. 61502

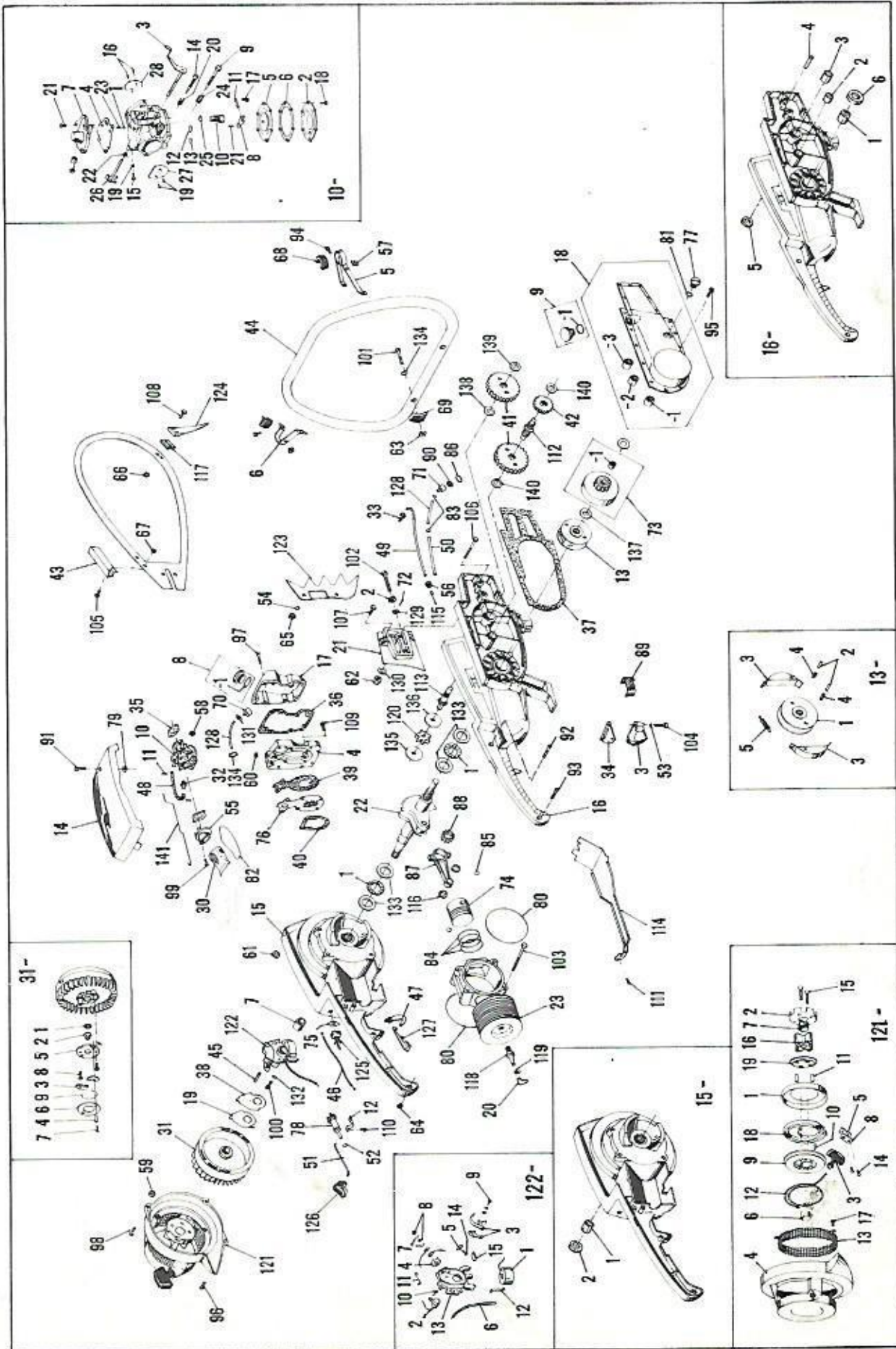

Models Bantam G Assembly No. 61500 & Bantam GP Assembly No. 61504

IMPORTANT

ALWAYS ORDER COMPONENTS BY PART NUMBER AND PART NAME.
INCLUDE MODEL AND SERIAL NUMBER.

REF. NO.	PART NUMBER	DESCRIPTION	QTY.	REF. NO.	PART NUMBER	DESCRIPTION	QTY.
1	49628	Bearing, Thrust	2	-3	27274A	Bearing, Needle	1
2	60967	Block, Chain Adjusting	1	-4	61549	Pins, Spirol	2
3	60117	Body, Muffler	1	-5	61525	Seal	1
4	60123	Body Assy., Fuel Tank	1	-6	48529	Seal	1
5	61533	Brace, Handle R.H.	1	17	61842	Cover, Fuel Tank	1
6	61534	Brace, Handle L.H.	1	18	61550	Cover, Gear Box	1
7	60144	Cam	1	-1	61520	Bearing	1
8	61882	Cap, Fuel	1	-2	20484	Bearing	1
-1	60303	Ring, "O"	1	-3	22929	Bearing	1
9	49313	Cap Assy., Oil	1	19	60148	Cover, Ignition	1
-1	20385	Ring, "O"	1	20	60030	Cover, Spark Plug Terminal	1
10	60092	Carburetor	1	21	61508	Cover, Sprocket	1
-1	60133	Ball, Choke Shaft	1	22	61516	Crankshaft	1
-2	60134	Cover, Diaphragm	1	23	60887	Cylinder	1
-3	60178	Choke Lever & Shaft Assy.	1	24	60170	Decal, Carb. Cover (not shown)	1
-4	60136	Diaphragm, Pump	1	25	60170A	Decal, Carb. Cover (not shown)	1
-5	60137	Diaphragm Assy., Fuel Control	1	26	60140	Decal, Gas Tank (not shown)	1
-6	60181	Gasket, Diaphragm Cover	1	27	61536	Decal, Identification (not shown)	1
-7	60878	Housing Assy., Pump	1	28	60139	Decal, Right Side (not shown)	1
-8	60182	Lever, Fuel Control	1	29	60138	Decal, Left Side (not shown)	1
-9	61880	Needle Assy., High Speed Adj.	1	30	60071	Element, Air Filter	1
-10	61917	Needle & Seat Assy.	1	31	61638	Fan Assy.	1
-11	60183	Pin, Diaphragm Lever	1	-1	103272	Lockwasher	1
-12	60188	Plug, Welsh	1	-2	48112A	Nut	1
-13	60189	Plug, Welsh	1	-3	48972	Pawl, Starter	2
-14	60186	Screw, Idle Adj.	1	-4	61636	Pin, Roll	2
-15	60196	Screw, Throttle Adj.	1	-5	60297	Plate, Retainer	1
-16	60197	Screw, Choke & Throttle Valve Attach.	4	-6	48694	Plate, Starter	1
-17	60198	Screw, Lever Pin	1	-7	61637	Rivet	2
-18	60199	Screw, Diaphragm Cover & Pump Hsg. Att.	10	-8	100667A	Screw	2
-19	60190	Spring, Throttle Adj. Screw	1	-9	48105	Spring	1
-20	60191	Spring, Idle Adj. Screw	1	32	60075	Fitting, Line Fuel	1
-21	60192	Spring, Fuel Control Lever	1	33	61649	Fitting, Oil	1
-22	60193	Spring, Throttle Return	1	34	60118	Flange, Muffler	1
-23	60194	Spring, Choke Shaft	1	35	60046	Gasket, Carburetor	1
-24	61881	Spring, High Speed	1	36	60048	Gasket, Fuel Tank	1
-25	60185	Strainer	1	37	61511	Gasket, Gear Box	1
-26	60176	Throttle Shaft & Lever Assy.	1	38	60149	Gasket, Ignition	1
-27	60177	Valve, Choke	1	39	60047	Gasket, Reed Plate	1
-28	60175	Valve, Throttle	1	40	40893	Gasket, Reed Plate	1
-29	60391	Kit, Recarburetion (not shown)	1	41	61593	Gear	2
11	49132	Clamp, Fuel Line	2	42	61596	Gear	1
12	61680	Clamp, Oil Pump	1	43	49526	Guard for Bantam GP	1
13	60980	Clutch Assy.	1	44	61532	Handle	1
-1	60978	Drive Plate	1	45	60078	Key, Straight, Fan	1
-2	60088	Plunger	1	46	41612F	Lead, Wire	1
-3	60979	Shoe Assy.	2	47	61656	Lever, Throttle Assy.	1
-4	60090	Spring	2		61198	Lever, Throttle Assy. Starting with Serial #EL #13550	1
-5	60860	Spring	2	48	48970F	Line, Fuel	1
14	60120	Cover Assy., Carburetor	1	49	61535A	Line, Oiler	1
15	61570	Cover, Crankcase, Fan Side	1	50	61535B	Line, Oiler, Suction	1
	61217	Cover, Crankcase, Fan Side Starting with Serial #EL #13550	1	51	61542	Linkage, Oil Pump	1
-1	60060	Bearing	1	53	22794	Lockwasher, Muffler	2
-2	48529	Seal	1	54	103222	Lockwasher, Sticker for Bantam G	2
16	61666	Cover, Crankcase, Sprocket Side for Bantam G	1	55	60009	Manifold, Air Filter	1
	61683	Cover, Crankcase, Sprocket Side for Bantam GP	1	56	61660	Nut, Hex Tubing	3
-1	60060	Bearing, Needle	1	57	103046	Nut, Sq. Brace, #10-24	2
-2	49466	Bearing, Needle	1	58	103120B	Nut, Hex, Muff., Shield (1), Cor.b. (2), .250-28	3
				59	118332	Nut, Shroud, .250-20	1

Remington

COMPONENT PARTS

Models Bantam G Assembly No. 61500 & Bantam GP Assembly No. 61502

IMPORTANT ALWAYS ORDER COMPONENTS BY PART NUMBER AND PART NAME.
INCLUDE MODEL AND SERIAL NUMBER.

REF. NO.	PART NUMBER	DESCRIPTION	QTY.	REF. NO.	PART NUMBER	DESCRIPTION	QTY.
60	103046	Nut, Carb. Cover, Sq. #10-24	1	112	61517	Shaft, Gear	1
61	49873	Nut, Hex, Spinlock, Crankcase Cover	4	113	61529	Shaft, Sprocket	1
62	118315	Nut, Hex, Guide Bar, .375-24	2	114	60385C	Shield	1
63	103048	Nut, Sq. Handle, .250-20	2	115	61661	Sleeve, Compression	3
64	103006	Nut, Hex, Handle, #10-2	2	116	49016	Spacer, Piston	2
65	106365	Nut, Hex, Sticker, .312-18 for Bantam G	2	117	60331	Spacer, Sticker for Bantam GP	1
66	118344	Nut, Hex, Sticker, .312-24	2	118	25671	Spark Plug	1
67	118343	Nut, Hex, Guard, .250-28 for Bantam GP	2	119	60029	Spring, Connector, Ignition	1
68	60828	Pad, Brace, Handle	2	120	A7-437	Sprocket	1
69	60085	Pad, Handle Retaining, Lower	2	121	61552	Starter Assy.	1
70	49125	Pick-Up, Fuel	1	-1	48103	Cover	1
71	61642	Pick-Up, Oil	1	-2	48971	Drum	1
72	48049	Pin, Spring, Chain Adj. Screw	1	-3	41592	Handle	1
73	61555	Pinion & Drum Assy.	1	-4	61653	Housing Assy.	1
-1	61520	Bearing	1	-5	41811	Insert	1
74	35263B	Piston Assy.	1	-6	60324	Nyliner	1
75	60126	Plate, On-Off	1	-7	61606	Nyliner	1
76	60025	Plate, Reed Assy.	1	-8	41812	Plate	1
77	5212	Plug, Filler	1	-9	61659	Pulley Assy.	1
78	61541	Pump, Oil	1	-10	41630	Pin, Spring (Included in Pulley Assy.)	1
79	60053	Ring, Grip, Carburetor Cover	1	-11	61652	Pin, Spring (Included in Pulley Assy.)	2
80	21916	Ring, "O", Cylinder	2	-12	41616C	Rope	1
81	45998	Ring, "O", Plug Filler	1	-13	61617	Screen Assy.	1
82	61142	Ring, Filter Air, Spring Assy.	1		61566	Clip, Long (not shown)	1
83	38601	Ring, "O", Oil Pump & Pick-Up Tube	2		61618	Clip, Short (not shown)	2
84	35259	Ring, Piston	3	-14	100625	Screw	2
85	24856	Ring, Retaining, Piston Pin	2	-15	100674	Screw	2
86	61644	Ring, Retaining	1	-16	61540	Spacer	1
87	42824A	Rod Assy., Connecting	1	-17	41057C	Screw	3
-1	21909	Bearing, Needle	1	-18	41349	Spring	1
-2	42492	Screw	2	-19	61554	Washer	1
88	60582A	Roller (Set of 28)	1		49950	Washer (not shown)	1
89	60129	Screen, Muffler	1	122	60052	Stator Plate Assy.	1
90	61643	Screen, Oil	1	-1	60150	Coil Group	1
91	60020	Screw, Bind Hd., Carb. Cover, 10-24x.62	1	-2	60145	Condenser	1
92	60080	Screw, Bind Hd., Handle, 10-24x1.12	1	-3	60147	Contact Set	1
93	60080A	Screw, Bind Hd., Handle, 10-24x1.50	1	-4	60154	Insulator, Conn. Stud, Outside	1
94	101126B	Screw, Fil Hd., Brace, 10-24x1.50	2	-5	60155	Insulator, Conn. Stud, Inside	1
95	101127B	Screw, Fil Hd., Cover, 10-24x .62	18	-6	60147	Lead, High Tension	1
96	101169B	Screw, Fil Hd., Shroud, .250-20x.87	2	-7	103202	Lockwasher	2
97	101129D	Screw, Fil Hd., Fuel Tank, 10-24x.88	8	-8	60202	Nut	2
98	101174B	Screw, Fil Hd., Shroud, Upper, .250-20x1.75	1	-9	60156	Screw	1
99	101374B	Screw, Fil Hd., Manifold, 10-32x.38	2	-10	60158	Screw	1
100	101167B	Screw, Fil Hd., Ignition (Reed Plate), .250-20x.62	2	-11	60153	Spring, Breaker Box Cover	1
101	101673B	Screw, Fil Hd., Handle, .250-20x1.50	2	-12	60151	Spring, Wedge	1
102	60966	Screw, Fil Hd., Chain Adj., .312-18x2.50	1	-13	60143	Stator Plate	1
103	100930	Screw, Crankcase Cover, .312-24x3.62	4	-14	60157	Stud, Connector	1
104	60245	Screw, Hex Hd., Muffler, .250-20x2.00	2	-15	60152	Wiper, Felt	1
105	102201	Screw, Hex Hd., Guard, .250-28x.62, for Bantam GP	2	123	61531	Sticker, for Bantam G	1
106	102251	Screw, Hex Hd., Guide Bar, .375-24x2.75	2	124	60332	Sticker, for Bantam GP	1
107	102021	Screw, Hex Hd., Sticker, .312-18x.625, for Bantam G	2	125	40711A	Switch, On-Off Toggle	1
108	102239	Screw, Hex Hd., Sticker, .250-28x1.00, for Bantam GP	2	126	61510	Thumb-piece, Oiler	1
109	60050	Screw, Sealed, Fuel Tank, .250-20x1.00	4	127	60011	Trigger, Throttle	1
110	41057D	Screw, Pan Hd., Clamp 10-24x.50	1		61195	Trigger, Throttle Starting with Serial #EL #13550	1
111	41057A	Screw, Retainer, Shield #10-24x.62	2	128	60076	Tube, Fuel Pick-Up, Oil Pick-Up	2
				129	60969	Washer, Chain Adj.	1
				130	103648	Washer, Guide Bar	2
				131	48986	Washer, Fuel Pick-Up	1
				132	103607	Washer, Ignition Mtg.	2
				133	60084	Washer, Outer Race	4

Remington

COMPONENT PARTS

Models Bantam G Assembly No. 61500 & Bantam GP Assembly No. 61502

IMPORTANT

ALWAYS ORDER COMPONENTS BY PART NUMBER AND PART NAME.
INCLUDE MODEL AND SERIAL NUMBER.

REF. NO.	PART NUMBER	DESCRIPTION	QTY.
134	49951	Washer, Fuel Pick-Up	1
135	61841	Washer Assy., Sprocket	1
136	61548	Washer, Sprocket	1
137	39794	Washer, Thrust	2
138	61523	Washer, Thrust	1

REF. NO.	PART NUMBER	DESCRIPTION	QTY.
139	61544	Washer, Thrust	1
140	61545	Washer, Thrust	2
	103611	Washer, Shield (not shown)	1
141	60074	Wire, Throttle	1

GUIDES & CHAINS AVAILABLE FOR BANTAM G CHAIN SAW

Guide Size	Guide No.	Pro Kerf Chain	Pitch	Tang
18"	A2815	43 PK 58-57	7/16"	.058"
21"	A2817	43 PK 58-65	7/16"	.058"
24"	A2820	43 PK 58-72	7/16"	.058"

PINCHLESS GUIDE FOR BANTAM GP CHAIN SAW

14"	60335	43 PK 58-70	7/16"	.058"
-----	-------	-------------	-------	-------

ALL PURPOSE GUIDE FOR BANTAM G & GP CHAIN SAW

	61315	43 PK 58-78	7/16"	.058"
--	-------	-------------	-------	-------

BANTAM G CHAIN SAW ACCESSORIES

No. 18347	Lubricant, Roller Nose
No. 26462	Gear Lubricant
No. 48411	Remington Chain Saw Oil
No. 60729	Grease Gun
No. 60730	Grease Gun Replacement Tip
No. 40542	Round Cutter File 1/4"
No. 35219	Round Cutter File, 7/32" for 7/16" Chain
No. 48520	Roller Nose, 2-1/2" Diameter
No. 48535	Depth Gauge Sharpening Guide
No. 61319	File Guide (New)
No. 48880	File Guide
No. 60736	Combination Wrench
No. 50319	Wedge, Aluminum Alloy