

CARBURETOR MODEL: DY-10A
 "Thermo King" Rail Car Refrigeration
 Unit W/Crosley, 4 Cyl. Engine.

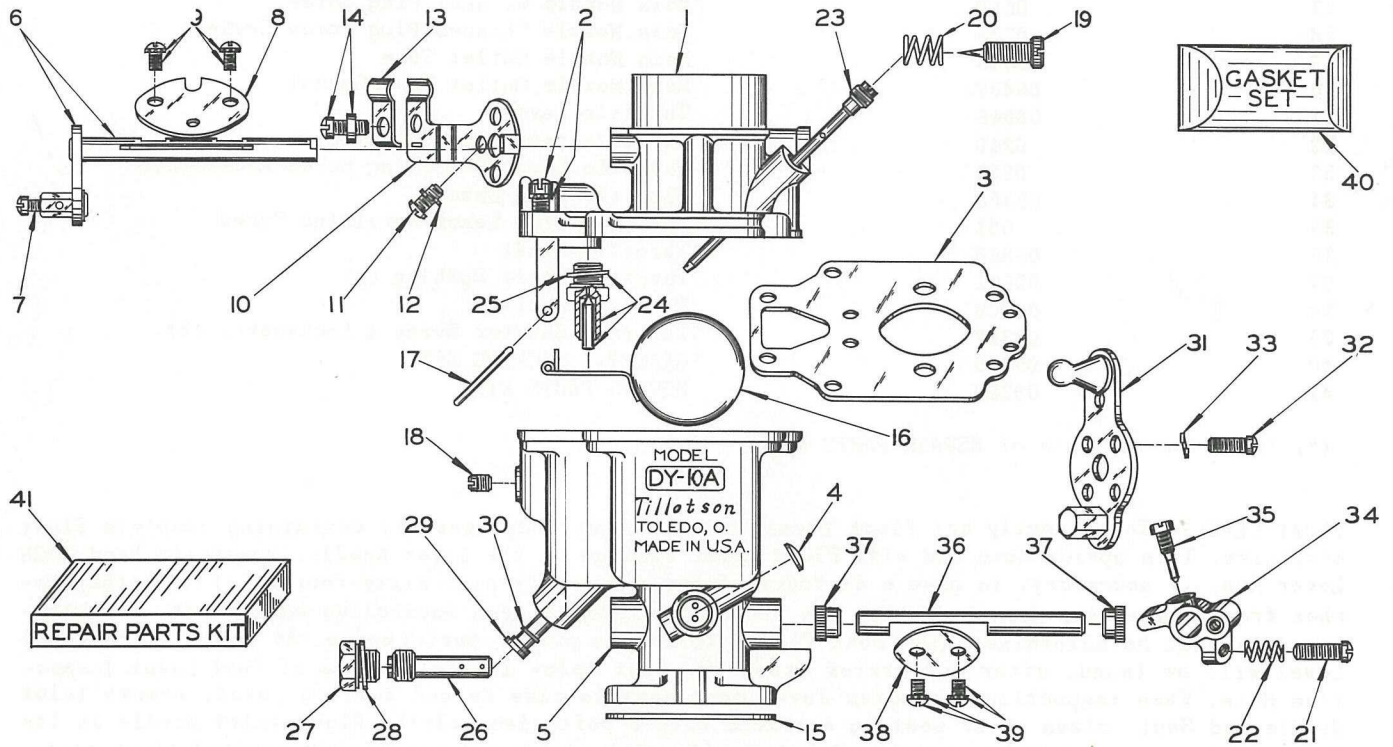

WHEN ORDERING, PLEASE SPECIFY FULL CARBURETOR MODEL AND COMPLETE PART NUMBER, NAME AND PRICE.

| Ref. No. | DY-10A Part No. | Part Name |
|----------|-----------------|---|
| 1 | 07809 | Air Horn |
| 2 | 08420 | Air Horn Retaining Screw & Lockwasher (6) |
| 3 | 06409 | Air Horn Gasket |
| 4 | 02531 | *Body Channel Welch Plug |
| 5 | 09228 | Body (Includes Shaft & Shutter) |
| 6 | 08334 | Choke Shaft & Lever |
| 7 | 058 | *Choke Wire Retaining Screw |
| 8 | 07437 | Choke Shutter |
| 9 | 08317 | Choke Shutter Screw & Lockwasher (2) |
| 10 | 05404 | Choke Wire Bracket |
| 11 | 01974 | Choke Wire Bracket Retaining Screw (2) |
| 12 | 0992 | Choke Wire Bracket Retaining Screw Lockwasher (2) |
| 13 | 03028 | Choke Wire Clamp |
| 14 | 0799 | Choke Wire Clamp Bolt & Nut |
| 15 | 0278 | Flange Gasket |
| 16 | 06436 | Float |
| 17 | 06233 | *Float Lever Pin |

TILLOTSON MANUFACTURING CO.

PARTS AND SERVICE DIVISION

TOLEDO, OHIO 43612

Specifications or part numbers subject to change.

| Ref. No. | DY-10A Part No. | Part Name |
|----------|-----------------|---|
| 18 | 03311 | *Float Bowl Inspection Screw |
| 19 | 06336 | *Idle Adjustment Screw |
| 20 | 0737 | *Idle Adjustment Spring |
| 21 | 05095 | *Idle Speed Regulating Screw |
| 22 | 0788 | *Idle Speed Regulating Screw Spring |
| 23 | 07009 | *Idle Tube |
| 24 | 06287 | *Inlet Needle, Seat & Gasket |
| 25 | 0676 | Inlet Seat Gasket |
| 26 | 09226 | *Main Nozzle |
| 27 | 0649 | *Main Nozzle Channel Plug Screw |
| 28 | 0225 | Main Nozzle Channel Plug Screw Gasket |
| 29 | 06406 | Main Nozzle Outlet Tube |
| 30 | 06407 | Main Nozzle Outlet Tube Gasket |
| 31 | 08546 | Throttle Lever |
| 32 | 0240 | Throttle Lever Retaining Screw |
| 33 | 0992 | Throttle Lever Retaining Screw Lockwasher |
| 34 | 06355 | Throttle Stop Lever |
| 35 | 051 | *Throttle Stop Lever Retaining Screw |
| 36 | 06363 | *Throttle Shaft |
| 37 | 02661 | Throttle Shaft Bushing (2) |
| 38 | 07008 | Throttle Shutter |
| 39 | 08317 | *Throttle Shutter Screw & Lockwasher (2) |
| 40 | 07145 | *GASKET & PACKING SET |
| 41 | 09329 | REPAIR PARTS KIT |

(*) Indicates contents of REPAIR PARTS KIT.

FLOAT LEVEL: To correctly set Float Level, remove Upper Body Assembly containing complete float mechanism. Turn upside down and with Float Lever resting on the Inlet Needle, carefully bend EACH Lever Arm, if necessary, to give a distance of one and twenty-nine sixty-fourths (1-29/64ths) inches from face of Air Horn Gasket to the then top of raised seam encircling each Float. The measurements must be maintained with both Floats to obtain proper performance. As a guide, the Fuel Level will be found, after carburetor assembly, just below lowest portion of Fuel Level Inspection Hole. When inspection indicates level continues to rise beyond setting point, remove Inlet Needle and Seat, clean their seating surfaces with a soft clean cloth. Place Inlet Needle in its Seat and tap very lightly, turning Inlet Needle with thumb and forefinger several times to re-seat. Reinstall, and if proper level is not maintained, install a new Inlet Needle, Seat and Gasket. DO NOT CHANGE GASOLINE LEVEL FROM MANUFACTURERS SPECIFICATIONS.

IDLE MIXTURE ADJUSTMENT: Open Idle Adjustment Screw (Ref. 19) one (1) full turn open from closed position. This should approximate the final setting for the Idle Adjustment Screw. After making this adjustment, choke engine and start in usual manner.

Revised 7/52

CARBURETOR MODEL: DY-11A

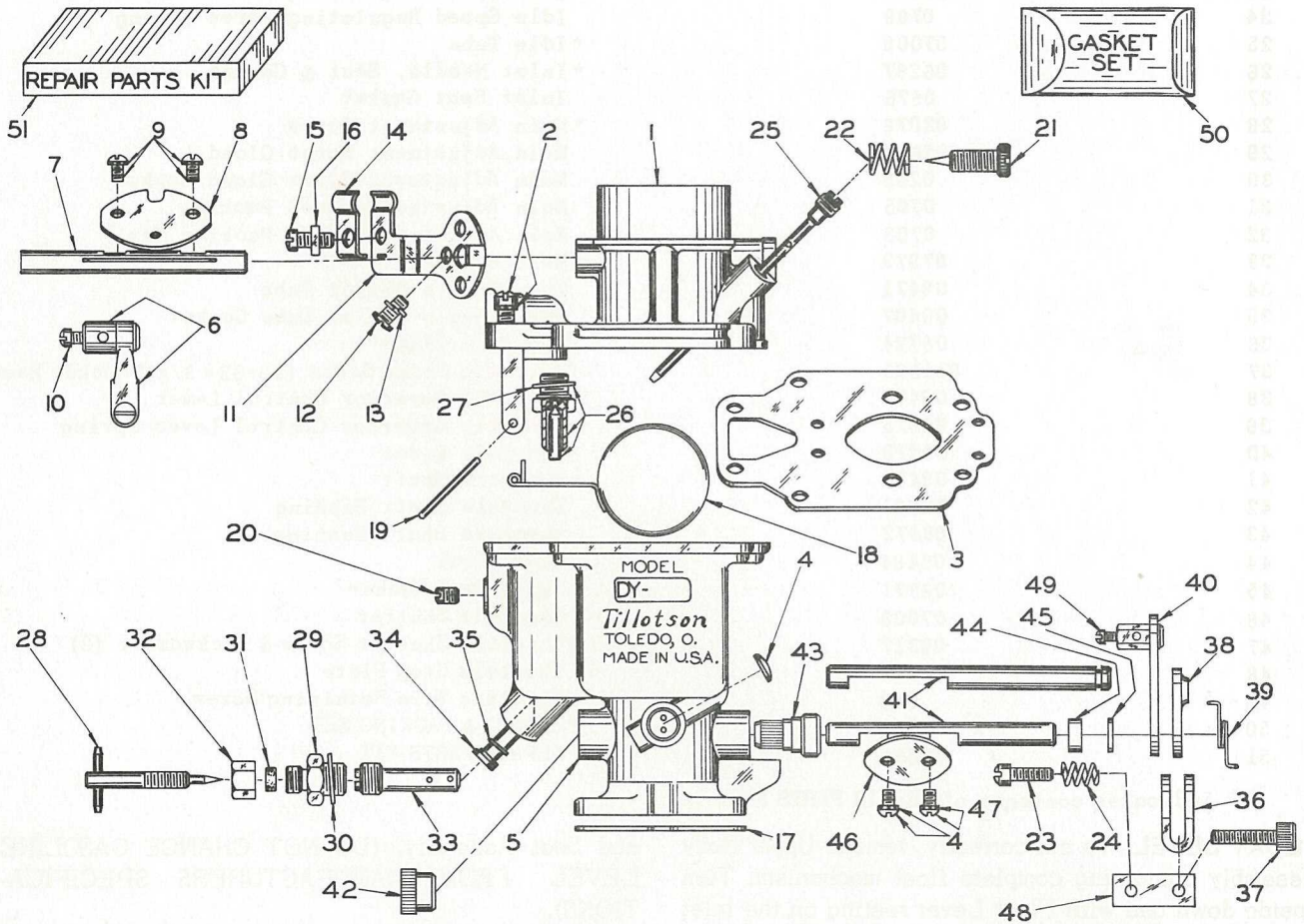

WHEN ORDERING, PLEASE SPECIFY FULL CARBURETOR MODEL AND COMPLETE PART NUMBER AND NAME.

| Ref. No. | DY-11A Part No. | Part Name |
|----------|-----------------|---|
| 1 | 07441 | Air Horn |
| 2 | 08420 | Air Horn Retaining Screw & Lockwasher (6) |
| 3 | 06409 | Air Horn Gasket |
| 4 | 02531 | *Body Channel Welch Plug |
| 5 | 09480 | Body (Includes Shaft & Shutter) |
| 6 | 09590 | Choke Lever (with Swivel) |
| 7 | 09476 | Choke Shaft |
| 8 | 09453 | Choke Shutter |
| 9 | 08317 | Choke Shutter Screw & Lockwasher (2) |
| 10 | 058 | *Choke Wire Retaining Screw |
| 11 | 05404 | Choke Wire Bracket |
| 12 | 01974 | Choke Wire Bracket Retaining Screw |
| 13 | 0992 | Choke Wire Bracket Retaining Screw |
| | | Lockwasher |
| 14 | 03028 | Choke Wire Clamp |
| 15 | 054 | Choke Wire Clamp Bolt |
| 16 | 05797 | Choke Wire Clamp Nut |

FUEL STRAINERS



CARBURETORS

| Ref. No. | DY-11A Part No. | Part Name |
|----------|-----------------|--|
| 17 | 0278 | Flange Gasket |
| 18 | 06436 | Float |
| 19 | 06233 | *Float Lever Pin |
| 20 | 03311 | *Float Bowl Inspection Plug Screw |
| 21 | 06336 | *Idle Adjustment Screw |
| 22 | 0737 | *Idle Adjustment Screw Spring |
| 23 | 01108 | *Idle Speed Regulating Screw |
| 24 | 0788 | Idle Speed Regulating Screw Spring |
| 25 | 07009 | *Idle Tube |
| 26 | 06287 | *Inlet Needle, Seat & Gasket |
| 27 | 0676 | Inlet Seat Gasket |
| 28 | 03076 | *Main Adjustment Screw |
| 29 | 02656 | Main Adjustment Screw Gland |
| 30 | 0225 | Main Adjustment Screw Gland Gasket |
| 31 | 0705 | Main Adjustment Screw Packing |
| 32 | 0703 | Main Adjustment Screw Packing Nut |
| 33 | 07973 | *Main Nozzle |
| 34 | 09471 | Main Nozzle Outlet Tube |
| 35 | 06407 | Main Nozzle Outlet Tube Gasket |
| 36 | 06724 | Throttle Clamp |
| 37 | 011695 | *Throttle Clamp Screw (10-32 x 3/4" Socket Head) |
| 38 | 09473 | Throttle Governor Control Lever |
| 39 | 09475 | Throttle Governor Control Lever Spring |
| 40 | 09478 | Throttle Lever |
| 41 | 09477 | *Throttle Shaft |
| 42 | 02661 | Throttle Shaft Bushing |
| 43 | 09472 | Throttle Shaft Bushing |
| 44 | 09484 | Shaft Seal |
| 45 | 06371 | Shaft Seal Washer |
| 46 | 07008 | Throttle Shutter |
| 47 | 08317 | *Throttle Shutter Screw & Lockwasher (2) |
| 48 | 06712 | Throttle Stop Plate |
| 49 | 058 | Throttle Wire Retaining Screw |
| 50 | 07144 | *GASKET & PACKING SET |
| 51 | 09531 | REPAIR PARTS KIT |

(*) Indicates contents of REPAIR PARTS KIT.

FLOAT LEVEL: To set correctly, remove Upper Body Assembly containing complete float mechanism. Turn upside down and with Float Lever resting on the Inlet Needle, carefully bend EACH lever arm, if necessary, to give a distance of one and twenty-seven sixty-fourths (1-27/64) inches from face of body gasket to the then top of raised seam encircling each Float. This measurement must be maintained with both floats to obtain proper performance. As a guide, the fuel level will be found, after carburetor assembly, just below lowest portion of Float Bowl Inspection Hole. When inspection indicates level continues to rise beyond setting point, remove Inlet Needle and Seat, clean their seating surfaces with a soft clean cloth. Place Inlet Needle in its Seat and tap very lightly, turning Inlet Needle with the thumb and forefinger several times to reseal. Reinstall and if proper level is not maintained, install a new Inlet Needle

and Seat Assembly. (DO NOT CHANGE GASOLINE LEVEL FROM MANUFACTURERS SPECIFICATIONS).

INITIAL ADJUSTMENT: Open Idle Adjustment Screw 3/4ths to one (1) full turn open from closed position. Proceed in like manner with Main Adjustment Screw except open approximately 2 full turns from closed position.

POWER RANGE ADJUSTMENT: Final setting of Main Adjustment Screw after correct adjustment mixture is made should be approximately 2 full turns open.

IDLE MIXTURE ADJUSTMENT: Made only after Power Range completed - the final Idle Adjustment Screw setting should be between 3/4ths and one (1) full turn open.

Rev. 3/59