

**OPERATING
INSTRUCTIONS
AND
SPARE PARTS
LIST FOR THE**

Villiers

**TWO STROKE
ENGINE
MARK 27B**

FROM FEB. 1st. 1955 UNTIL FURTHER
NOTICE ALL PRICES IN THIS LIST
ARE INCREASED BY 5%

Price
1/-

The Villiers Engineering Co. Ltd.
WOLVERHAMPTON, England

ESTABLISHED 1898

Telegrams:
"VILLIERS"
WOLVERHAMPTON

Telephone:
21666-7-8 WOLVERHAMPTON
20851 SERVICE DEPT.

**KEEP THIS BOOK SAFELY
FOR REFERENCE**

V.E.C. 105.

APRIL, 1954

OPERATING INSTRUCTIONS
FOR THE
VILLIERS ENGINES

TWO **Mk. 27B.** STROKE

Bore : 70 mm. Stroke : 90 mm. Capacity : 346 cc.

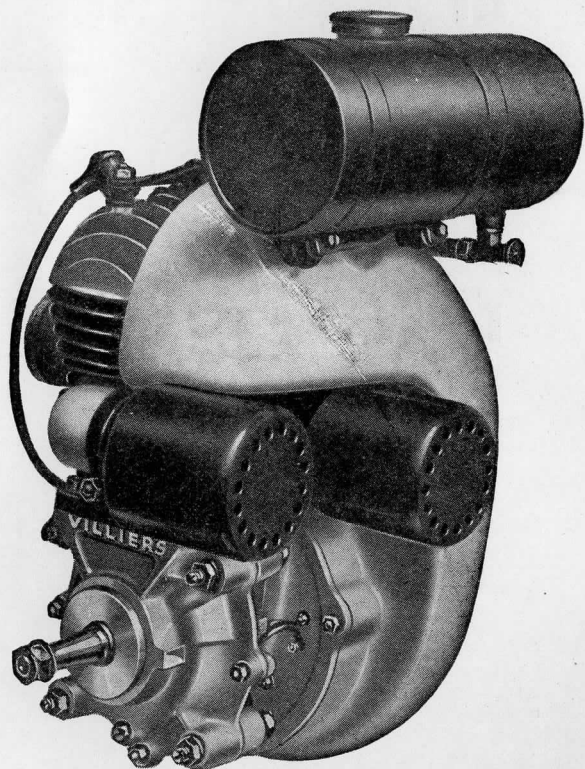

**BEFORE STARTING THIS ENGINE FOR THE FIRST TIME
READ OPERATING INSTRUCTIONS CAREFULLY**

THE VILLIERS MARK 27B ENGINE



OPERATING INSTRUCTIONS

1. **FIXING.**

The engine should be securely fixed and stand reasonably upright, otherwise lubrication and carburation will be adversely affected.

2. **BEFORE STARTING.**

This engine is lubricated by petroil, which is a mixture of oil and petrol in the proportion of one part of lubricating oil to twenty parts of petrol. The useful life and amount of good service the engine will give, depends almost entirely upon the way it is lubricated, especially during the early stages of its life.

CASTROL XL OIL, obtainable at most garages, has been found to give good results, and as it is advisable always to use one particular brand of oil and not to change from one to another, Villiers owners are advised to adopt this brand regularly.

The Villiers engine is as reliable as engineering skill can make it, and the only constant attention which the owner is asked to give it, is to ensure that the correct oil is thoroughly mixed with the petrol before putting into fuel tank.

An oil measure is fitted to the tank filler cap, the required number of measures being stated on the cap.

3. **TO START — WHEN COLD.**

After putting petroil mixture in tank turn petroil on by pulling tap knob. Turn bar of needle adjusting rod (Illustration 10, page 14) anti-clockwise as far as it will go, to raise needle in jet.

Press tickler at side of carburetter body until petroil is seen to drip. There is no need to allow petroil to run to waste.

Open carburetter control lever about one third of its full opening.

Wind starting rope around pulley on flywheel magneto in a clockwise direction, with one end in the pulley notch, the other end being gripped in, but not round the hand.

Then give a brisk pull to rotate the engine, pulling the rope clear of the starting pulley.

After engine has started, turn needle bar clockwise (to lower needle in jet) as far as possible consistent with good running, it should not then be necessary to alter setting until again starting from cold.

4. TO START — WHEN HOT.

The same procedure as for cold starting should be adopted, except that it should not be necessary to raise needle bar or to flood by pressing tickler.

FAILURE TO START.

If the engine will not start after a reasonable number of trials, ascertain whether this is due to lack of compression, faulty fuel supply, or faulty ignition.

COMPRESSION should be felt when the engine is rotated at normal starting speeds with throttle partly open.

FUEL SUPPLY.

Depress tickler at side of carburetter body. If fuel is reaching float chamber it will spurt out of vent at top of tickler.

IGNITION SYSTEM.

Unscrew sparking plug from cylinder head and place it with ignition cable attached, on a metal portion of the engine. When the engine is rotated a spark should be visible at the plug points, if the plug and ignition system are in order. If there is no spark, try a new plug or alternatively check whether a spark occurs at the end of the ignition cable when this is held about one-eighth inch away from a clean metal part of the engine.

After these preliminary tests it will be clear where a more detailed examination may be required.

5. RUNNING IN.

Whilst the engine is new, it is advisable to add a little extra oil to the petrol and also to set the carburetter needle adjustment a little on the "rich" side rather than too weak.

MAINTENANCE AND REPAIRS

1. DECARBONISING.

Decarbonising the Villiers Two-Stroke Engine is quite straightforward, because of the simplicity of this type of unit, the following points, however, are worth special attention.

When removing and replacing the cylinder, care should be taken not to twist it round the piston—it should be pulled off or pushed on straight so that the rings cannot catch in any of the ports and break.

All carbon should be removed from inside the piston head, as well as from the top of the piston and from the cylinder head. The ports in the cylinder—particularly the exhaust port, should receive careful attention, and should be kept clean, but on no account must the size or shape of these ports be altered by filing.

Piston ring grooves must be kept free from carbon in order to leave the rings quite free. Piston rings should be bright round their surface which makes contact with the cylinder bore. Should wear cause the joint gap to exceed $1/32$ in. when in the cylinder, the piston ring should be replaced.

Carbon will form on the gudgeon pin at either side of the small end bush, and this should be carefully removed, otherwise difficulty will be experienced in removing the pin from the piston. The small end bush and the piston bosses should be kept quite free from carbon.

No washer or gasket is used between the cylinder barrel and head on Villiers engines with detachable cylinder heads. A perfect gas-tight joint is made by screwing down the cylinder head bolts tightly, and by giving it a final tighten when the engine has cooled down after its first run. It is not necessary to put any jointing compound or shellac between the cylinder and head.

It is of the utmost importance that silencers and exhaust pipes are kept quite clean internally, and that a heavy deposit of carbon is not allowed to accumulate. This would cause back pressure and loss of power.

It is important that air leaks should be avoided.

The connection between carburetter and induction pipe must be absolutely airtight, and after dismantling an engine, new washers should always be fitted at the induction pipe joint, and cylinder base joint, if the original ones have been disturbed.

2. SPARKING PLUG.

The type recommended is the Lodge HLS, 18 mm.

Clean and reset the points .025 in. gap after each 100 hours operation.

Adjustment of the gap should be done by moving the points attached to the outer body of the plug. *Never bend the centre pin.* Keep the outside of the plug insulation free from water and dirt. When screwing the plug in the cylinder head, should any undue stiffness be experienced, do not use force but examine the thread for any particles of grit or carbon which may be present. These must be removed, otherwise the threads in the cylinder head may be damaged. It is a good plan to smear a little graphite grease on the plug threads before replacing.

3. PETROIL FILTER.

Two filter gauzes are provided, one being fixed to the tap in fuel tank, the other just inside the carburetter body inlet. These filters should be examined occasionally and cleaned by dipping in petrol.

4. AIR FILTER.

This must be removed every 100 hours, or more frequently under very dusty conditions, and washed in petrol, then dip in *thin oil*, and allow surplus to drain off before refitting. Oil bath filters should be dismantled and the old oil drained away, the filter should then be washed and re-filled with oil to level indicated on container.

5. CONTACT BREAKER.

The contact breaker points should be checked occasionally to see that they are clean, that the gap when fully opened is between .012 in. and .016 in., and that they open and close properly. To obtain access to points, first remove cowl front (Illustration 42, page 12), then the starter pulley (Illustration 4), after which the condenser box cover (Illustration 8) can be taken off.

The magneto screwdriver supplied has a feeler gauge attached, which should be used to check the point gap.

6. MAGNETO TIMING.

The magneto is timed so that the contact points commence to open when the piston is $\frac{5}{16}$ in. *before top* dead centre, but this figure varies to suit working conditions. We will give correct timing upon receipt of particulars. When the engine is built and timing set at required amount of advance, the flywheel is rotated until piston is at top of stroke. Two marks are then punched directly opposite one another, one mark being on the outside face of one of the fan blades, the other

being on the outer rim face of the cowl bottom portion. To rough check timing rotate flywheel to bring piston to top and if the marks are found to be opposite the timing can be said to be reasonably correct.

7. FLYWHEEL REMOVAL.

The cam operating the contact breaker is rivetted to the flywheel which is driven by a taper on the crankshaft, and if alteration to magneto time is necessary, the flywheel must be released, by unscrewing the centre nut with the box spanner provided in the tool kit. This *nut* has a right-hand thread and is imprisoned in the flywheel and it should be unscrewed until the flywheel is just free to revolve on the crankshaft. With the piston in its correct position, the flywheel should then be moved round until the points commence to open, then tighten up the nut firmly and re-check timing. This nut must be tightened up hard by hitting with a hammer on the end of the tommy bar.

The taper of shaft and cam must be clean and dry ; if any oil is present on the surfaces it will be impossible to secure an effective drive.

8. COOLING SYSTEM.

It is most important that the complete cowling and fan should be in position when the engine is running. On some engines a maximum speed governor is fitted to the top portion of cowling, should this be removed, it is essential that the opening in cowl should be closed by fitting a Cover Plate (Illustration 40, page 10) to prevent loss of cooling draught.

9. CARBURETTER.

This is the "Villiers" Type 5/1, having a single control lever to throttle, an independent adjustment of the taper needle is provided to give a very rich mixture at times when it is required, such as starting a cold engine (see par. 3—*Operating Instructions*).

There should not be any sharp bends in control cable, otherwise the inner cable will not work freely.

TO DISMANTLE.

First detach carburetter from engine after releasing clip screw. Unscrew the top ring, then pull out the throttle taking care not to damage taper needle, turn carburetter upside down, unscrew bottom nut, remove fibre washer, float cup and fibre washer.

To gain access to the fuel needle it is necessary to remove centre-

piece, but before this can be done, the compensating tube must be unscrewed from head of centrepiece (Illustration 16, page 14); removal of centrepiece, the fuel needle lever (Illustration 27) will swing to one side to allow fuel needle to be lifted out.

TO CHANGE THE TAPER NEEDLE.

After withdrawing throttle from body unscrew slotted screw in bottom end of throttle, the needle (Illustration 22, page 14) with spring will then pull out. When replacing taper needle take care that the spring is in position. The small end coil being immediately under head.

TO ASSEMBLE.

See that every part is clean. Place centrepiece in position with fibre washer under head, screw in compensating tube after making sure that fuel needle and lever are in position, then fit retainer (Illustration 28) to compensating tube.

Now place float on centrepiece and large fibre washer on cup seating, then cup and small fibre washer, finally fitting bottom nut taking care not to use too much force.

When refitting carburetter on inlet pipe, push right home to avoid air leaks.

HINTS AND TIPS



1. Always thoroughly mix the oil and petrol before putting in tank.
2. It is wise to filter your petrol mixture through a fine wire gauze when putting in tank.
3. Do not flood carburetter before starting when the engine is warm.
4. Stop engine by turning off fuel tap if engine is not to be used for several days.
5. Do not experiment with cheap sparking plugs, use type recommended.
6. Always quote engine number when ordering spares or asking for advice. The number with prefix letters and/or numbers is stamped on crankcase below cylinder base, at rear of engine.
7. Driving shafts should only be taken apart by a skilled mechanic. special tools are required for ensuring alignment when re-assembling, and as the makers have these facilities, repairs can be undertaken by them at the lowest cost.
8. It is important that air leaks should be avoided at the following points:
 - (a) Between inlet pipe and cylinder.
 - (b) Between inlet pipe and carburetter.
 - (c) Between cylinder base and crankcase.
 - (d) Between the two halves of crankcase.
 - (e) Between cylinder and cylinder head.
9. When decarbonising the engine it is very important that silencers and exhaust pipes are also cleaned out.
10. Avoid all sharp bends in the carburetter control cables.

VILLIERS 346c.c. ENGINE, Mk. 27B.

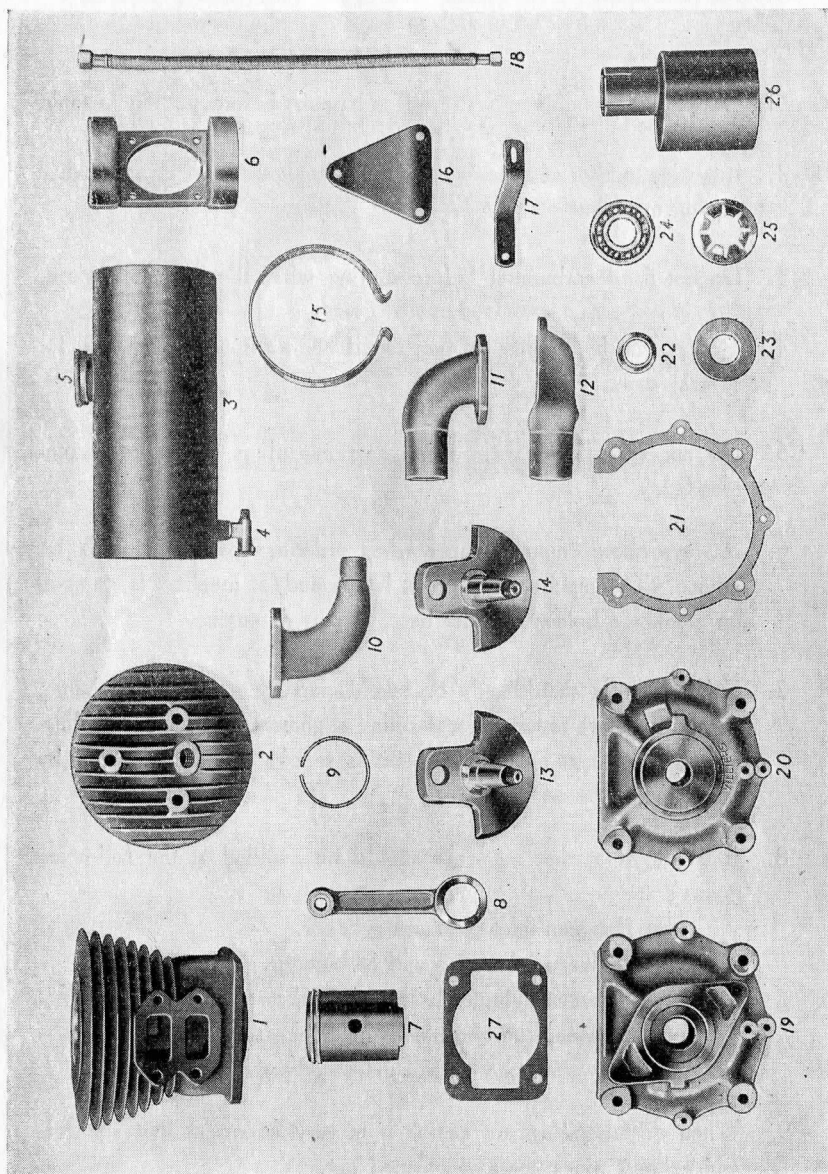

Always quote Engine No. when ordering spares.

Illus. No.	Part No.	Description	No. per Engine	Price each
			£	s. d.
1	B6662	Cylinder, less Studs	1	4 5 0
2	C6663	Cylinder Head	1	1 15 0
3	C7460	Tank, less Fittings, half gallon	1	1 1 0
3	M705	" " " one gallon	1	1 5 0
4	468	Petrol Tap	1	4 6
—	V107 x 4	" " Joint Washer	1	1
5	E7602	Filler Cap with Oil Measure	1	6 0
6	C6275	Tank Bracket	1	10 0
7	C6664	Piston only, S.A.C.	1	1 15 0
8	D1412	Con. Rod with Small End Brush	1	1 0 0
9	E6659	Piston Ring, Standard size	2	1 9
9	E7233	" " 15 thous. oversize	2	1 9
9	E7234	" " 30 thous. oversize	2	1 9
10	C6667	Inlet Manifold, fitted Magneto side	1	1 5 0
—	D6708	" " (for Air Governor)	1	1 5 0
11	C3748	Exhaust Manifold, fitted Drive side	1	1 2 6
12	C6665	" " " Mag. side	1	1 2 6
13 } 14 }	D6388	Driving Shaft	2	2 5 0
15	D6282	Tank Strap for Half Gallon Tank	2	1 0
13	D6687	" " " One Gallon Tank	2	1 0
16	D6286	Cylinder Head Strap	1	1 3
18	V116D	Flexible Petrol Pipe	1	7 6
19	B6366	Crankcase Half, Magneto side	1	3 0 0
20	B6367	" " Drive side	1	3 0 0
21	D2810	" Joint Washer, 6 thou. thick	1	2
21	D6088	" " " 10 thou. thick	1	4
22	E6235	Drive Shaft Gland Bush	2	6 0
23	E5071/1	" " Sealing Washer	2	2
24	3305	" " Ball Bearing	2	*
25	E4531	" " Gland Spring	2	9
26	C6713	Silencer	2	15 0
27	E3719	Cylinder Base Washer	1	4

* Manufacturer's current price.

VILLIERS 346c.c. ENGINE, Mk. 27B.

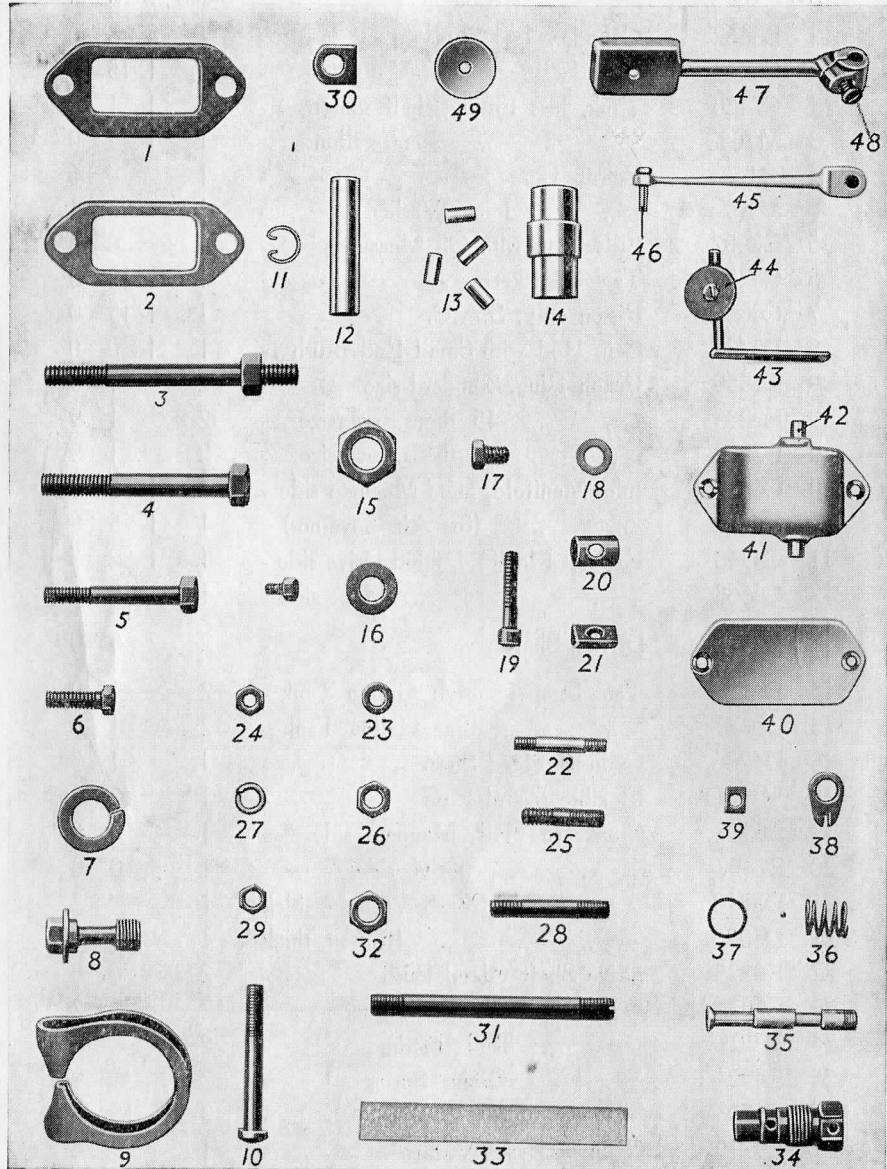

Always quote Engine No. when ordering Spares.

Illus. No.	Part No.	Description	No. per Engine			Price each		
			£	s.	d.			
1	E3717	Exhaust Manifold Washer	-	-	2	-	-	4
2	E3718	Inlet	-	-	1	-	-	2
3	E6674	Cylinder Head Bolt	-	-	2	3	0	-
4	E2442	"	-	-	2	-	-	6
5	E6714	Exhaust Manifold Bolt, Mag. side	-	-	1	1	0	-
6	FG151	Inlet Manifold Screw	-	-	2	-	-	6
7	E424	Spring Washer, Drive Shaft	-	-	1	-	-	1
8	E6753	Fixing Screw, Starting Pulley	-	-	1	2	0	-
9	D1676	Exhaust Pipe Clip	-	-	2	1	6	-
10	E435	Bolt for Clip	-	-	2	-	-	4
11	E4047	Circlip, Gudgeon Pin	-	-	2	-	-	3
12	E6666	Gudgeon Pin	-	-	1	3	0	-
13	E7453	Con. Rod Roller, Steel	-	-	28	5	0	-
14	E7440	Crankpin	-	-	1	6	0	-
-	E5593	" Plug	-	-	2	-	-	3
15	E422	Driving Shaft Nut, 1/8 in.	-	-	1	-	-	6
16	E1898	Washer, 3/8 in., Cylinder Head Bolt	-	-	4	1	1	-
17	E1962	Drain Screw, Crankcase	-	-	2	-	-	3
18	E1905	" " Washer	-	-	2	-	-	1
19	E781	Screw, Tank Strap	-	-	2	-	-	6
20	EG532	Trunnion, Tank Strap, Tapped Hole	-	-	2	10	-	-
21	EM276	" " Plain Hole	-	-	2	-	-	6
22	E3392	Joint Stud, Crankcase	-	-	3	-	-	5
23	E2924	Plain Washer for Stud, 1/4 in.	-	-	13	-	-	1
24	E401	Nut for Stud, 1/4 in.	-	-	13	-	-	2
25	E363	Stud, 5/16 in., Manifolds and Tank Bracket	-	-	6	-	-	3
26	E364	Nut, 5/16 in., for Stud	-	-	11	-	-	2
27	E1050	Spring Washer, 5/16 in.	-	-	15	-	-	1
28	EG283	Stud, 1/4 in., Arm Plate Fixing	-	-	2	-	-	6
29	E3961	Nut for Stud, 1/4 in.	-	-	2	-	-	2
30	E6237	Lockwasher for Nut	-	-	2	-	-	1
31	E1482	Engine Fixing Stud, 3/8 in.	-	-	4	-	-	9
32	E834	Nut for Stud, 3/8 in.	-	-	10	-	-	2
-	E373	Washer	-	-	10	-	-	1
33	E5856	Felt Tank Pad, 1/2 gal.	-	-	2	-	-	6
40	E6688	Cowl Cover Plate	-	-	1	2	6	-
41	D6590	Governor Bracket	-	-	1	4	0	-
42	E6618	" Pivot Pin	-	-	1	-	-	4
43	E6614	" Throttle Lever and Spindle	-	-	1	2	0	-
44	E6615	" " Plate	-	-	1	-	-	3
-	EM362	" " " Screw	-	-	2	-	-	2
-	-	" " " Washer	-	-	1	-	-	1
45	E6613	" Lever	-	-	1	3	0	-
46	E6784	" " Screw	-	-	1	-	-	3
47	E6787	" Vane	-	-	1	5	0	-
48	EG527	" Clamp Screw	-	-	4	-	-	3
-	1002 x 15	" " " Nut	-	-	1	-	-	2
-	1004 x 5	Nut, Governor Lever Screw	-	-	1	-	-	2
49	E6788	Weight, Governor Vane	-	-	1	-	-	3
-	E2152	Stud, Cylinder Base	-	-	4	-	-	3

VILLIERS 346c.c. ENGINE, Mk. 27B.

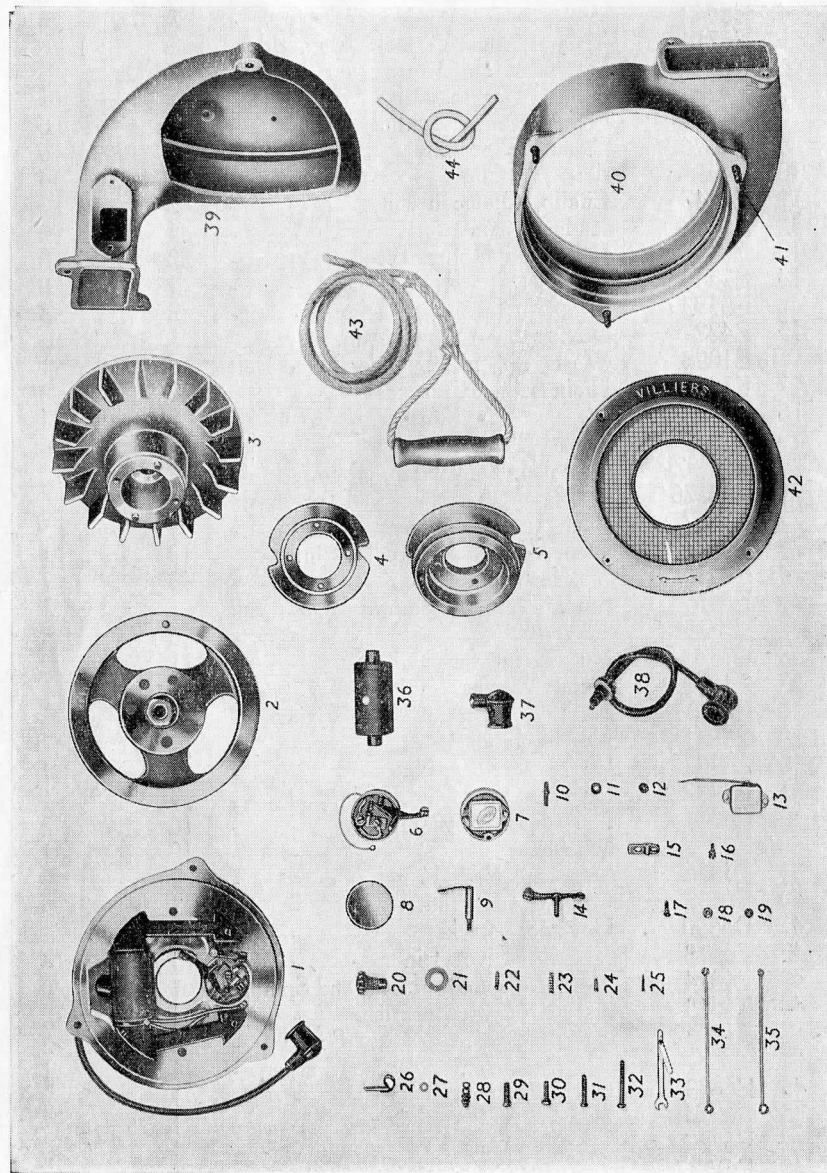

Always quote Engine No. when ordering Spares.

Illus. No.	Part No.	Description	No. per Engine	Price each
				£ s. d.
—	E4160	Stud, Cowl Top	1	3
—	E5107	" " Joint	2	3
—	FG186	Washer, Cowl Top Stud	1	1
1	M1828	Armature Plate Assembly	1	5 0 0
2	M1827	Flywheel Assembly, less Fan & Pulley	1	5 0 0
3	CM208	Fan	1	1 10 0
4	C6223	Starter Pulley	1	1 5 0
6		Condenser Box Assembly complete	1	18 6
7	M1776	" " with Condenser & Studs	1	10 0
8	1015 x 7	" " Cover	1	6
9	1015 x 6	" " " Post and Clip	1	6
10	1053 x 1	" " Stud	2	3
11	1002 x 15	" " " Nut	11	2
12	1002 x 13	" " " Washer	11	1
13	M1750	Condenser	1	4 9
14	484	Rocker Arm with Point and Pad	1	4 0
15	1022 x 7	Con. Box Point Clamp	1	1 6
16	487	Adjustable Point with Locknut	1	2 0
17	1013 x 3	Clamp Screw	2	3
18	1013 x 13	" " Bush, top	2	5
19	1013 x 12	" " " bottom	2	5
20	1124 x 8	High Tension Terminal	1	1 0
21	E869	" " Felt Washer	1	2
22	1010 x 11	" " Pickup Spring	1	1
23	1047 x 3	Rocker Arm Spring	1	2
24	1046 x 13	High Tension Pad	1	2
25	491	" " Pickup Screw	1	1
26	M1662	" " Cable Clip	1	3
27	1113 x 5	Plain Washer, Terminal Screw	3	1
28	1113 x 3	L.T. Terminal Screw, Cut Out	1	9
30	E4659	Fixing Screw, Cowl Front	4	3
—	FG151	" " Washer	4	1
31	1124 x 9	Cheek Screw, short	2	3
32	1030 x 8	" " long	2	3
33	M1665	Point Screwdriver with Gauge	2	7
34	482	L.T. Lead, Coil to Con. Box	1	6
35	—	" " " Cut Out Terminal	1	9
36	1030 x 16	High Tension Coil	1	1 15 0
37	M11	Waterproof Spark Plug Cover	1	1 3
38	1148 x 4	H.T. Lead, complete	1	4 0
39	B6668	Cowling, top portion, less Air Gov.	1	2 10 0
—	D6761	" " " with Air Gov.	1	2 15 0
40	B6458	" " bottom portion	1	3 10 0
41	E5294	Stud for bottom portion	3	3
42	C6777	Cowl Front with Gauze, no Air Gov.	1	17 6
—	B6776	" " " " for Air Gov.	1	1 0 0
43	D5877	Starting Strap	1	4 9
44	E6342	Felt Liner for Cowling	2	1 0
—	M1546	Box Spanner, Flywheel Nut	1	5 0

See Page 17 for details of latest type Contact Breaker.

VILLIERS 346c.c. ENGINE, Mk. 27B.

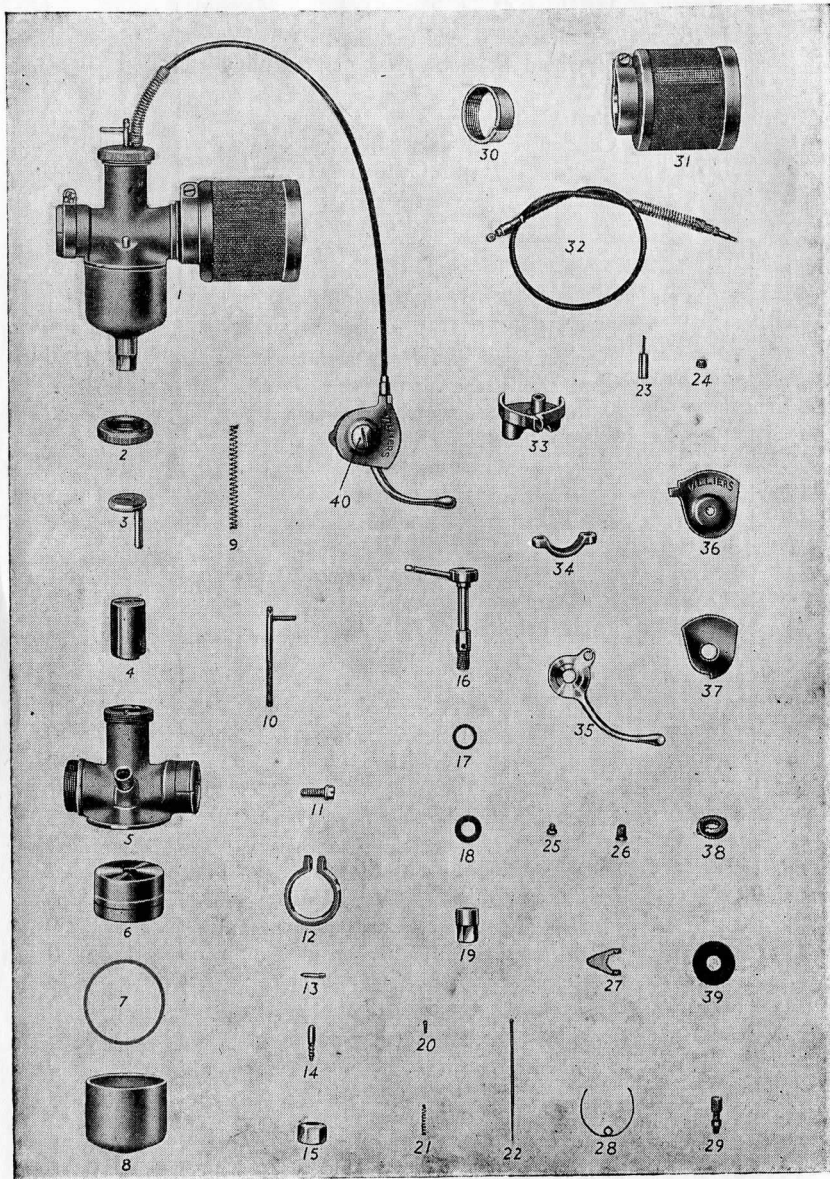

Always quote Engine No. when ordering Spares.

Illus. No.	Part No.	Description	No. per		Price each	
			Engine		£	s. d.
1	5/1	Carburettor complete	1		4	0 0
2	V108 × 7	Top Ring	1			2 0
3	V108 × 8	Top Disc with Guide Peg	1			2 6
4	V136 × 11	Throttle	1			5 0
5	V517D	Body with Fuel Needle Bush	1	1		7 6
6	V132 × 5	Float	1			4 0
7	V125 × 8	Cup Joint Washer	1			2
8	V151 × 3	Cup	1			3 0
9	V107 × 8	Throttle Spring	1			3
10	V136 × 12	Needle Control Rod with Bar	1			2 6
11	V107 × 16	Screw, Carburettor Body Clip	3			8
12	V113 × 14	Body Clip	1			2 3
13	V355E	Fuel Needle	1			10
14	—	Tickler complete	1			1 0
15	V105 × 8	Union Nut, Petrol Pipe	1			6
—	V105 × 9	„ Nipple, „ „	1			6
16	V434D	Centre Pitce	1			5 0
—	V436E	„ „ Compensating Tube	1			6
17	V107 × 3	„ „ Washer	1			1
18	V107 × 4	Bottom Nut Washer	1			1
19	V105 × 7	Bottom Nut	1	1		3
20	V375E	Drive Screw, Fuel Needle Lever	1			2
21	V107 × 7	Spring Taper Needle	1			2
22	V137 × 10	Taper Needle, No. 5	1			9
23	V136 × 3	Damper	1			6
24	V136 × 15	„ Plug	1			3
26	V275	Filter	1			6
27	V257E	Fuel Needle Lever	1			3
28	V545	Comp Tube Retainer	1			2
29	V105 × 1	Cable Adjuster and Nut	1			9
30	V518	Adaptor, Air Filter	1			2 6
31	V496	Air Filter, less Clip and Screw	1			12 6
32	—	Control Cable complete	1			5 0
33	V117 × 1	Control Body, 7/8 in. Clip	1			3 6
34	V117 × 3	„ „ Half Clip	1			1 6
35	V544	„ Lever	1			3 9
36	V117 × 4	„ Top Cover	1			6
37	V117 × 6	„ Friction Plate	1			6
38	V117 × 8	„ Spring Washer	1			2
39	V117 × 7	„ Fibre „	2			1
40	V117 × 5	„ Cover Screw	1			8

VILLIERS FLYWHEEL MAGNETO

We are now fitting a new and improved condenser box assembly.

The condenser box is made in a new light alloy, the rocker arm being pivoted in a graphite bronze bearing, ensuring long life.

It is not now necessary to use a spanner for contact point adjustment, a small screwdriver being the only tool necessary.

TO ADJUST THE POINT GAP PROCEED AS FOLLOWS :—

Turn flywheel until rocker pad is on top of cam profile of flywheel boss.

Release the screw "A," see illustration.

Position bracket "B" with .015 in. feeler gauge between contact points, tighten screw, taking care not to use too much force. It is not necessary to disturb screw "C" when adjusting the point gap.

To keep the felt pad moist, give a drop of oil occasionally.

The complete condenser box assembly is interchangeable with the type previously fitted, but when ordering, the number of the engine for which it is required should be stated.

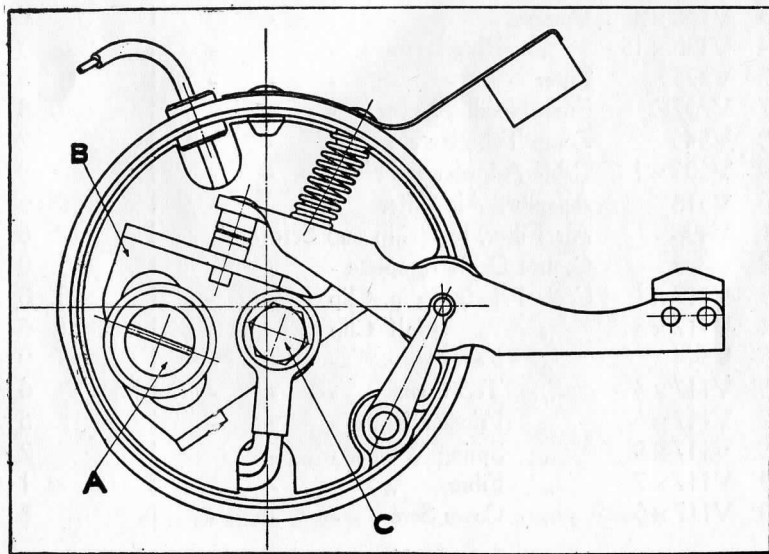

16

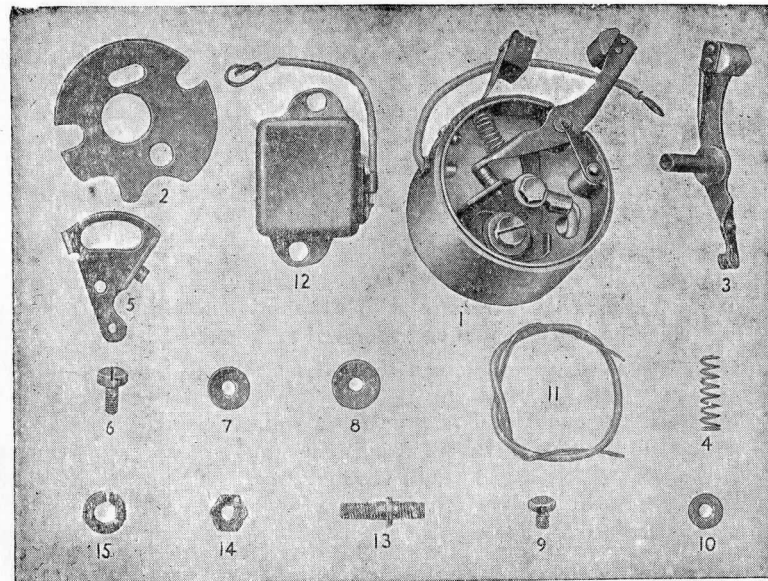

Illus. No.	Part No.	Description	No. per Engine	Price each £ s. d.
1	M1834	Complete Assembly as Illustration	1	18 6
	M2011	Condenser Box only, with Rocker Clip, Insulating Bushes and Oil Pad	1	4 6
	M2012	Ditto, but including Condenser, Fixing Studs, Nuts and L.T. Lead	1	10 0
2	M1803	Insulating Pad	1	4
3	M1632	Rocker with Point and Pad	1	4 0
4	1047 x 3	Rocker Spring	1	2
5	M1873	Bracket with Tungsten Point and Pivot Pin	1	2 3
6	M1801	Lock Screw, Point Bracket	1	2
7	M1802	Brass Washer for Screw	1	1
8	M1805	Insulating Washer for Screw	1	1
9	1006 x 3	L.T. Lead Connection Screw	1	2
10	1113 x 5	4BA Washer for Screw	1	1
11	482	L.T. Lead with Sleeve	1	6
12	M1750	Condenser only	1	4 9
13	1053 x 1	Condenser Fixing Stud	2	3
14	1002 x 15	Condenser Fixing Stud Nut	2	2
15	1002 x 13	Condenser Fixing Stud Washer	2	1

Always quote Engine No. when ordering Spares.

GUARANTEE

WE give the following guarantee with VILLIERS Engines and Accessories in place of any implied guarantee by statute or otherwise, all such guarantees being in all cases excluded. No statement or representation contained in this catalogue shall be construed as enlarging or varying this guarantee. In the case of engines and accessories which have been used for "hiring out" purposes, or from which our trade mark, name, or manufacturing number has been removed, no guarantee of any kind is given or is to be implied.

In the case of engines and accessories used for industrial and stationary purposes, this guarantee shall not apply unless the application of the engine has been agreed and approved in writing by us.

We guarantee, subject to the conditions mentioned below, that all precautions which are usual and reasonable have been taken by us to secure excellence of materials and workmanship, but this guarantee is to extend and to be in force for six months only from the date the engines or accessories are despatched by us, and the damages for which we make ourselves responsible under this guarantee are limited to the replacement of a part manufactured by us which may have proved defective.

We do not undertake to refit or bear the cost of replacement or refitting such new part. We guarantee, subject to the conditions mentioned below, to make good at any time within six months any defects in these respects. As VILLIERS Engines and Accessories are liable to derangement by neglect or misuse, this guarantee does not apply to defects caused by wear and tear, misuse and neglect.

CONDITIONS OF GUARANTEE.

If a defective part should be found in our engines or accessories, it must be sent to us carriage paid and accompanied by an intimation from the sender that he desires to have it repaired free of charge, under our guarantee, and he must also furnish us at the same time with the number of the engine, and full particulars of purchase. Failing compliance with the above, no notice will be taken of anything that may arrive, but such articles will lie here at the risk of the sender, and this guarantee or any implied guarantee shall not be enforceable.

THE TERM "AGENT" is used in a complimentary sense only, and those firms whom we style our agents are not authorised to advertise, incur any debts, or transact any business whatsoever on our account other than the sale of goods which they may purchase from us, nor are they authorised to give any warranty or make any representations on our behalf or sell subject to or with any conditions other than those contained in the above guarantee.

The guarantee becomes void if any parts not made or supplied by the VILLIERS ENGINEERING COMPANY, LTD., are fitted to a VILLIERS engine. To safeguard his own interests, the owner should always insist upon genuine VILLIERS parts.

ESTIMATES.

If required, we are always prepared to give an estimate before proceeding with any repair. This entails a certain amount of labour in dismantling to ascertain what new parts will be required, and therefore, in the case of any estimate not being accepted for special reasons, a small charge is made for our mechanic's time in taking down the parts for repair.

Estimates must be treated as approximate only. We reserve the right to include additional parts should these be found, on further examination or on bench test, to be necessary, to make the repair satisfactory.

We do not undertake to fit to engines sent to us for overhaul, any parts specified by the customer when we consider that other parts are necessary to make an efficient repair. In such cases, we are prepared to supply the customers' requirements in spares, but we do not undertake to fit them.

IMPORTANT.

1.—When sending parts for replacement, repair, or as pattern, the name and address of the sender should always be securely attached, and full instructions explaining what is required should be sent separately by post. In no circumstances should instructions be enclosed with the parts, as they are liable to be lost or damaged in unpacking.

2.—If an engine is sent for repair, it should be well packed in a strong box. Cardboard or a sack is insufficient, and engines so packed are liable to get seriously damaged in transit. Packing cases are not returnable unless specially asked for by the owner at the time of sending to us.

3.—All goods must be consigned to us carriage paid, addressed to "Service Dept." Goods returned by rail are consigned carriage paid.

4.—In correspondence, always quote the engine number and prefixed letter(s) stamped on the crankcase below the cylinder base.

5.—As we are not manufacturers of complete motor cycles or other machines, only the engine should be sent to us. If machines are forwarded, extra expense will be charged for dismantling the engine from the frame and refitting same.

6.—We prefer to bench test every repaired engine before returning it to its owner. It is, therefore, always advisable to send the engine complete with its magneto, sparking plug and carburetter.

7.—When forwarding a flywheel magneto for overhaul, send the armature plate and the flywheel complete. These parts should in no circumstances be separated, as certain magnetic flux is lost thereby.

8.—Always quote the magneto number and letter(s) (if any) which is stamped on the face of the flywheel, when corresponding about your flywheel magneto.

9.—*Old or worn-out parts sent as patterns, which we consider obsolete, are not returned unless specially asked for by the owner at the time of sending them to us.*

10.—Any engines or parts sent to our Works for repair not paid for within six months from the date of our estimate, will be offered for sale by us elsewhere to defray expenses.

NOTES

TERMS OF BUSINESS.

Repairs and spares must always be treated on a cash basis. Ledger accounts will be opened for items of £5 (five pounds) and upwards for approved accounts.

An extra amount must always be included in remittances to cover the cost of postage or carriage and packing on spare parts. This is 5% extra up to £5 value. Minimum extra is 6d. Stamps cannot be accepted for items over 1/- (one shilling) in value.

When making remittances by telegraph money order, the name and address of the sender must be included in the space provided on the Post Office Requisition Form for a private message from remitter to payee. Unless this is done, the Post Office does not give this information upon the telegram.

We are always prepared to send goods by C.O.D. method when requested.

Printed in England by
Whitehead Brothers (Wolverhampton) Ltd.
St. John's Square
Wolverhampton