

SOLO

70

CHAIN SAWS

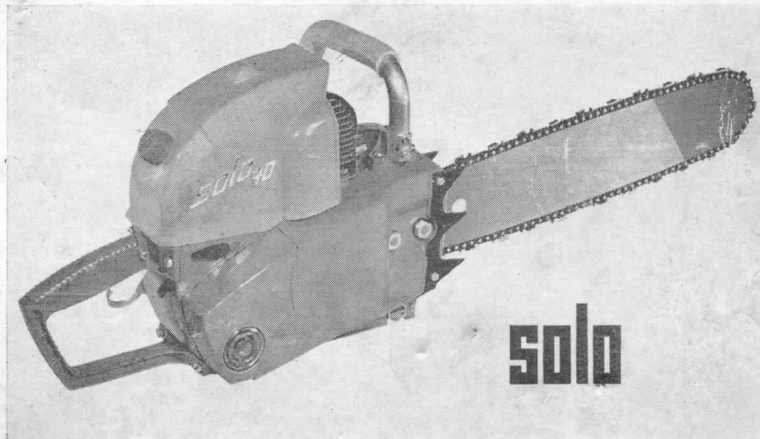

SOLO

Handwritten notes:
 364
 350
 15400
 110400
 128800
 129.91
 1104
 8.80.6

SPARE PARTS PRICE LIST INCLUDING KIT NUMBERS

SOLO DISTRIBUTORS PTY. LTD.

15-21 REYNOLDS STREET,
BALMAIN, SYDNEY, N.S.W.

Phone: 82 0194 (4 lines)

Telegrams: "SOLOMOTORS" Sydney

SOLO DISTRIBUTORS (VIC.) PTY. LTD.

233 RODEN STREET,
WEST MELBOURNE, VIC.

Phone: 30 1604, 30 1648

Telegrams: "SOLODIST" Melbourne

Langley

371

to Mr Daniel

116

SOLO

70

CHAIN SAWS

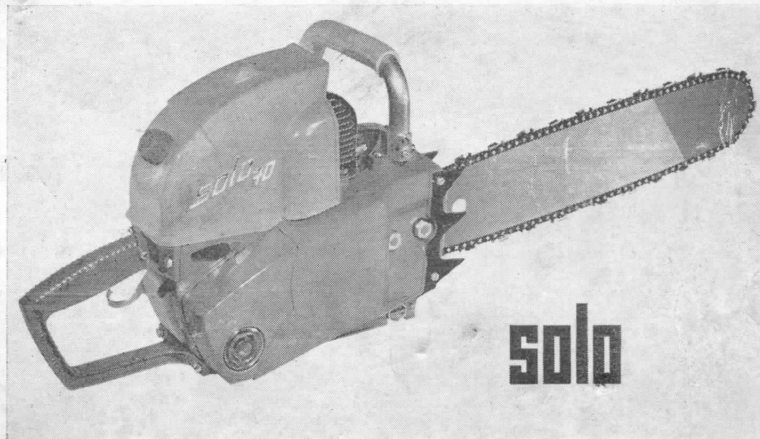

1.8/200

364
 350
 15400
 110400
 128800

129.91
 1104
 8.80.6

SPARE PARTS PRICE LIST INCLUDING KIT NUMBERS

SOLO DISTRIBUTORS PTY. LTD.

15-21 REYNOLDS STREET,
 BALMAIN, SYDNEY, N.S.W.

Phone: 82 0194 (4 lines)

Telegrams: "SOLOMOTORS" Sydney

SOLO DISTRIBUTORS (VIC.) PTY. LTD.

233 RODEN STREET,
 WEST MELBOURNE, VIC.

Phone: 30 1604, 30 1648

Telegrams: "SOLODIST" Melbourne

Langley

371

to Mr Daniel,

116

Fig. 5(a)

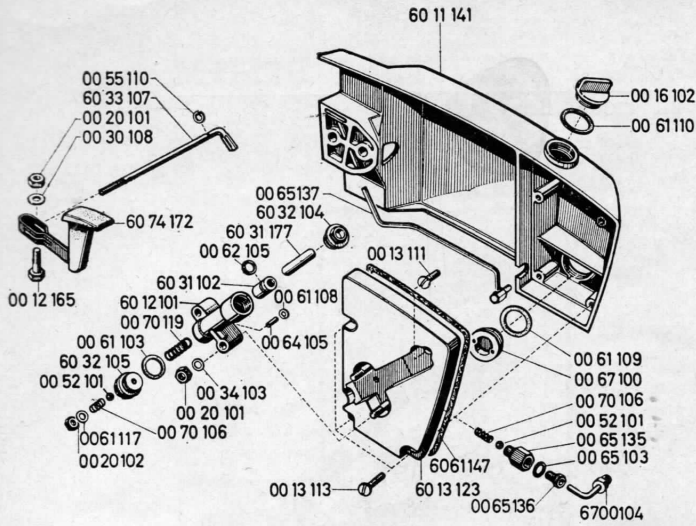

OILING SYSTEM

—on manual oiling (non-automatic)
Solo 70. Blue colour.

Fig. 5(b)

OILING SYSTEM (and chain guard)

—suit Automatic Oiling Solo 70. Blue colour.

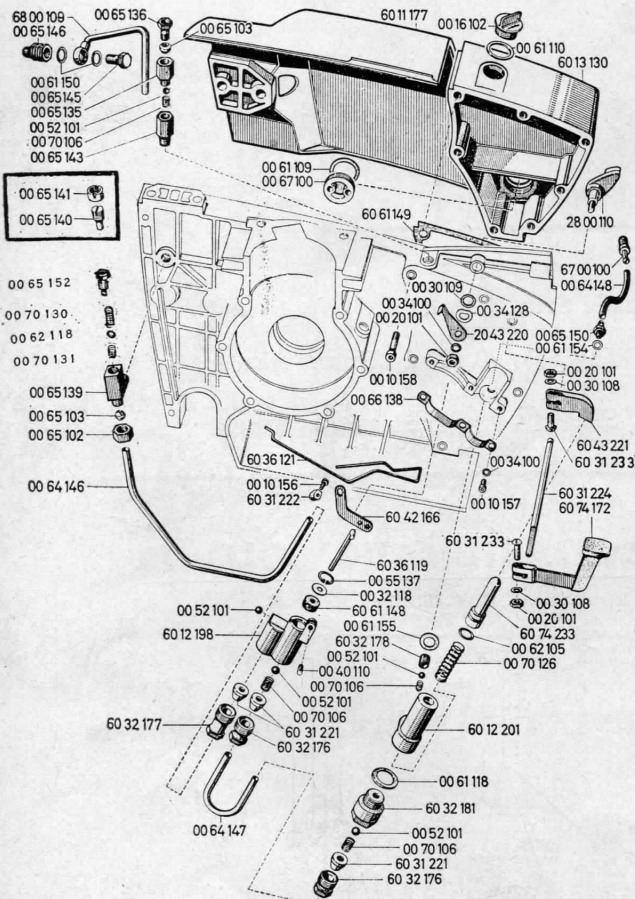

Please Note:

1. Oil adjusting screws (00 64 141 and 00 65 140)—in box—were on some machines but are now obsolete. Replace with adjusting screw (00 65 152), springs (00 70 130 and 00 70 131) and “o” ring (00 62 118). Use Kit 33.
2. Oil lever 60 74 172 is obsolete. Use 64 00 119, together with shaft 60 31 234 (which replaces 60 31 224).

Fig. 5(c)

OILING SYSTEM (and chain guard)

—suit all Solo 70 Yellow and Yellow Mark II models.

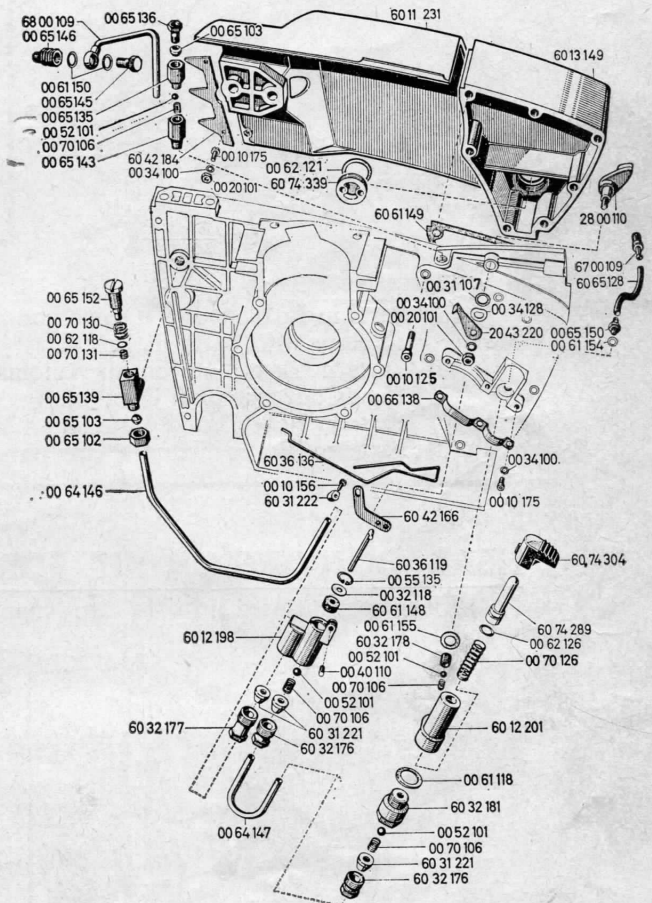

Please Note:

Oil filling cap (60 74 339) should be tightened FINGER TIGHT only.

Fig. 7(a)

RECOIL STARTER

— suit non-automatic (Blue) & automatic (Blue) Solo 70.

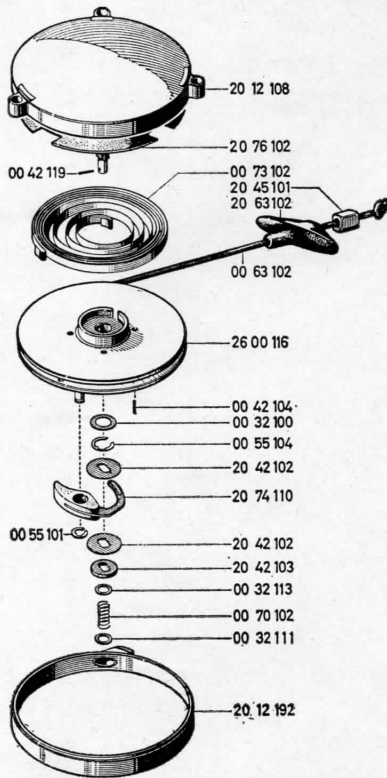

Length of centre shaft on housing (20 12 108) is 35 mm. (approx. $1\frac{3}{8}$ ").

Fig. 7(b)

RECOIL STARTER

—suit Yellow Solo 70 and Yellow Mark II Solo 70.

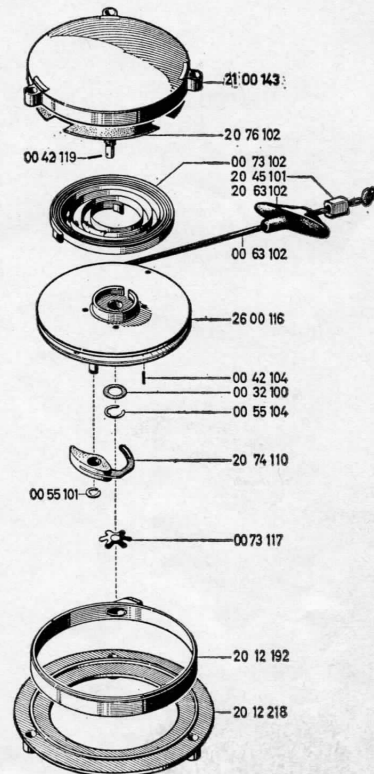

Length of centre shaft on housing (21 00 143) is 26 mm. (approx. 1").

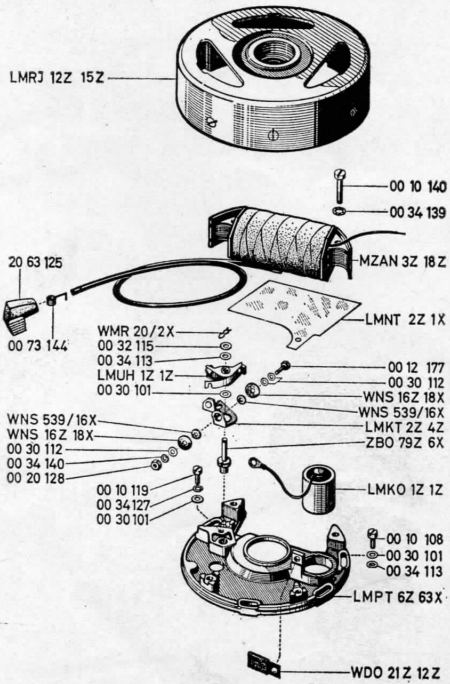

Fig. 7(c)

IGNITION SYSTEM

—all Solo 70 models.

Coil MZAN 3Z 20Z can also be used in place of MZAN 3Z 18Z.