

# MODEL HA

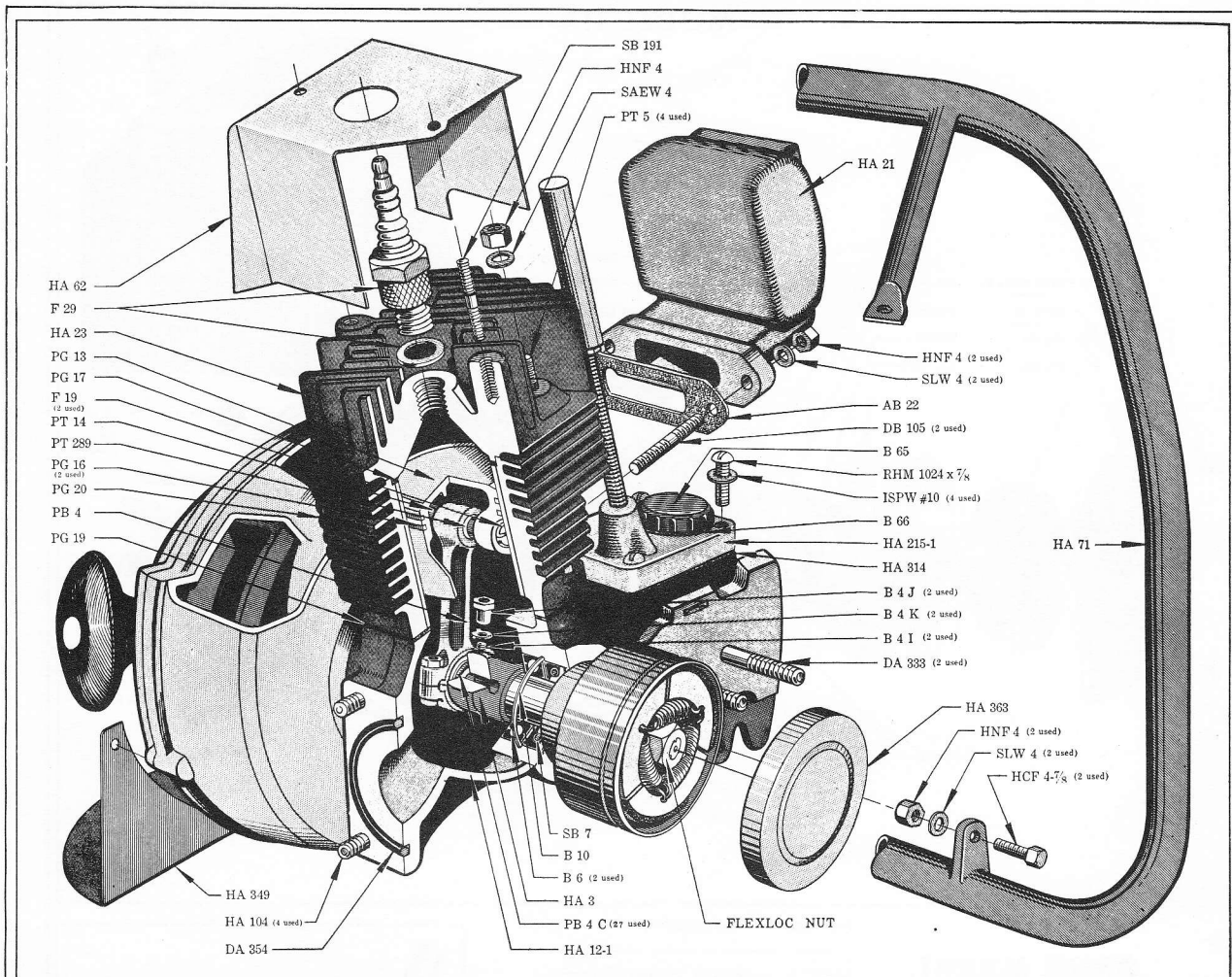

## ENGINE

PART NO.	PART NAME	PART NO.	PART NAME
AB 22	Exhaust Gasket	HCF 4 x 7/8	Rear Handle Bolts (2 used)
B 4 J	Con Rod Nut (2 used)	HNF 4	Cylinder Head Nut
B 4 K	Con Rod Washer (2 used)	HNF 4	Exhaust Nut (2 used)
B 4 I	Con Rod Bolt (2 used)	HNF 4	1/4 inch nuts (2 used)
B 6	Main Bearing (2 used)	ISPW No. 10	Lock Washer (4 used)
B 10	Clip Ring	PB 4	Con Rod
B 65	Oiler Filler Cap	PB 4 C	Loose Needles (27 used)
B 66	Oiler Filler Cap Gasket	PG 13	Piston
DA 333	Strut Stud (2 used)	PG 16	Piston Rings (2 used)
DA 354	Swivel Grommet	PG 17	Cylinder Head Gasket
DB 105	Exhaust Stud (2 used)	PG 19	Cylinder Base Gasket
F 19	Wrist Pin Retainer (2 used)	PG 20	Cylinder Block Assembly
F 29	Spark Plug and Gasket	PT 5	Cylinder Head Stud
HA 3	Crankshaft	PT 14	Wrist Pin
HA 12-1	Crankcase Assembly	PT 289	Needle Bearing
HA 21	Exhaust Body	RHM 1024 x 7/8	Oiler Body Screws (4 used)
HA 23	Cylinder Head	SAEW 4	Cylinder Head Washer
HA 62	Inner Shroud	SB 7	Drive End Seal
HA 71	Front Handle	SB 191	Cylinder Head Stud
HA 104	Swivel Stud (4 used)	SLW 4	Exhaust Washer (2 used)
HA 215-1	Oil Pump Body Complete	SLW 4	1/4 inch Lock Washer (2 used)
HA 216	Plunger Rod		
HA 218	Oiler Knob		
HA 314	Oiler Gasket		
HA 349	Starter Plate		
HA 363	Clutch Cover		

# MODEL HA

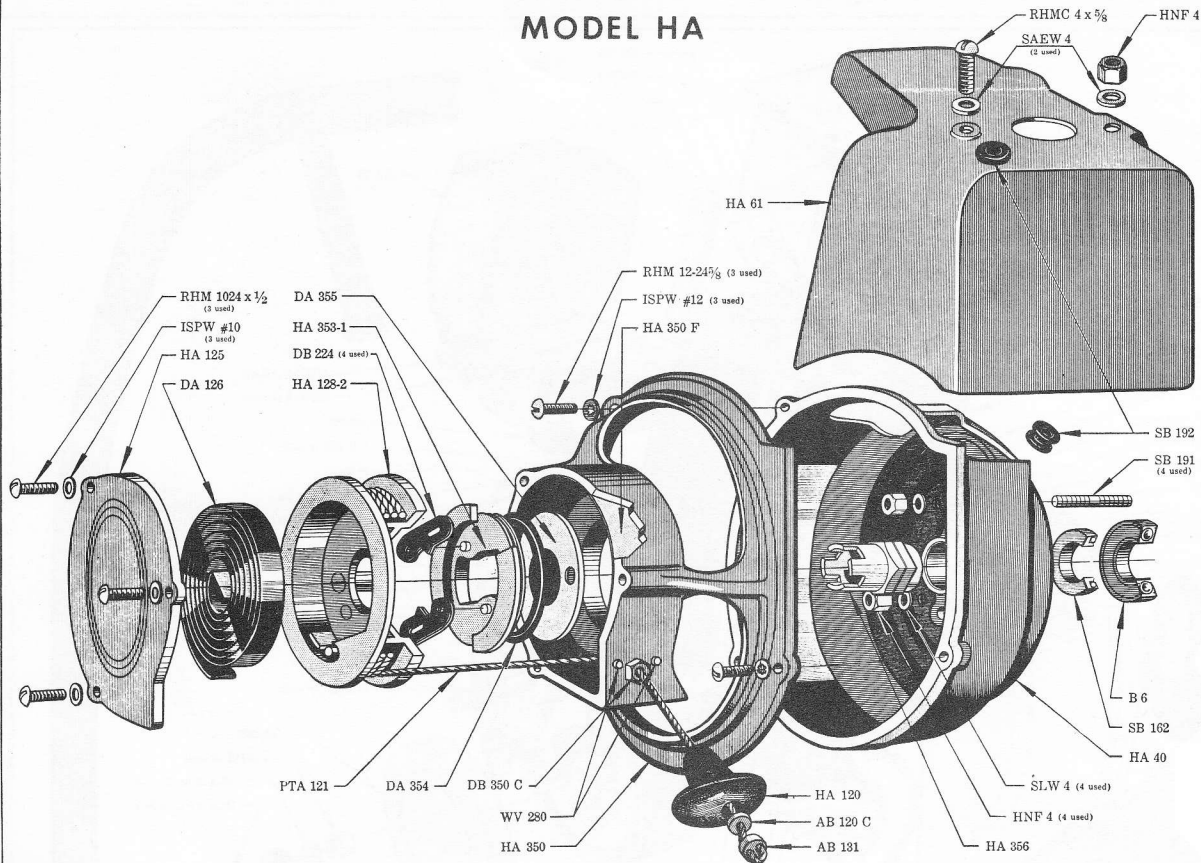

## STARTER ASSEMBLY

PART NO.	PART NAME
AB 120-C	Starter Rope Washer
AB 131	Starter Rope Anchor
B 6	Crankshaft Bearing (2 used)
DA 126	Starter Spring
DA 354	Slip Plate Ring
DA 355	Starter End Plate
DB 224	Starter Pawl (4 used)
DB 350-C	Starter Rope Bushing
HA 40	Fan Housing
HA 61	Outer Shroud
HA 120	Starter Handle
HA 125	Starter Cover
HA 128-2	Starter Pulley Complete with Pins
HA 350	Starter Housing Unit
HA 350-F	Starter Liner
HA 353-1	Starter Slip Plate and Pin Assembly
HA 356	Driver Nut
HNF 4	Shroud Nut
HNF 4	Fan Housing Nut (4 used)
ISPW	
No. 10	Starter Cover Washer (3 used)
ISPW	
No. 12	Starter Housing Washer (3 used)
PTA 121	Starter Rope Assembly
RHMC	
4 x 5/8	Shroud Screw
RHM	
1024 x 1/2	Starter Cover Screw (3 used)
RHM	
1224 x 5/8	Starter Housing Screw (3 used)

PART NO.	PART NAME
SAEW 4	Shroud Washer (2 used)
SB 162	Magneto End Seal
SB 191	Fan Housing Studs (4 used)
SB 192	Ignition Wire Grommet
SLW 4	1/4 inch Lock Washer (4 used)
WV 280	Rivet (3 used)

## OIL PUMP ASSEMBLY

PART NO.	PART NAME
HA 215-1	Oil Pump Assembly Complete
AB 217	Plunger
AB 221	Plunger Grommet
DA 179	Oiler Intake Connector
DA 215-B	Oiler Gland
DC 213	Washer
HA 158	Oiler Pump Barrel
HA 215	Oiler Body
HA 215-A	Oiler Body Unit
HA 216	Plunger Rod
HA 218	Oiler Knob
HA 222	Internal Spring
HA 223	External Spring
HA 309	Flexible Suction Line
HNC	
No. 10	Knob Lock Nut
PD 310	Suction Head
WV 102	Check Valve

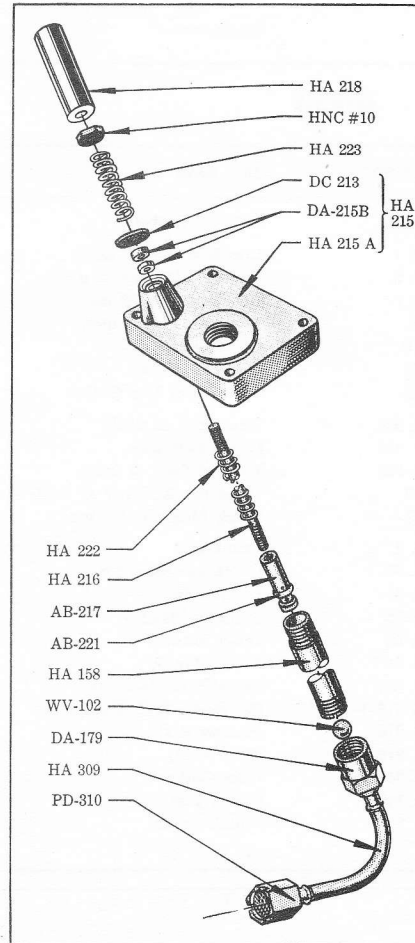

# MODEL HA

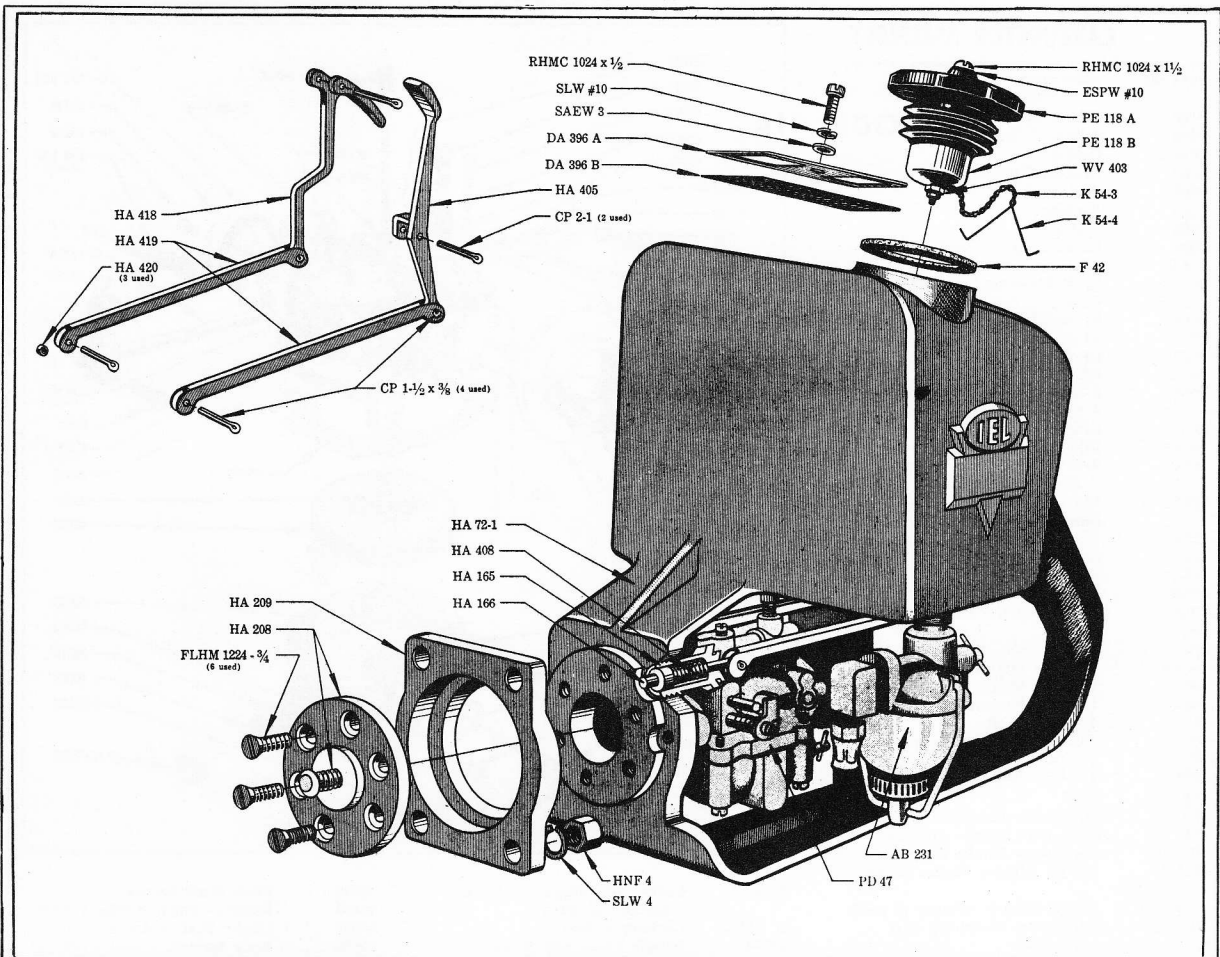

## REAR HANDLE ASSEMBLY

## CLUTCH ASSEMBLY

PART NO.	PART NAME
AB 231	Fuel Filter
AB 232	Fuel Filter Adapter
CP 1-1/2 x 3/8	Control Link Cotter Pins (4 used)
CP 2-1	Control Hinge Pin
DA 396-A	Air Cleaner Plate
DA 396-B	Air Cleaner Screen
ESPW No. 10	Filler Cap Washer
F 42	Filler Cap Gasket
FLHM 1224-3/4	Valve Plate Screw (6 used)
HA 72-1	Rear Handle Complete with Carb. Studs
HA 165	Swivel Lock Body
HA 166	Swivel Lock Pin
HA 208	Reed Valve Unit
HA 209	Swivel Ring
HA 405	Swivel Lever
HA 408	Swivel Lock Spring
HA 418	Throttle Trigger
HA 419	Control Link (2 used)
K-54-3	Filler Cap Chain
PD 47	Carburetor
PE 118-A	Filler Cap Only
PE 118-B	Vent Cup
PEA 118	Filler Cap Assembly
PT 49	Male Elbow
RHMC 1024 x 1/2	Air Cleaner Screw
RHMC 1024 x 1 1/2	Screw
SAEW 3	Air Cleaner Washer
SLW No. 10	Air Cleaner Lock Washer
WV 90-9 1/4	Fuel Line
WV 403	Filler Cap Nut

PART NO.	PART NAME
DA 331	Washer (2 used)
DA 332	Strut Nut (2 used)
DB 331	Strut Washer (2 used)
FLHM 1224-1 1/4	Screws
HA 3	Crankshaft Drive End
HA 85	Oil Wick
HA 87	Sprocket
HA 337	Chain Adjuster Pin
HA 339-1	Strut Assembly
HA 362	Clutch Driving Key

PART NO.	PART NAME
HA 365	Clutch Driver
HA 366	Clutch Driver Pin (3 used)
HA 367	Clutch Shoe Assembly (3 used)
HA 369	Clutch Spring (3 used)
HA 378	Clutch Drum
HA 381	Guide Plate
HA 384	Inside Sprocket Washer
SLW 5	Strut Lock Washer (2 used)
WV 29	Sprocket Bearing
WV 135	Clutch Driver Clip (3 used)
WV 263	Rivet (6 used)
WV 407	Clutch Driver Nut.

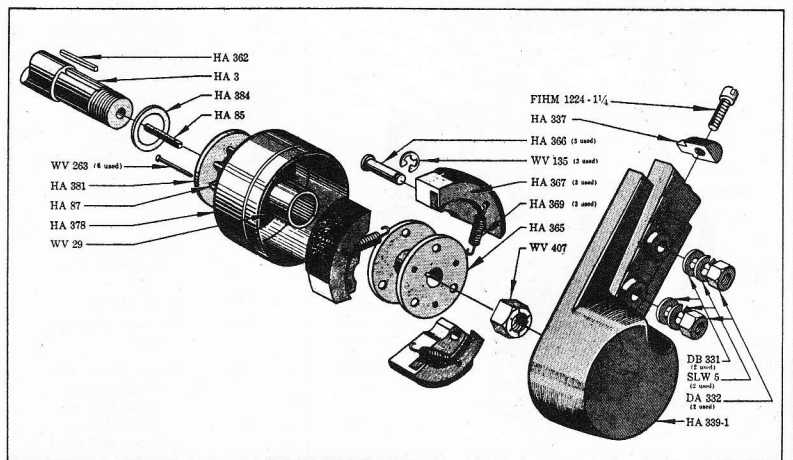

# CARBURETOR ASSEMBLY

PART NO.	PART NAME
0120	6-32 x $\frac{3}{16}$ Screw
0240	8-32 x $\frac{1}{16}$ Screw
0676	Gasket
0702	Packing Gland
0703	Packing Nut
0705	Packing
0788	Spring
0992	Lockwasher
01830	Throttle Lever
02395	$\frac{1}{4}$ -32 Headless Plug Screw
02510	Gasket
02531	$\frac{3}{4}$ Welch Plug
03311	10-32 Headless Plug Screw
03739	Choke Shutter
03860	Choke Friction Plunger Spring
05095	8-32 x $\frac{9}{16}$ Fill. Hd. Screw
05204	4-36 x $\frac{1}{8}$ Rd. Hd. Screw
05454	Choke Friction Plunger
05725	Idle Adj. Screw Spring
06062	8-32 x 1" Screw & Lockwasher (4 used)
06910	Idle Adj. Screw
07804	Float Assembly
07896	$\frac{1}{4}$ -20 Plug Screw
07900	Gasket
07901	Float Pinion Pin
07903	Float Bowl Gasket
07912	Choke Friction Plug Screw
08179	Nozzle
08515	Bypass Tube Assembly
08598	Throttle Stop Lever
08646	Throttle Shutter
08647	Throttle Return Spring
09518	Throttle Shaft
09519	Throttle shaft and lever
09678	Throttle Shaft Clip
09901	Throttle Stop Lever Pin
DB 105	Stud
PD 47	Carburetor Complete
PT 391	Carburetor Intake Adapter
HA 392	Carburetor Intake Grommet
RHM 832- $\frac{3}{8}$	Intake Adapter Screws (2 used)
SLW No. 8	Intake Adapter Washer (2 used)
HNF 4	Carburetor Mounting Nut (2 used)

## MODEL HA

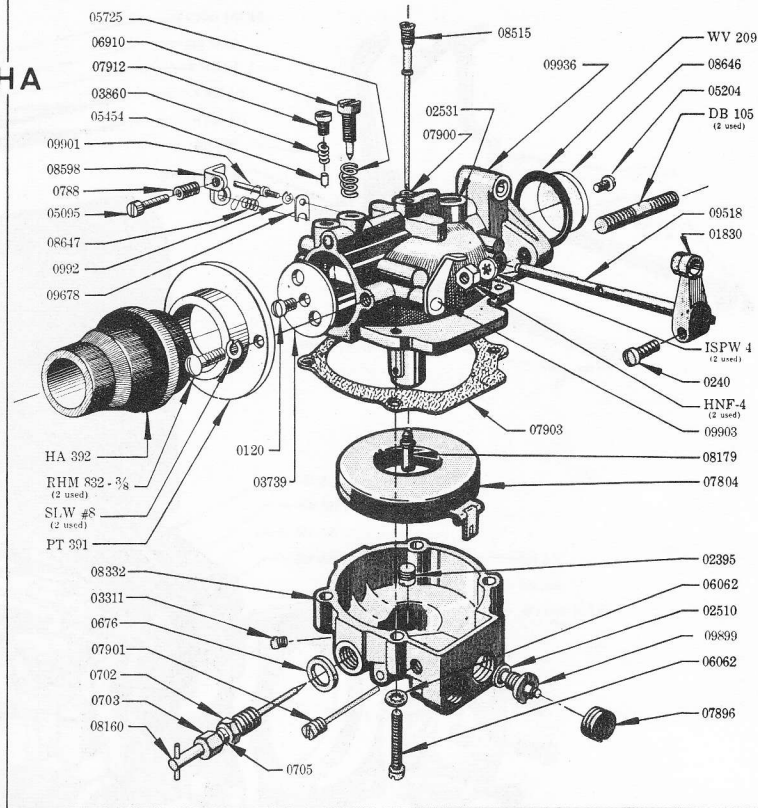

ISPW 4	Carburetor Mounting Lock-washer (2 used)	08332	Float Bowl Service
W V209	Carburetor Seal	09899	Matched Inlet Needle & Seat
08160	Needle Valve Adj. Screw (complete)	09903	Choke Shaft & Lever
		09936	Body Service

## IGNITION

PART NO.	PART NAME
B 34	Spark Plug Cover
DB 25-G	Rotary Screen
ESPW No. 10	Mag. Stator Washer (2 used)
HA 3	Crankshaft Mag. End
HA 25-B	Flywheel Unit

PART NO.	PART NAME
HA 25-C	Magneto Cam (Wico Y-7513)
HA 25-D	Ignition Wire
PD 27	Ignition Stop Switch
PD 189	Magneto Cam Key
PT 187	Key
RHM 1224 x $\frac{1}{2}$	Mag. Stator Screw (2 used)
SB 25-A	Mag. Stator Complete
WV 280	Rivet (3 used)
2965	Fixed Contact Clamp Screw Washer
3219	Breaker Arm Pivot Washer
4210	Breaker Arm Lock (1 used)
6318	Cam Wiper Felt
7533	Condenser Screw (1 used)
7533	Fixed Contact Clamp Screw (1 used)
7533	Condenser Connection Screw (1 used)
8807	Condenser Breaker Point Spacer Washer
10407	Condenser Breaker Point Spacer Washer
X 7536	Coil Group
X 7544	Breaker Contact Set
X 7682	Stator Plate Replacement Assembly (includes Stator Plate and Coil Core)

## FUEL FILTER

PART NO.	PART NAME
AB 231	Fuel Filter Complete
AB 232	Adapter with Screen
F 49	Street Elbow
PT 49	Male Elbow
WV 90- $\frac{9}{16}$	Fuel Line
0705	Main Adj. Screw Packing
07759	Strainer Bowl
07761	Strainer Gasket
07762	Strainer Screen
07765	Cup and Thumb Nut
07769	Shutoff Valve and Packing Nut
07770	Strainer Cover
07772	Clamp Wire and Stud

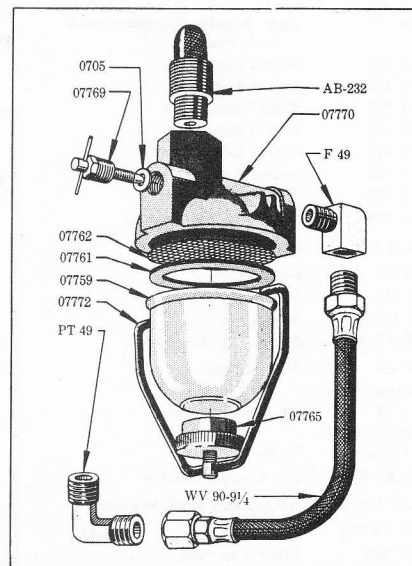



# MODEL HB

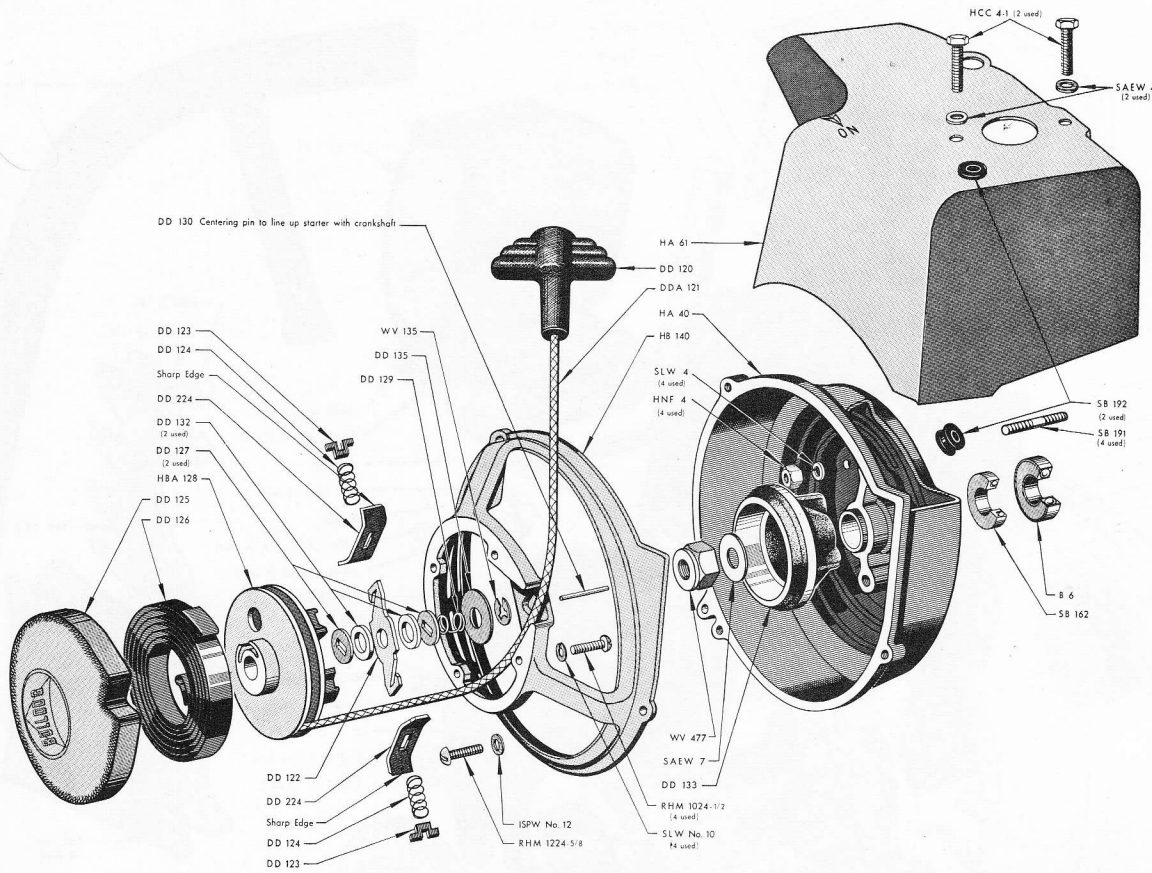

## STARTER ASSEMBLY

PART NO.	PART NAME
B-6	Crankshaft Bearing (2 used)
DD-120	Handle Assembly
DD-121	Starter Rope Assembly
DD-122	Brake Lever
DD-123	Spring Retainer PL
DD-124	Brake Lever Spring
DD-125	Starter Cover
DD-126	Rewind Spring
DD-127	Brake Washer
DD-128	Rotor Assembly
DD-129	Brake Spring
DD-130	Centering Pin
DD-132	Washer
DD-133	Starter Cup
DD-135	Brake Retainer Washer
DD-224	Friction Shoe Plate
DDA-224	Starter Pawl Assy. Complete
	Assy
	Consists of
	1—DD-122
	2—DD-123
	2—DD-124
	2—DD-224
HA-40	Fan Housing
HA-61	Outer Shroud
HB-140	Starter Adapter
HBA-125	Armstrong Starter Assembly
HCC 4-1	Cylinder Cap Screw (2)
HNF-4	Fan Housing Nut (4 used)
ISPW-	
No. 12	Washers (3 used)
ISPW-	
No. 12	Starter Housing Washer (4 used)
RHM-	
1024 1/2	Starter Screws
RHM-	
1224 3/8	Screws (3 used)

SAEW-4	Washer (2 used)
SAEW-7	Washer
SB-162	Magneto End Seal
SB-191	Stud
SB-192	Ignition Wire Grommet
SLW-4	1/4" Lock Washer (7 used)
SLW-No. 10	Starter Washers
WV-135	Clip Ring
WV-477	Flexloc Nut

## OIL PUMP ASSEMBLY

PART NO.	PART NAME
DA 215-B	Oiler Gland
HA 179	Oiler Intake Connector
HA 213	Washer
HA 214	Washer
HA 217	Plunger
HA 218	Oiler Knob
HA 219	Connecting Spring
HA 220	Check Valve Washer
HA 223	External Spring
HA 309	Flexible Suction Line
HB 215	Oiler Body
HB 215-A	Oiler Body Unit
HB-215-1	Oil Pump Assembly Complete
HB 158	Oiler Pump Barrel
HB 216	Plunger Rod
HNCNo. 10	Knob Lock Nut
PD 310	Suction Head
WV 102	Check Valve
WV 210	Plunger Grommet

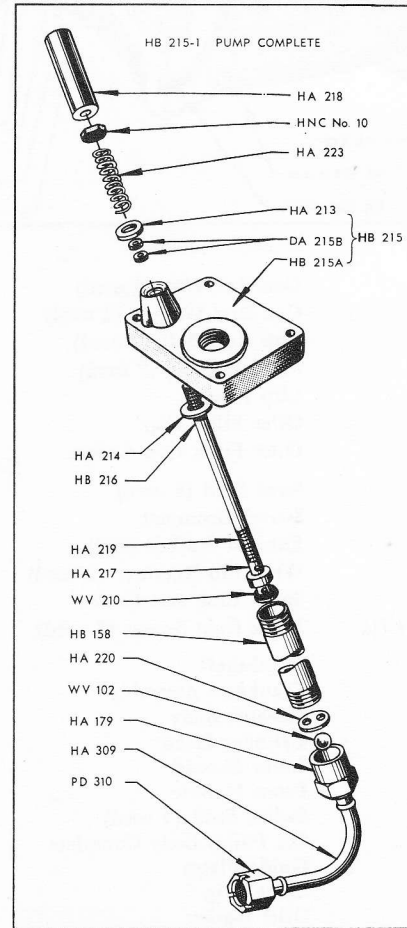

# MODEL HB

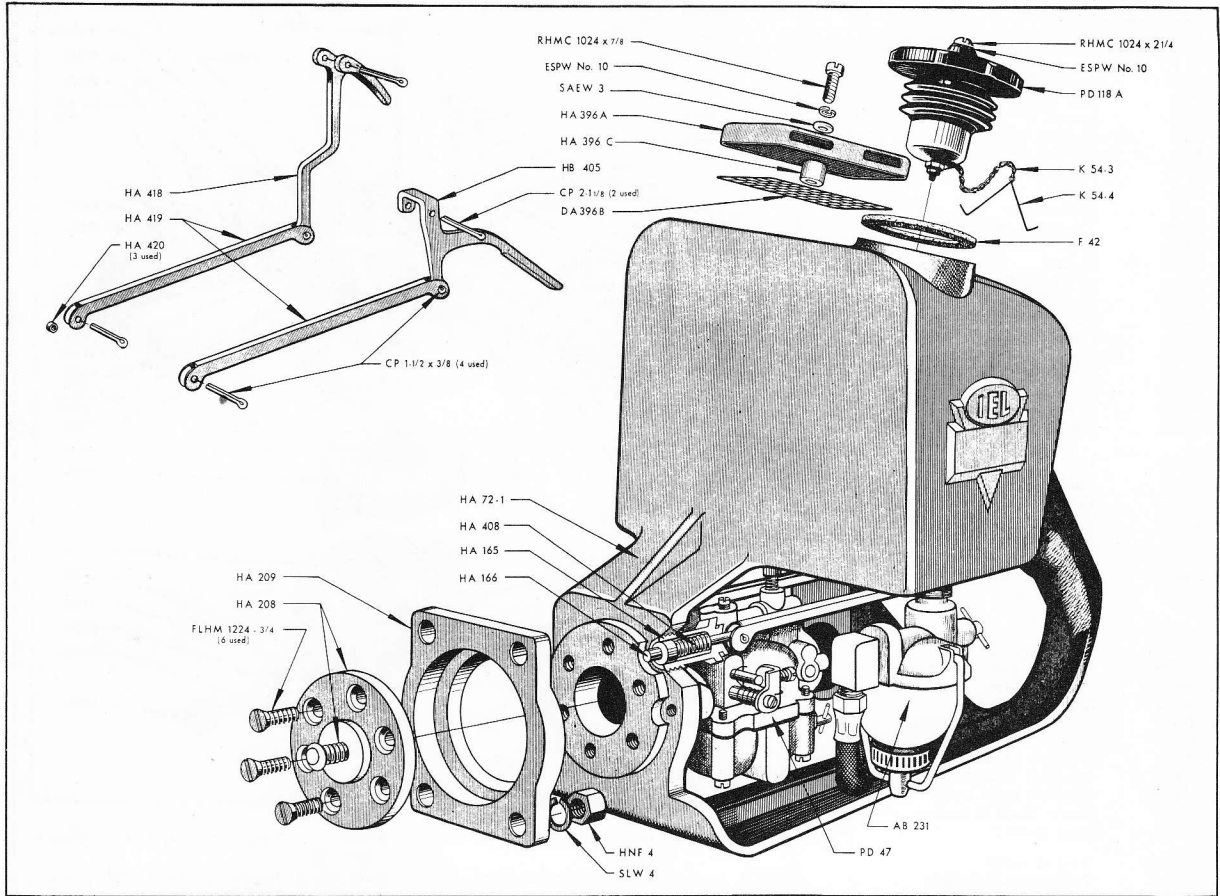

## REAR HANDLE ASSEMBLY

PART NO.	PART NAME
AB 231	Fuel Filter
AB 232	Fuel Filter Adapter
CP 1-1/2 x 3/8	Control Link Cotter Pins (4 used)
CP 2-1/8	Control Hinge Pin
DA 396-B	Air Cleaner Screen
ESPW No. 10	Filler Cap Washer
ESPW	Air Cleaner Lock Washer
F 42	Filler Cap Gasket
FLHM 1224-3/4	Valve Plate Screw (6 used)
HA 72-1	Rear Handle Complete with Carb. Studs
HA 165	Swivel Lock Body
HA 166	Swivel Lock Pin
HA 208	Reed Valve Unit
HA 209	Swivel Ring
HA 396-A	Air Cleaner Plate
HA 396-C	Spacer
HA 408	Swivel Lock Spring
HA 418	Throttle Trigger
HA 419	Control Link (2 used)
HA 420	Control Link Bushing
HB 405	Swivel Lever
K-54-3	Filler Cap Chain
K 54-4	Lock Spring
PD 47	Carburetor
PD 118-A	Filler Cap Only
PD 118	Filler Cap Assembly
RPMC 1024 x 7/8	Air Cleaner Screw
RPMC 1024 x 2 1/4	Screw
SAEW 3	Air Cleaner Washer

## CLUTCH ASSEMBLY

PART NO.	PART NAME
DA 332	Strut Nut (2 used)
DB 331	Strut Washer (2 used)
FLHM 1224-1 1/4	Screws (order as DA 336)
HA 3	Crankshaft Drive End
HA 85	Oil Wick
HA 337	Chain Adjuster Pin
HA 362	Clutch Driving Key
HA 365	Clutch Driver
HA 366	Clutch Driver Pin (3 used)

PART NO.	PART NAME
HA 367	Clutch Shoe Assembly (3 used)
HA 369	Clutch Spring (3 used)
HB 381	Guide Plate
HA 384	Inside Sprocket Washer
HB 87-S	Sprocket
HB 339-1	Strut Assembly
HB 378-S	Clutch Drum
WV 29	Sprocket Bearing
WV 135	Clutch Driver Clip (3 used)
WV 263	Rivet (7 used)
WV 407	Clutch Driver Nut.

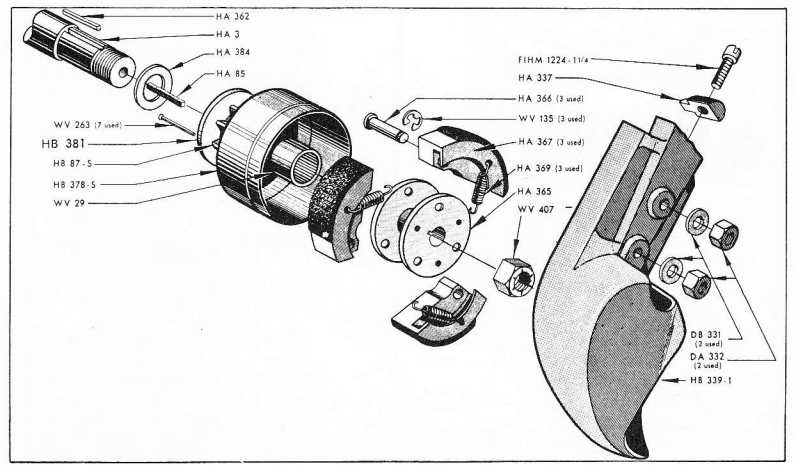

# CARBURETOR ASSEMBLY

# MODEL HB

PART NO.	PART NAME
0120	6-32 x $\frac{3}{16}$ Screw
0240	8-32 x $\frac{1}{16}$ Screw
0676	Gasket
0702	Packing Gland
0703	Packing Nut
0705	Packing
0788	Spring
0992	Lockwasher
01830	Throttle Lever
02395	$\frac{1}{4}$ -32 Headless Plug Screw
02510	Gasket
02531	$\frac{3}{8}$ Welch Plug
03311	10-32 Headless Plug Screw
03739	Choke Shutter
03860	Choke Friction Plunger Spring
05095	8-32 x $\frac{9}{16}$ Fill. Hd. Screw
05204	4-36 x $\frac{1}{4}$ Rd. Hd. Screw
05454	Choke Friction Plunger
05725	Idle Adj. Screw Spring
06062	8-32 x 1" Screw & Lockwasher (4 used)
06910	Idle Adj. Screw
07804	Float Assembly
07896	$\frac{1}{2}$ -20 Plug Screw
07900	Gasket
07901	Float Pinion Pin
07903	Float Bowl Gasket
07912	Choke Friction Plug Screw
08160	Needle Valve Adj. Screw (complete)
08179	Nozzle
08332	Float Bowl Service
08515	Bypass Tube Assembly
08598	Throttle Stop Lever
08646	Throttle Shutter
08647	Throttle Return Spring
09588	Throttle Shaft
09678	Throttle Shaft Clip
09899	Matched Inlet Needle & Seat
09901	Throttle Stop Lever Pin
09903	Choke Shaft & Lever
09936	Body Service
DB 105	Stud (2 used)
PD 47	Carburetor Complete (order as MD 55B)
HA 392	Carburetor Intake Grommet

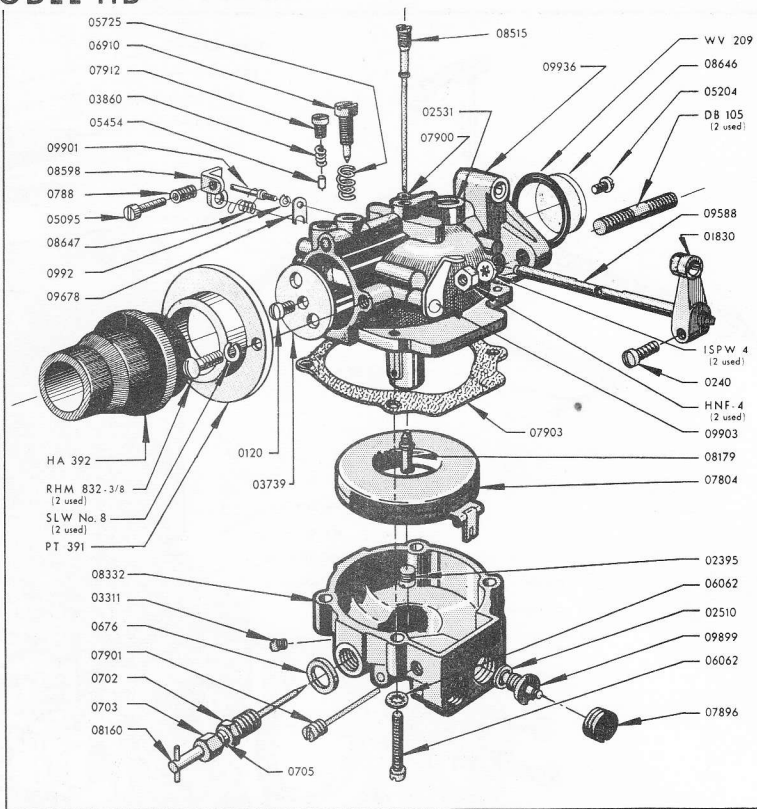

HNF 4	Carburetor Mounting Nut (2 used)	RHM 832- $\frac{3}{8}$ (2 used)	Intake Adapter Screws (2 used)
ISPW 4	Carburetor Mounting Lockwasher (2 used)	SLW No. 8 (2 used)	Intake Adapter Washer (2 used)
PT 391	Carburetor Intake Adapter	W V209	Carburetor Seal

## IGNITION

PART NO.	PART NAME
2965	Fixed Contact Clamp Screw Washer
3219	Breaker Arm Pivot Washer
4210	Breaker Arm Lock (1 used)
6318	Cam Wiper Felt
7533	Condenser Screw (1 used)
7533	Fixed Contact Clamp Screw (1 used)

PART NO.	PART NAME
8732	Primary Lead Screw
8807	Condenser
10407	Breaker Point Spacer Washer
ESPW No. 10	Mag. Stator Washer (2 used)
HA 3	Crankshaft Mag. End
HA 25-C	Magneto Cam (Wico Y-7513)
HA 25-D	Ignition Wire
HM 28	Flywheel Unit
HM 26	Rotary Screen
HM 27	Baffle
PD 27	Ignition Stop Switch
PD 189	Magneto Cam Key
PT 187	Key
RHM 1224 x $\frac{1}{2}$	Mag. Stator Screw (2 used)
SB 25-A	Mag. Stator Complete (X7682)
WV 250	Spark Plug Cover
X 7536	Coil Group
X 7544	Breaker Contact Set
X 7682	Stator Plate Replacement Assembly (includes Stator Plate and Coil Core) (SB 25-A)

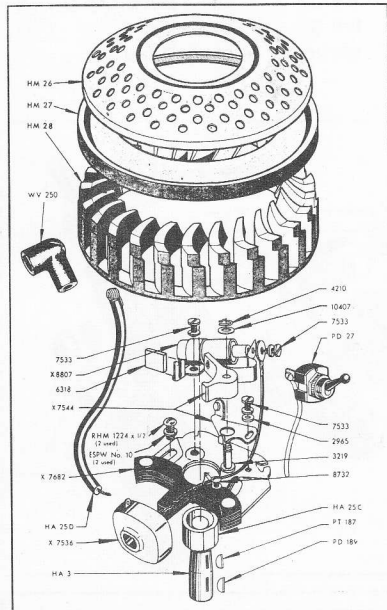

## FUEL FILTER

PART NO.	PART NAME
AB 231	Fuel Filter Complete
AB 232	Adapter with Screen
F 49	Street Elbow
PT 49	Male Elbow
WV 90-10	Fuel Line
0705	Main Adj. Screw Packing
07759	Strainer Bowl
07761	Strainer Gasket
07762	Strainer Screen
07765	Cup and Thumb Nut
07769	Shutoff Valve and Packing Nut
07770	Strainer Cover
07772	Clamp Wire and Stud

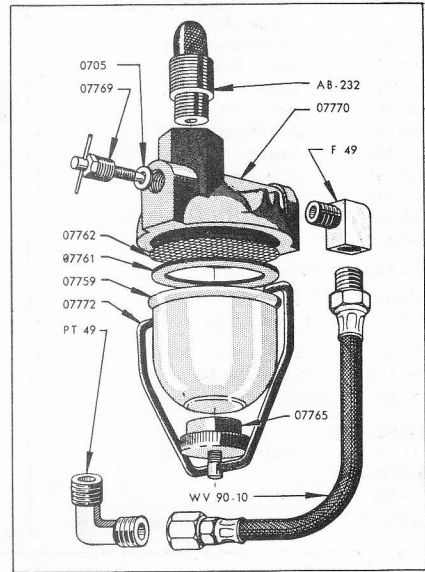



# MODEL HM

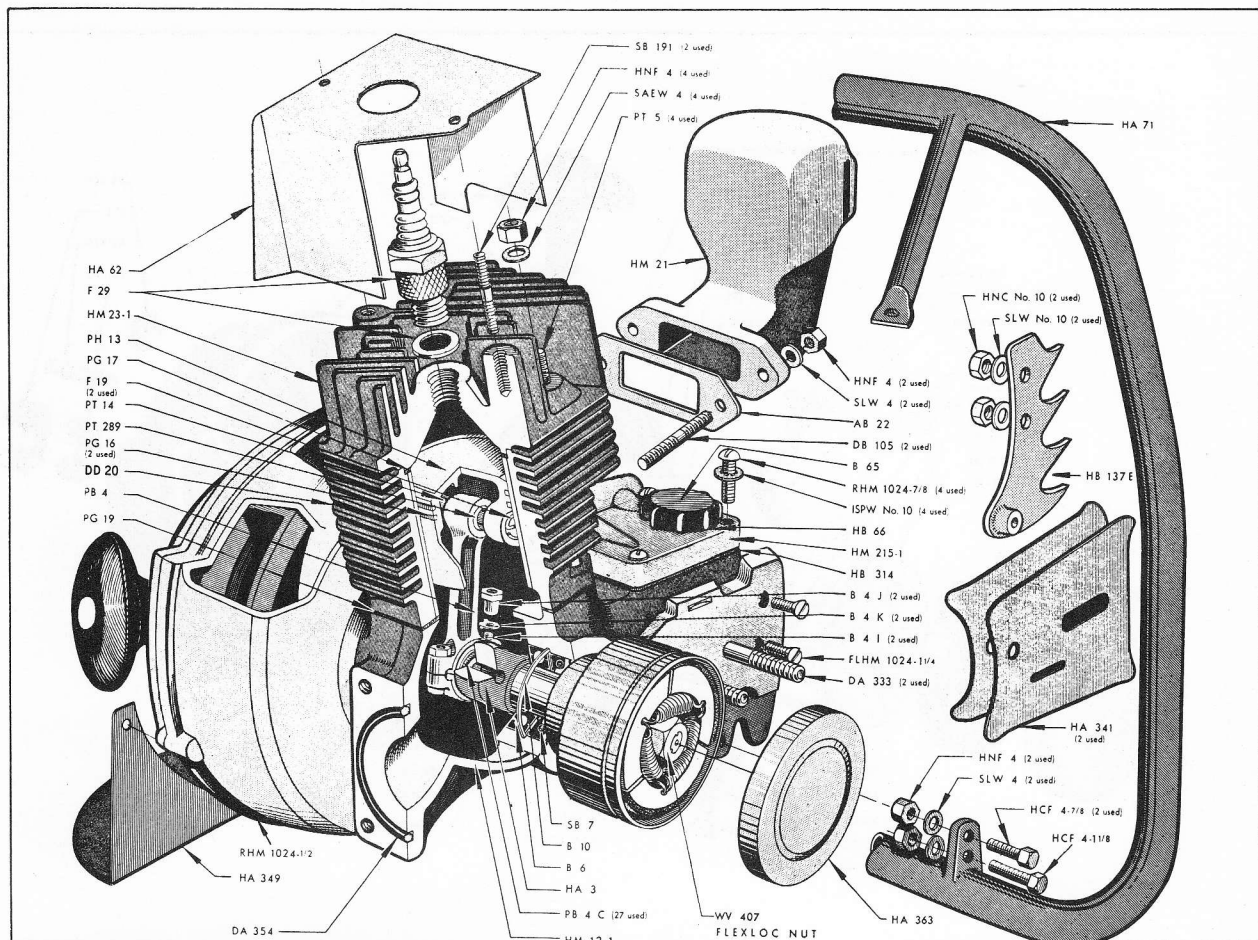

## ENGINE

- AB 22 Exhaust gasket
- B 4 J Con rod nut (2 used)
- B 4 K Con rod washer (2 used)
- B 4 I Con rod bolt (2 used)
- B 6 Main Bearing (2 used)
- B 10 Clip ring
- B 65 Oiler filler cap
- DA 333 Strut stud (2 used)
- DA 354 "O" ring
- DB 105 Exhaust stud (2 used)
- DD 20 Cylinder block assembly
- F 19 Wrist pin retainer (2 used)
- F 29 Spark plug and gasket
- FLHM 1024-11/4 Pivot grip screws (2 used)
- HA 3 Crankshaft
- HA 62 Inner Shroud
- HA 71 Front Handle
- HA 341 Guide Plates
- HA 349 Starter plate
- HA 363 Clutch cover
- HB 66 Oiler filler cap gasket
- HB 137 E Pivot grip
- HB 314 Oiler gasket
- HCF 4x7/8 Front handle bolts (2 used)
- HCF 4x11/8 Pivot grip bolt
- HM 12-1 Crankcase assembly
- HM 21 Muffler
- HM 23-1 Cylinder head with studs
- HM 215-1 Oil pump body complete
- HNF 4 Cylinder head nut
- HNF 4 Exhaust nut (2 used)
- HNF 4 1/4" nuts (3 used)
- HNC No. 10 Pivot grip nuts (2 used)
- ISPW No. 10 Lock washer (4 used)
- PB 4 Con rod
- PB 4C Loose needles (27 used)
- PG 16 Piston rings (2 used)
- PG 17 Cylinder head gasket
- PG 19 Cylinder base gasket

- PT 5 Piston
- PT 5 Cylinder head stud
- PT 14 Wrist pin
- PT 289 Needle bearing
- RHM 1024x7/8 Oiler body screws (4 used)
- RHM 1024-1/2 Starter plate screws bottom position (2)
- SAEW 4 Cylinder head washer
- SB 7 Drive end seal
- SB 191 Studs
- SLW No. 10 No. 10 lock washer
- SLW 4 1/4" lock washers (6 used)
- WV 407 Flexloc nut

## CLUTCH ASSEMBLY

- DA 332 Strut nut (2 used)
- DA 336 Adjusting screw
- DB 331 Strut washer (2 used)
- HA 3 Crankshaft
- HA 337 Chain adjuster pin
- HA 362 Clutch driving key
- HA 365 Clutch driver
- HA 366 Clutch driver pin (3 used)
- HA 367 Clutch shoe assembly (3 used)
- HA 369 Clutch spring (3 used)
- HA 384 Inside sprocket washer
- HB 339-1 Strut assembly including adjusting pin and screw
- HM 87-1 Sprocket and drum assembly including bearing
- WV 29 Sprocket bearing
- WV 135 Clutch driver clip (3 used)
- WV 407 Clutch driver nut

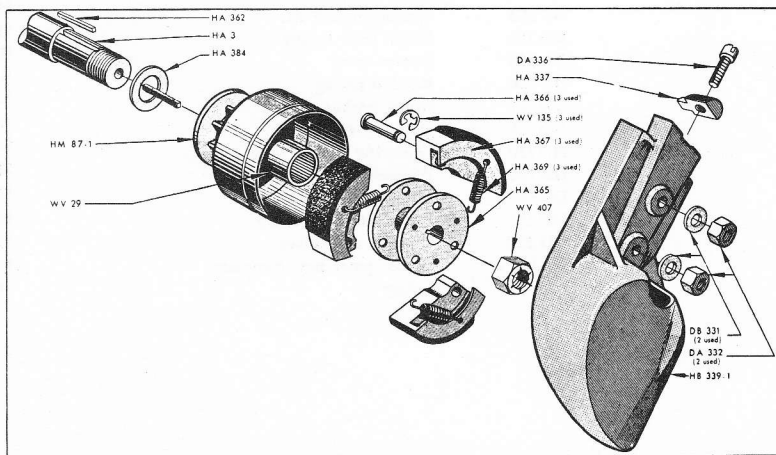

# MODEL HM

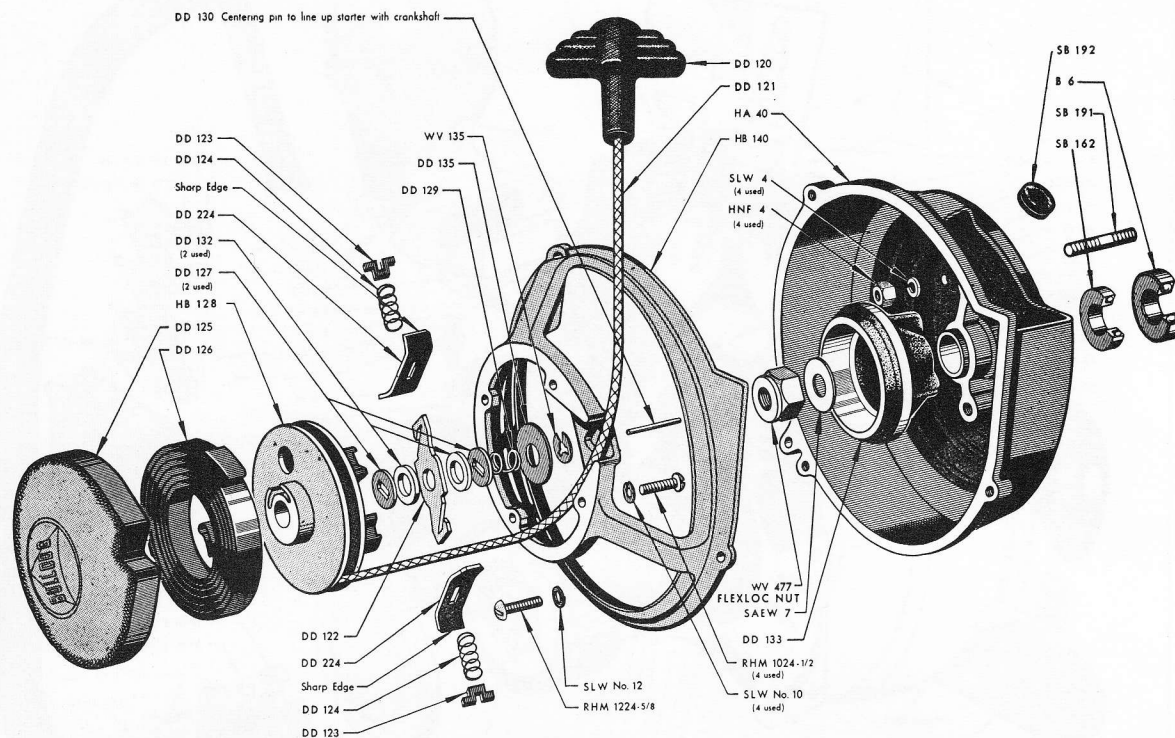

## STARTER ASSEMBLY

Part No.	Part Name
B 6	Crankshaft bearing (2 used)
DD 120	Handle assembly
DD 121	Starter rope assembly
DD 122	Brake lever
DD 123	Spring retainer PL
DD 124	Brake lever spring
DD 125	Starter cover
DD 126	Rewind spring
DD 127	Brake washer
DD 129	Brake spring
DD 130	Centering pin
DD 132	Washer
DD 133	Starter cup
DD 135	Brake retainer washer
DD 224	Friction shoe plate
DDA 224	Starter pawl assy. complete Assy

Part No.	Part Name
HA 40	Fan housing
HB 128	Rotor assembly
HB 140	Starter adapter
HBA 125	Armstrong starter assembly
HNF 4	Fan housing nut (4 used)
RHM 1024 1/2	Starter screws
RHM 1224 5/8	Screws (3 used)
SAEW 7	Washer
SB 162	Magneto end seal
SB 191	Stud (4)
SB 192	Ignition wire grommet
SLW 4	1/4" lock washer (7 used)
SLW No. 10	Starter washers
SLW No. 12	Washers
WV 135	Clip ring
WV 477	Flexloc-nut

Consists of

- 1 DD 122
- 2 DD 123
- 2 DD 124
- 2 DD 224

# MODEL HM

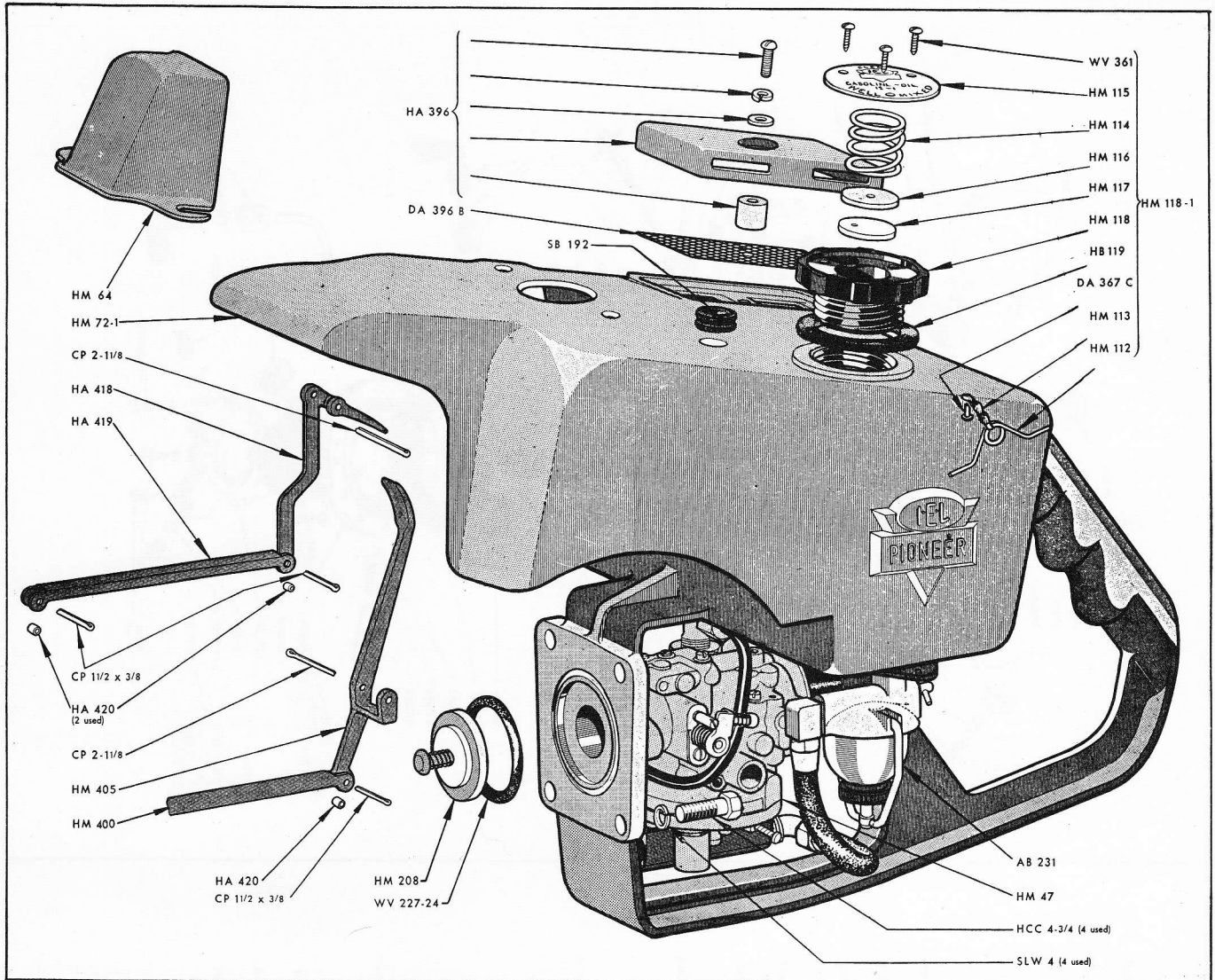

## REAR HANDLE ASSEMBLY

<i>Part No.</i>	<i>Part Name</i>	<i>Part No.</i>	<i>Part Name</i>
AB 231	Fuel filter	HM 112	Gas cap lock spring
CP 1½x¾	Control link cotter pins (4 used)	HM 113	Gas cap chain
CP 2-1½	Control hinge pin	HM 114	Gas cap spring
DA 367C	Rivet	HM 115	Gas cap cover plate
DA 396B	Air cleaner screen	HM 116	Gas cap valve plate
HA 396	Air cleaner assembly	HM 117	Gas cap valve
HA 418	Throttle trigger	HM 118	Gas cap
HA 419	Control link (2 used)	HM 118-1	Gas cap unit
HA 420	Control link bushing (2 used)	HM 208	Reed valve unit
HB 119	Gas cap gasket	HM 400	Connecting link
HCC4-¾	Connector studs (4 used)	HM 405	Oiler lever
HM 47	Carburetor	SB 192	Ignition wire grommet
HM 64	Spark plug guard	SLW 4	Lock washers
HM 72-1	Rear handle complete with carb. studs	WV 227-24	"O" ring—reed valve
		WV-361	Gas cap screws (3)



## MAGNETO

Part No.	Part Name
2965	Fixed contact clamp screw washer
3219	Breaker arm pivot washer
4210	Breaker arm lock (1 used)
6318	Cam wiper felt
7533	Condenser screw (1 used)
7533	Fixed contact clamp screw (1 used)
8732	Primary lead screw

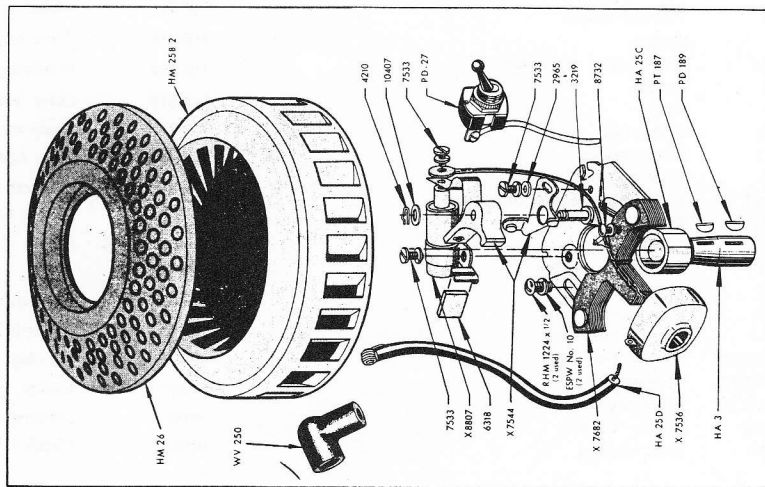

Part No.	Part Name
8807	Condenser
10407	Breaker point spacer washer
ESPW No. 10	Mag. stator washer (2 used)
HA 3	Crankshaft
HA 25-C	Magneto cam (Wico Y-7513)
HA 25-D	Ignition wire
HM 25B-2	Flywheel unit. Ask for HM 28.
HM 26	Rotary air screen
PD 27	Ignition stop switch
PD 189	Magneto cam key
PT 187	Flywheel key
RHM 1224x1/2	Mag. stator screw (2 used)
SB 25A	Complete magneto and stator plate unit including coil, condenser, points, etc.
WV 250	Spark plug insulating cap
X 7536	Coil group
X 7544	Breaker contact set
X 7682	Stator plate replacement assembly (includes stator plate and coil core only)

## FUEL FILTER

Part No.	Part Name
AB 231	Fuel filter complete
ESPW No. 10	Washers
F 49	Street elbow
HM 177	Flex. pickup connector
HM 233	Fuel filter holder
HM 234	Fuel filter gasket
HM 310-1	Pickup head unit
PT 49	Male elbow
RHM 1024-3/8	Holder screws (3)
WV 90-5	Fuel line
WV 91-42	Flex. pickup line
0705	Main adj. screw packing
07759	Strainer bowl
07761	Strainer gasket
07762	Strainer screen
07765	Cup and thumb nut
07769	Shutoff valve and packing nut
07770	Strainer cover
07772	Clamp wire and stud

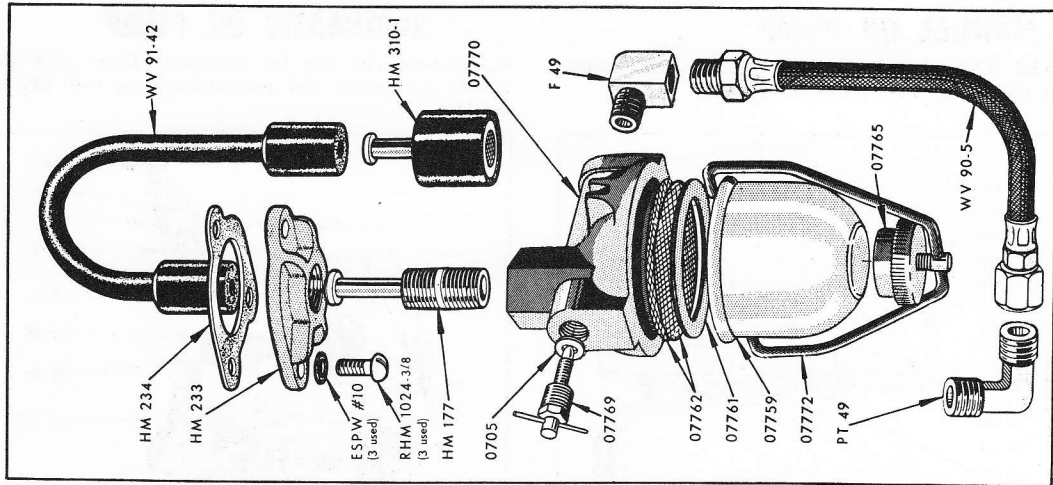

# MODEL HM

## MANUAL OIL PUMP

All Model HM saws come equipped from the factory with an all-weather manual type oil pump.

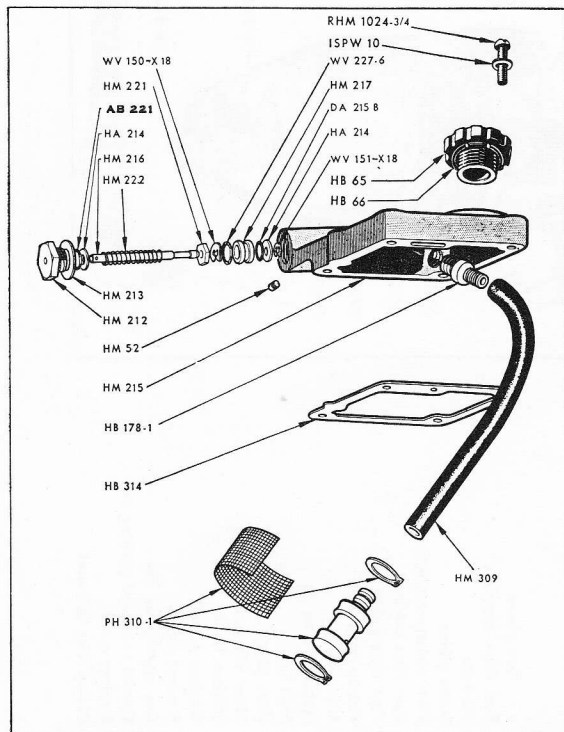

Part No.	Part Name
B 65	Oil filler cap
DA 215B	Gland "O" ring
HA 214	Gland washer
HA 214	Plunger washer
HB 66	Gasket
HB 178-1	Oiler intake connector
HB 314	Gasket
HM 52	Plug
HM 212	Gland nut
HM 213	Gland gasket
HM 215	Oiler body
HM 215-1	Oil pump assembly complete
HM 216	Plunger rod
HM 217	Piston
HM 221	Plunger guide clip
HM 222	Plunger spring
HM 309	Flex. suction line
PH 310-1	Suction head unit
RHM 1024-3/4	Screws (4 used)
WV 150-X18	Plunger clip
WV 151-X18	Plunger guide clip
WV 227-6	Piston "O" ring
ISPW 10	Lock washers

## AUTOMATIC OIL PUMP

Conversion kits can be purchased from your dealer, should you prefer this automatic pump with adjustable oil feed.

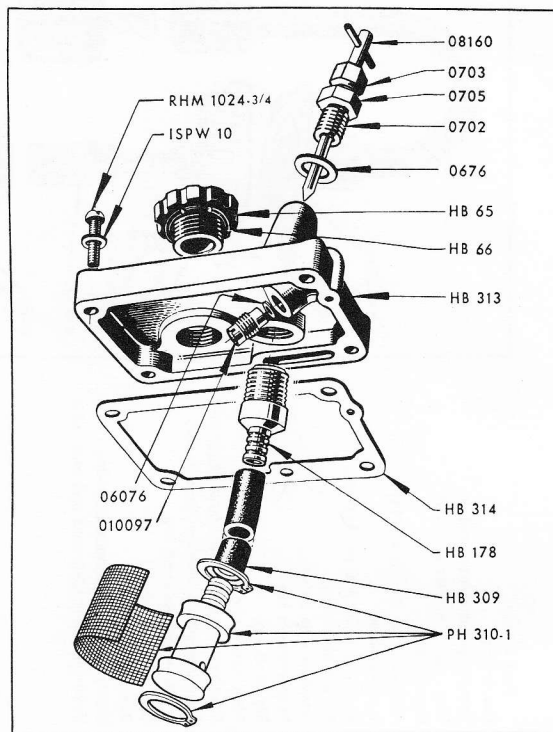

Part No.	Part Name
HB 48	Pressure control valve assembly with gasket
HB 65	Oiler filler cap
HB 66	Gasket
HB 178	Tube connector
HB 309	Flexible tube
HB 313	Oiler body
HB 313-1	Complete assembly
HB 314	Oiler body gasket
ISPW No. 10	Washers (4 used)
PH 310-1	Pickup head
RHM 1024-3/4	Screws (4 used)
0676	Gasket
0702	Adjusting screw gland
0703	Adjusting screw nut
0705	Packing
06076	Gasket
08160	Pressure adjusting screw
010097	Check valve unit

# MODEL HC

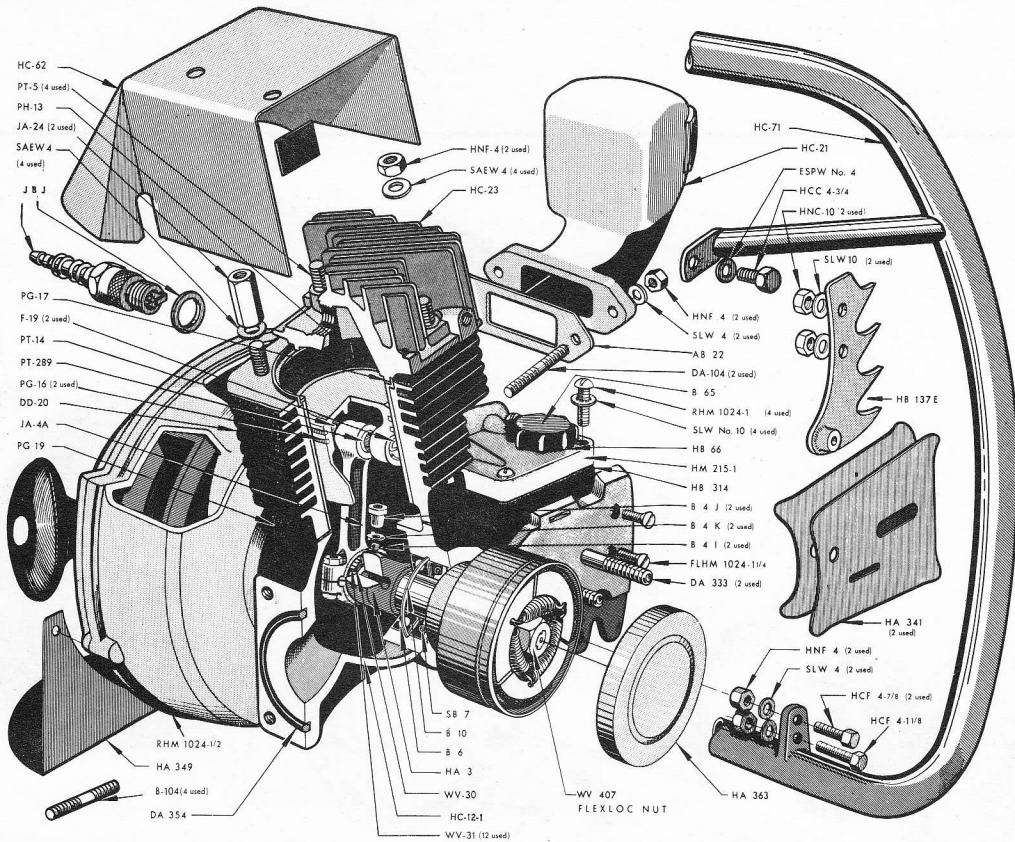

## ENGINE

Part No.	Part Name
AB 22	Exhaust gasket
B 4J	Con rod nut (2)
B 4K	Con rod washer (2)
B 4I	Con rod bolt (2)
B 6	Main bearing (2)
B 10	Clip ring
B 65	Oil filler cap
B 104	Rear handle stud
DA 333	Strut stud (2)
DA 354	"O" ring
DA 104	Exhaust stud (2)
F 19	Wrist pin retainer (2)
J8J	Spark plug and gasket
FLHM 1024-1	1/4 pivot grip screws (2)
HA 3	Crankshaft
HC 62	Inner shroud
★ HC 71	Front handle
HA 341	Guide plates (2)
★ HA 349	Starter plate
HA 363	Clutch cover
HB 66	Oiler filler cap gasket
HB 137	Pivot grip
HB 314	Oiler gasket
HCF 4x7/8	Front handle bolts (2)
HCF 4x1 1/8	Pivot grip bolt
HC 12-1	Crankcase assembly
HC 21	Muffler
HC 23	Cylinder head
HM 215	Oil pump body
HNF 4	Cylinder head nuts (4)
HNF 4	Exhaust nut (2)
HNF 4	Nuts (2)
HNC No. 10	Pivot grip nuts
SLW No. 10	Lock washer (4)

★ See Light Weight Modifications

JA 4	Con rod
JA 24	Long nut
PG 16	Piston rings (2)
PG 17	Cylinder head gasket
PG 19	Cylinder base gasket
PH 13	Piston
DD 20	Cylinder block assembly
PT 5	Cylinder stud (4)
PT 14	Wrist pin
PT 289	Needle bearing
RHM 1024x1	Oiler body screws (4)
RHM 1024-1/2	Starter plate screws (2)
SAEW 4	Cylinder head washer (4)
SB 7	Drive end seal
SLW No. 10	Lock washers (2)
SLW 4	Lock washers (4)
WV 407	Flexloc nut
WV 30	Needle case
WV 31	Loose needles (12)
HCC-4-3/8	Handle brace bolt

## CLUTCH ASSEMBLY

Part No.	Part Name
DA 332	Strut nut (2)
FIHM 12-24-1	1/4 adjusting screw
DB 331	Strut washer (2)
HA 3	Crankshaft
HA 337	Chain adjuster pin
PT 187	Clutch driving key
HA 365	Clutch driver
HA 366	Clutch drive pin (3)
HA 367	Clutch shoe assembly (3)
HA 369	Clutch spring (3)
HA 384	Inside sprocket washer
★ HB 339-1	Strut assembly
HM 87-1	Sprocket and drum assembly
WV 29	Sprocket bearing
WV 135	Clutch driver clip (3)
WV 407	Clutch driver nut

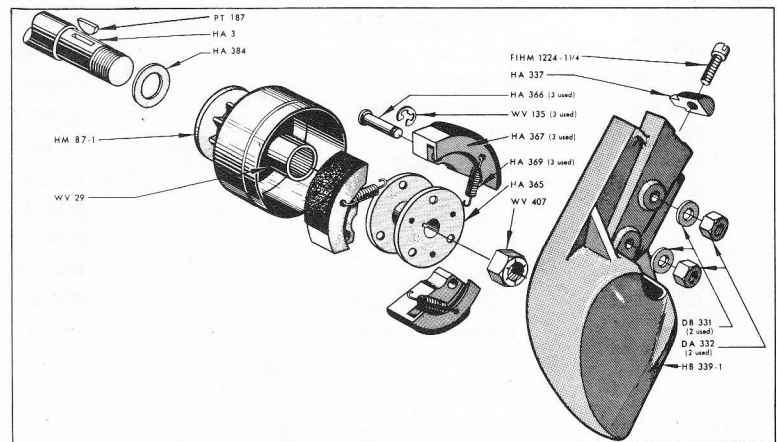

# MODEL HC

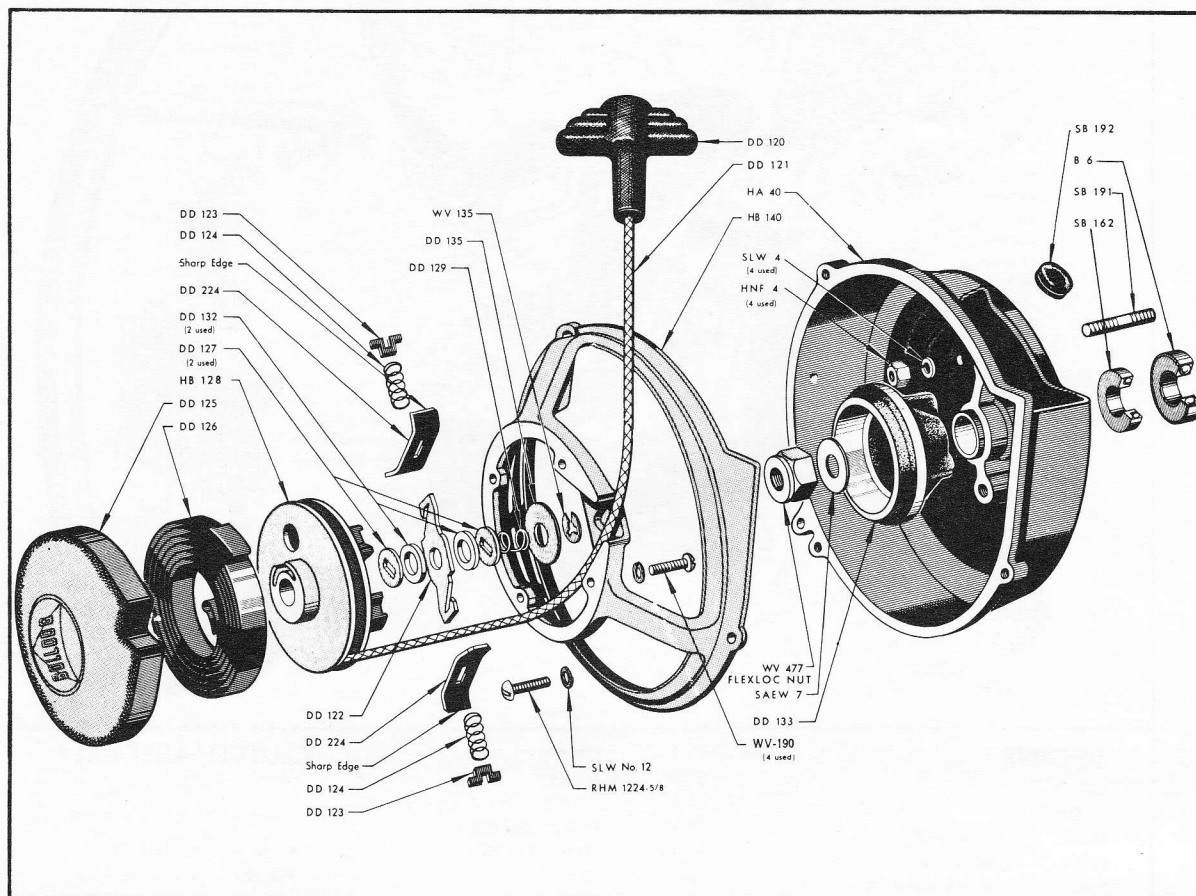

## STARTER ASSEMBLY

Part No.	Part Name	Part No.	Part Name
B 6	Crankshaft bearing (2)	DDA 224	Starter pawl assembly, consists of: (1 DD 122), (2 DD 123.), (2 DD 124) (2 DD 224)
DD 120	Handle assembly	HA 40	Fan housing
DD 121	Starter rope assembly	HB 128	Rotor assembly
DD 122	Brake lever	HB 140	Starter adapter
DD 123	Spring retainer	HBA 125	Armstrong starter assembly
DD 124	Brake lever spring	HNF 4	Fan housing nut (4)
DD 125	Starter cover	WV 190	Starter screw (4)
DD 126	Rewind spring	RHM-1224-5/8	Starter adapter screw
DD 127	Brake washer (2)	SAEW 7	Washer
DD 129	Brake spring	SB 162	Magneto end seal
DD 132	Washer	SB 192	Ignition wire grommet
DD 133	Starter cup	SLW 4	Lock washer (4)
DD 135	Brake retainer washer	SLW No. 12	Washers (3)
DD 224	Friction shoe plate	WV 135	Clip ring
		WV 477	Flexloc nut
		SB 191	Stud (4)



## REAR HANDLE ASSEMBLY

Part No.	Part Name
F 49	Street Elbow
WV 265	Split rivet (3)
★ HC-397S-2	Air cleaner assembly (includes 2 HM-394 grommet, and element)
HC 391	Throttle lever
HC 416	Throttle lever detail assembly
HC 418-1	Throttle trigger
HC 419	Control link (1)
HC 420	Throttle lever bushing (1)
HC 421	Trigger pivot
HM 119	Gas cap gasket
HC 72	Rear handle complete with carb. studs
HC 61-1	Shroud assembly
HC 64	Plug cover
RHMS 1024-3/4	Throttle lever screw
★ ★ HC-399	Air cleaner cup
HC-399	Cup retainer
HM 112	Gas cap lock spring
HM 113	Gas cap chain
HM 114	Gas cap spring
HM 115	Gas cap cover plate
HM 116	Gas cap valve plate
HM 117	Gas cap valve
HM 118	Gas cap
HM 118-1	Gas cap unit
HC 207	Reed valve gasket
HC 208	Reed valve unit
HC 400	Connecting link
HC 405	Oiler lever (2)
HC 407	Oiler push rod
SLW 4	Lock washers (4)
HNF 4	Nut (4)
WV 230-3	"O" Rings
WV 361	Gas cap screws (3)
HC 413	Oiler lever bushing
RHMS 10-24-3/4	Oiler lever screw
FLHM 1/4-28-7/8	Carb. screw (2)
HNF 4	Rear handle nut (4)
SLW 4	Lock washers (3)
WV 10	Name plate
HC 310-1	Pick-up head body
WV 91-42	Flex pick-up line
HC 176	Bushing
WV 421	Red fibre gasket
WV 60	Shut-off cock
WV 92-35	Fuel line
HC F-4-1	Outer shroud bolt
DA 104	Outer shroud stud
★	Sec Light Weight Modifications

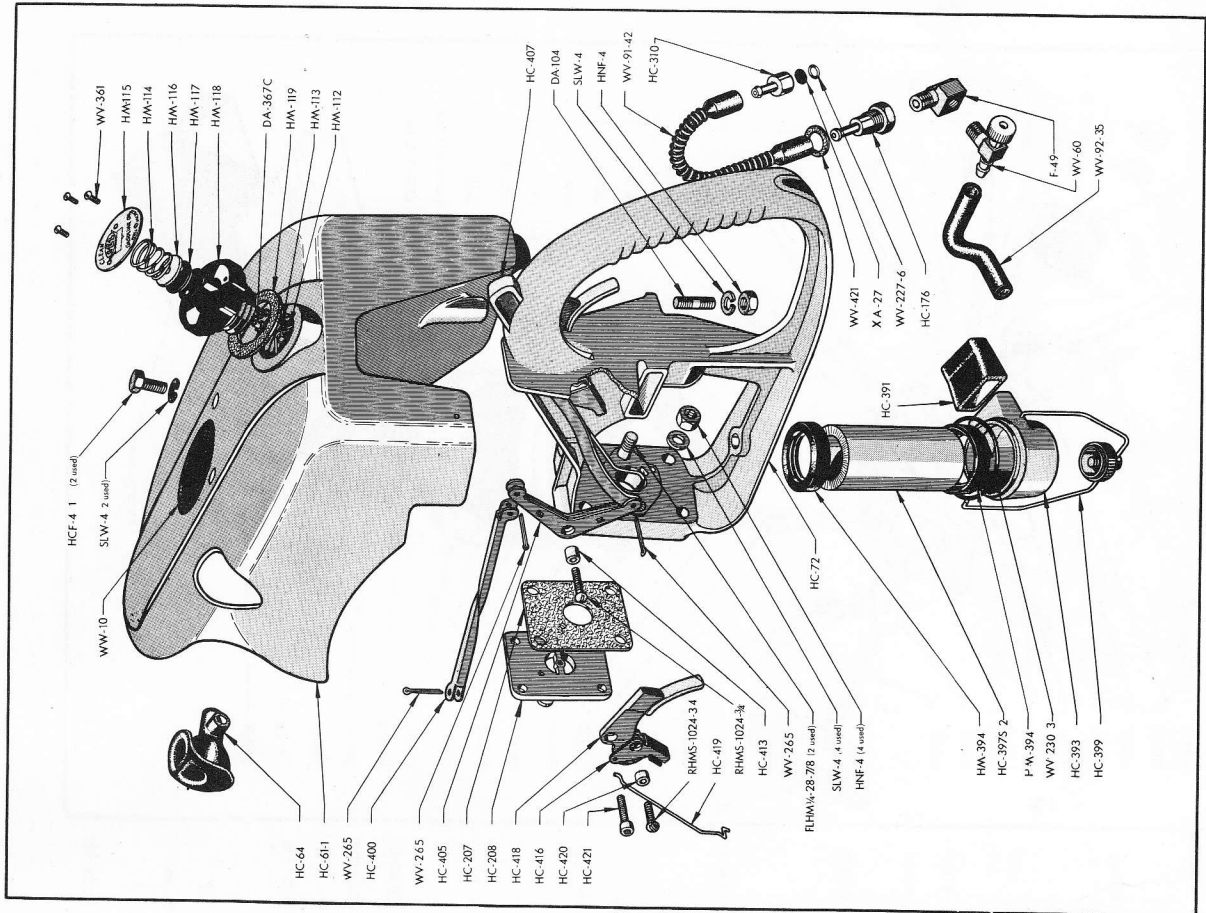

# MODEL HC

## CARBURETOR

Part No.	Part Name	Body
HC-47	Carburetor assembly	
HC-42	Carburetor gasket	
HC-392	Carburetor grommet	
HJF-4	Nut (2)	
ISPW-4	Washers	
010588	*Body channel cup plug	
02351	*Body channel weld plug	
010868	Choke shaft and lever	
09626	Choke shutter	
08942	Choke shutter screw	
05454	Choke friction pin	
08805	Choke friction pin spring	
02232	Diaphragm chamber drain screw	
010579	*Diaphragm	
010542	Diaphragm cover gasket	
010526	Diaphragm cover	
010880	Fuel pump gasket	
010531	*Fuel pump diaphragm	
010525	Fuel pump body	
010098	Fuel pump body screw and lockwasher (6)	
010530	*Fuel strainer screen	
010529	Fuel strainer cover gasket	
010527	Fuel strainer cover	
010889	Body	
010571	*Fuel strainer cover retaining screw	
010617	*Idle adjustment screw	
010589	Idle adjustment screw seal ring	
05095	Idle speed regulating screw	
0788	*Idle speed regulating screw spring	
010580	*Inlet needle, seat and gasket	
010165	Inlet seat gasket	
010513	Inlet control lever	
010581	*Inlet control lever pinion screw	
010578	*Inlet tension spring	
010570	*Main adjustment screw	
010589	Main adjustment screw seal ring	
010906	Throttle shaft and lever	
09780	Throttle shaft bushing (2)	
09678	Throttle shaft clip	
0992	Throttle shaft clip lockwasher	
01974	Throttle shaft clip retaining screw	
010775	*Throttle shaft return spring	
08646	Throttle shutter	
08942	*Throttle shutter screw	
GS-122	*Gasket and packing set	
RK-315	Repair parts kit	
	*Indicated contents of repair parts kit	

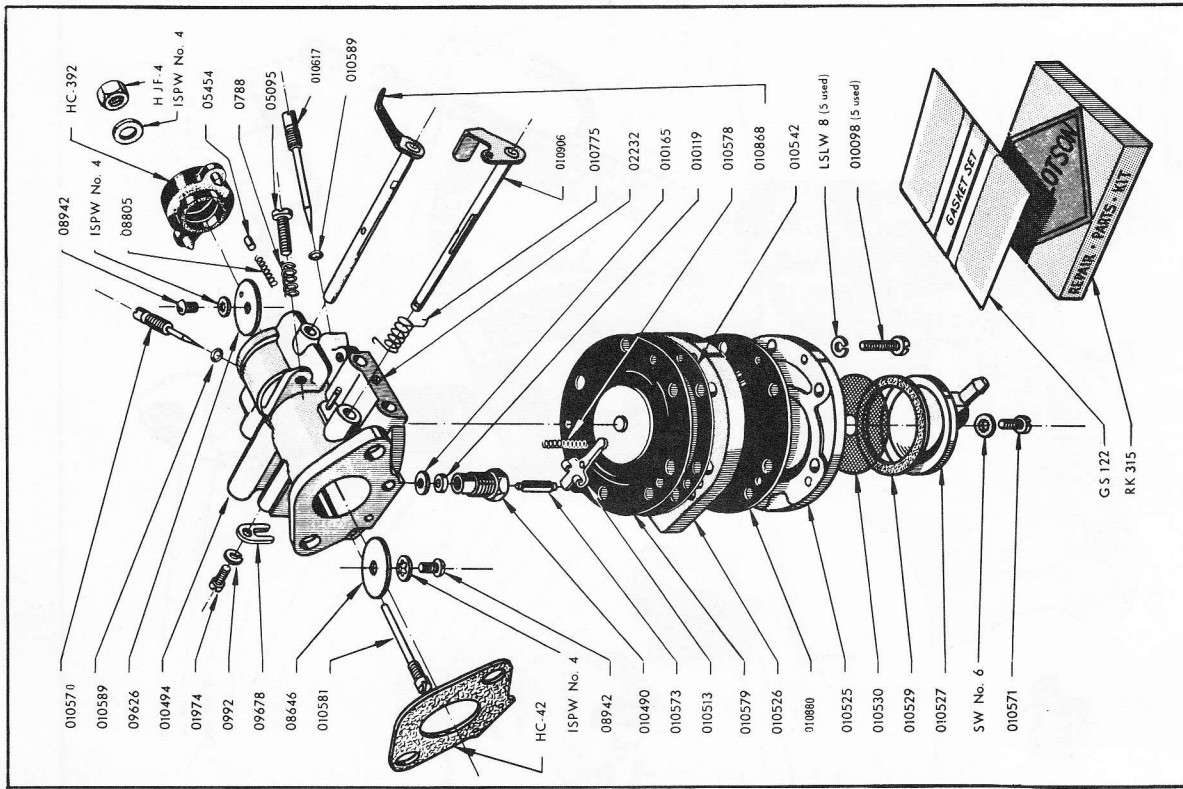

## MANUAL OIL PUMP

Part No.	Part Name
AB 221	"O" ring
B 65	Oil filler cap
DA 215B	Gland "O" ring
HA 214	Gland washer
HA 214	Plunger washer
HB 66	Gasket
HB 178	Oilier intake connector
HB 314	Gasket
WV 220	Plug
HM 212	Gland nut
HM 213	Gland gasket
HM 215	Oilier body
HM 215-I	Oil pump assembly comp.

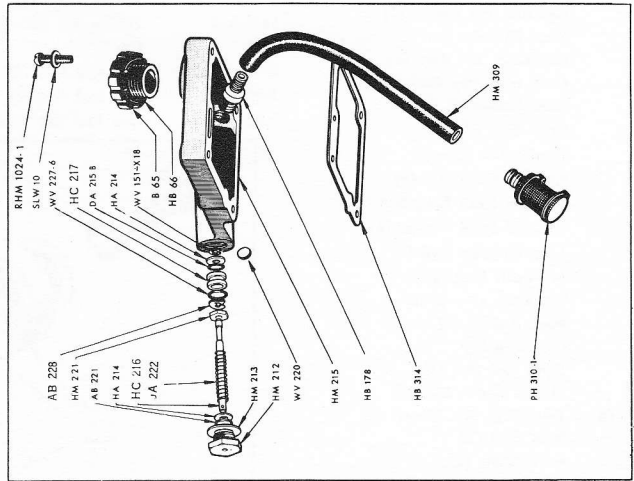

HC 216	Plunger rod
HC 217	Piston
HM 221	Plunger guide
JA 222	Plunger spring
HM 309	Flex. suction line
PH 310-1	Suction head unit
RHM 1024-1	Screws (4)
AB 228	Piston Clip
WV 151x18	Plunger guide clip
WV 227-6	Piston "O" ring
SLW 10	Lock washers

## MAGNETO

Part No.	Part Name
2965	Fixed contact clamp screw washer
3219	Breaker arm pivot washer
4210	Breaker arm lock (1)
6318	Cam wiper felt
7533	Condenser screw (1)
7533	Contact clamp screw
8732	Primary lead screw
X8807	Condenser
10407	Breaker point spacer washer
ESPW No. 10	Mag. stator washer (2)
HA 3	Grankshaft
HA 25C	Magneto cam
HA 25D	Ignition wire
HM 28	Flywheel unit
HM 26	Rotary air screen
HM 27	Baffle
PD 27	Ignition stop switch
PD 189	Magneto cam key

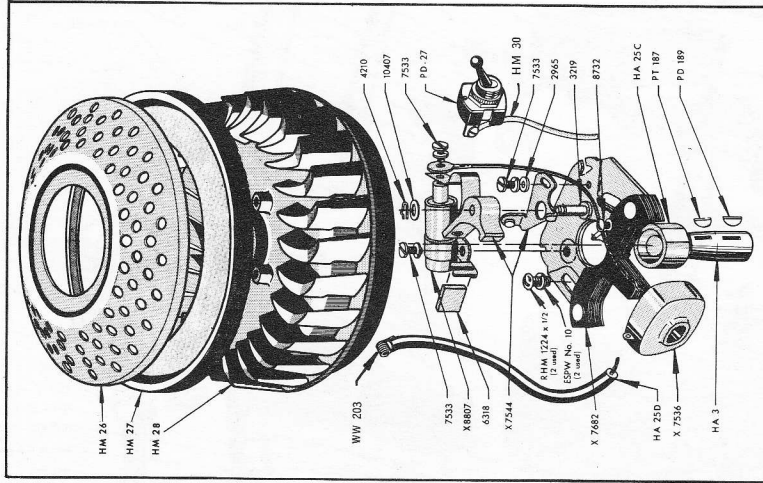

PT 187	Flywheel key
RHM 1224x½	Mag. stator screw (2)
SB 25A	Complete magneto and stator plate unit including coil, condenser, points, etc.
X7536	Coil group
X7544	Breaker contact set
X7682	Stator plate replacement assembly (includes stator plate and coil core only)
WV 203	Sparkie spring
HM 30	Switch wire assembly