

*DISSTON*

**ONE-MAN  
CHAIN SAW**

*with Mercury Gasoline Engine*

MODEL DO-101

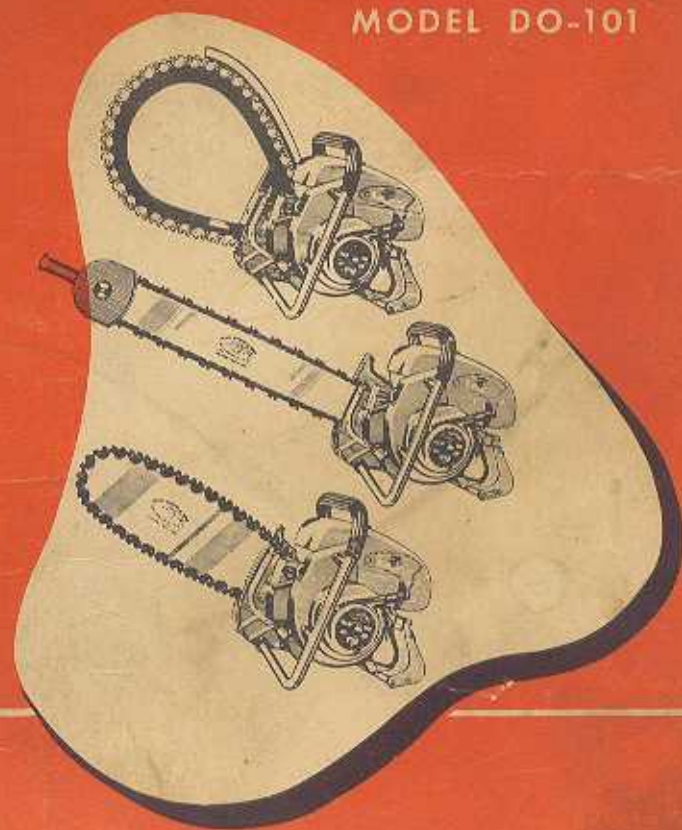

**PARTS CATALOG**

MATHER HARDWARE & SUPPLY Co., Inc.  
 4508 Park Blvd.  
 Louisville, 9,  
 Kentucky

## ATTENTION!

There are Three Corrections  
 to be Made in This Book

1. PAGE 8—entitled Tensioning Devices—Universal Assembly S-12-412—this number should be S-12-414.
2. PAGE 10—entitled Fuel Tank and Fuel System. Fuel Pump is illustrated as part number S-21-109. The correct part number should be S-21-100.
3. PAGE 10—Immediately adjoining the fuel pump, the close nipple illustrated as S-21-100 should be S-21-109.

FOR ACCURATE REPLACEMENT  
 PARTS ORDERING, PLEASE  
 MAKE THESE CORRECTIONS

# DISSTON ONE-MAN CHAIN SAW Parts Catalog

An illustrated guide for efficient servicing of all DO-100 and DO-101 models with Mercury gasoline engines

Here is a Parts Catalog which will make your work easier! Illustrations are numbered for quick identification and are near the Group listings.

1. Consult Index for page on which assembly is listed or illustrated.
2. Check the Description and the nearby Illustration.
3. When ordering renewal parts, always be sure to include the complete part number and the complete description of the part. Include the serial number of your saw with your order as a check.
4. Use only genuine Disston-Mercury renewal parts.
5. Remember that the correct part number appears in the column headed by the model number. Where the same part is used in several models, an arrow  $\leftarrow$  points to the common part number.

HENRY DISSTON & SONS, INC., PHILADELPHIA 35, PA., U. S. A.

PART 5-51-50224 Revised 11-51

## Alphabetical Index

DESCRIPTION	PAGE
AIR FILTER.....	11
BOW SAW KIT.....	20
CHAIN-CUTTING "S" TYPE.....	28
CHAIN-CUTTING "L" TYPE.....	28
CHAIN-CUTTING "C" TYPE.....	29
CHAIN-CUTTING "DF" TYPE.....	30
CHAIN ("DF" INSTALLATION KIT).....	31
CLUTCH CONTROL.....	23
CLUTCH JAW & GEAR.....	7
CONNECTING ROD.....	5
COWL—CYLINDER.....	5
CRANKCASE.....	3
CRANKSHAFT.....	3
CYLINDER.....	5
ELECTRICAL SYSTEM.....	17
FAN.....	19
FUEL PUMP.....	13
FUEL METER.....	15
FUEL TANK AND FUEL SYSTEM.....	11
GEAR CASE.....	7
GASKET SETS—ENGINE.....	32
GUIDE RAILS.....	27
INTAKE MANIFOLD.....	5
HANDLE—FRONT.....	21
HANDLE—REAR.....	23
MAGNETO.....	17
MUFFLER.....	5
OIL RESERVOIR.....	7
PISTON.....	5
RINGS—PISTON.....	5
SPROCKET & COVER.....	9
STARTER.....	19
SWITCH—SHORTING.....	23
TAILSTOCK.....	27
TENSIONING DEVICES.....	9
THROTTLE.....	23
TOOLS AND ACCESSORIES.....	25

## CRANKCASE & CRANKSHAFT

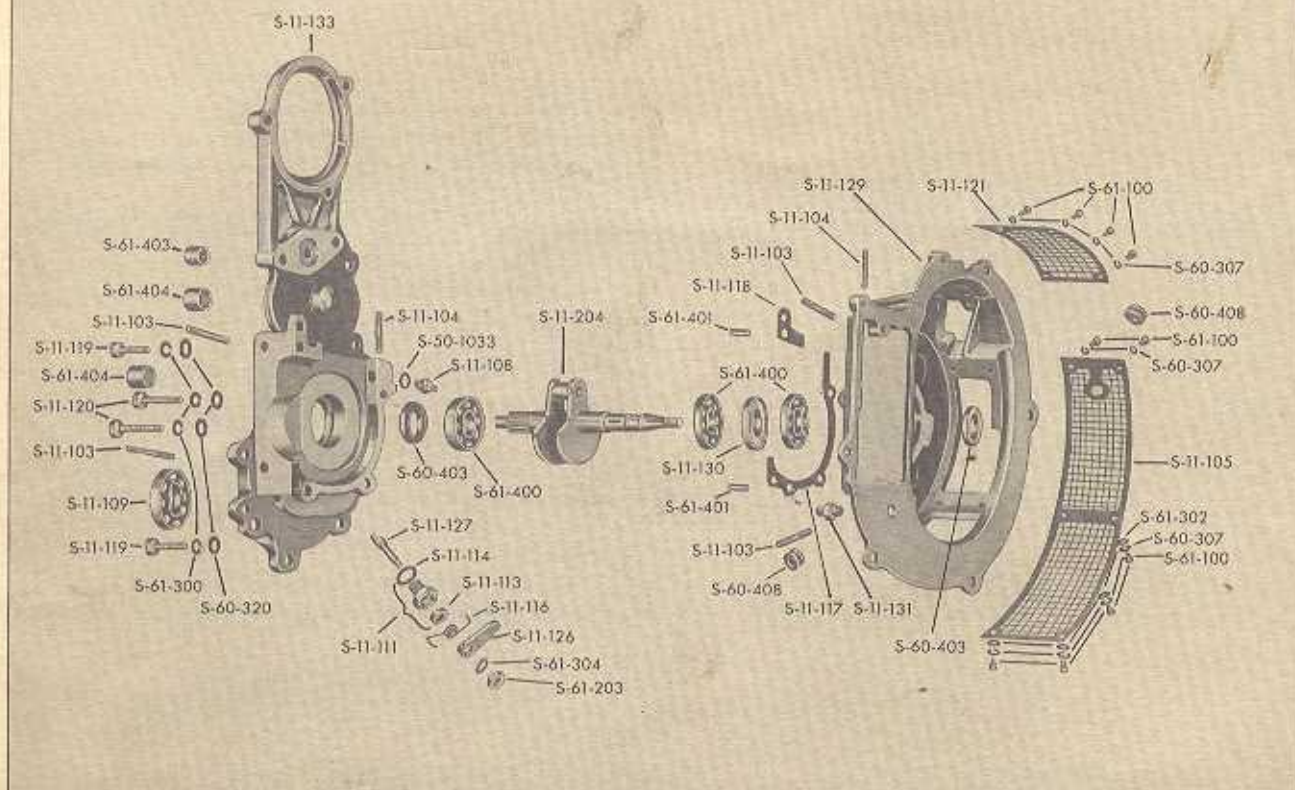

Page 2

## CRANKCASE AND CRANKSHAFT

NO. REQ.	DESCRIPTION	MODEL NUMBERS	
		DO-101	DO-100
1	<b>Crankcase Assembly—Fan Housing Half</b>	S-11-128	S-11-100
1	Crankcase—Fan Housing Half	S-11-129	S-11-101
2	Bearing—Crankshaft—small	S-61-400	←
1	Spacer—Bearing	S-11-130	S-11-102
1	Seal—Oil	S-60-403	←
2	Stud—Cylinder Mounting	S-11-103	←
1	Stud—Intake Manifold	S-11-104	←
2	Dowel—Crankcase	S-61-401	←
1	Screen Assembly—Lower	S-11-105	←
1	Screen Assembly—Upper	S-11-121	←
10	Screw—Screen Fastening	S-61-100	←
4	Washer—Screen Fastening Screw	S-61-302	←
10	Lockwasher—Screen Fastening Screw	S-60-307	←
1	Grammet	S-60-408	← (2)
1	Valve—Check	S-11-131	not sup.
1	<b>Crankcase Assembly—Gear Case Half</b>	S-11-132	S-11-106
1	Crankcase—Gear Case Half	S-11-133	S-11-107
1	Bearing—Crankshaft Ball	S-61-400	←
1	Seal—Oil	S-60-403	←
2	Stud—Cylinder Mounting	S-11-103	←
1	Stud—Intake Manifold	S-11-104	←
1	Valve—Check	S-11-108	←
1	Washer—Check Valve Sealing	S-50-1033	←
1	Bearing—Fuel Meter Shaft Needle	S-61-403	←
2	Bearing—Fuel Pump and Idler Shaft Needle	S-61-404	←
1	Bearing—Clutch Gear Ball	S-11-109	←
1	Cam—Clutch Control	S-11-127	←
1	Bearing Assembly—Special	S-11-111	←
1	Seal—Oil	S-11-113	←
1	Gasket—Special Bearing to Gear Case	S-11-114	←
1	Lever—Cam Control	S-11-126	←
1	Washer—Clutch Cam Lever Retaining	S-61-304	←
1	Nut—Clutch Cam Lever Retaining	S-61-203	←
1	Spring—Cam Control	S-11-116	←

## CONT.:

NO. REQ.	DESCRIPTION	MODEL NUMBERS	
		DO-101	DO-100
1	Gasket—Crankcase to Crankcase—Large	S-11-117	←
1	Gasket—Crankcase to Crankcase—Small	S-11-118	←
2	Screw—Crankcase to Crankcase	S-11-119	←
2	Screw—Crankcase to Crankcase	S-11-120	←
4	Washer—Crankcase to Crankcase Screw	S-60-320	←
4	Lockwasher—Crankcase to Crankcase Screw	S-61-300	←
1	<b>Crankshaft</b>	S-11-204	S-11-201

### INTERCHANGEABILITY

**Crankcase—Fan Housing Half:** Part S-11-101 can be used only on DO-100 engines, but Part S-11-129 can be used on either DO-101 or DO-100 engines. When Part S-11-129 is used on a DO-100, Bearing Spacer Part S-11-102 must be replaced with Bearing Spacer Part S-11-130 and a crankshaft spacer Part S-11-134 must be installed.

**Crankcase—Gear Case Half:** Part No. S-11-107 can be used only on DO-100 engines, but Part S-11-133 can be used on either DO-101 or DO-100 engines. When Part S-11-133 is used on a DO-100, Crankshaft Spacer Part S-11-134 must be installed.

**Crankshaft:** Parts S-11-204 and S-11-201 are dimensionally different and are not interchangeable.



## GEAR CASE COMPLETE

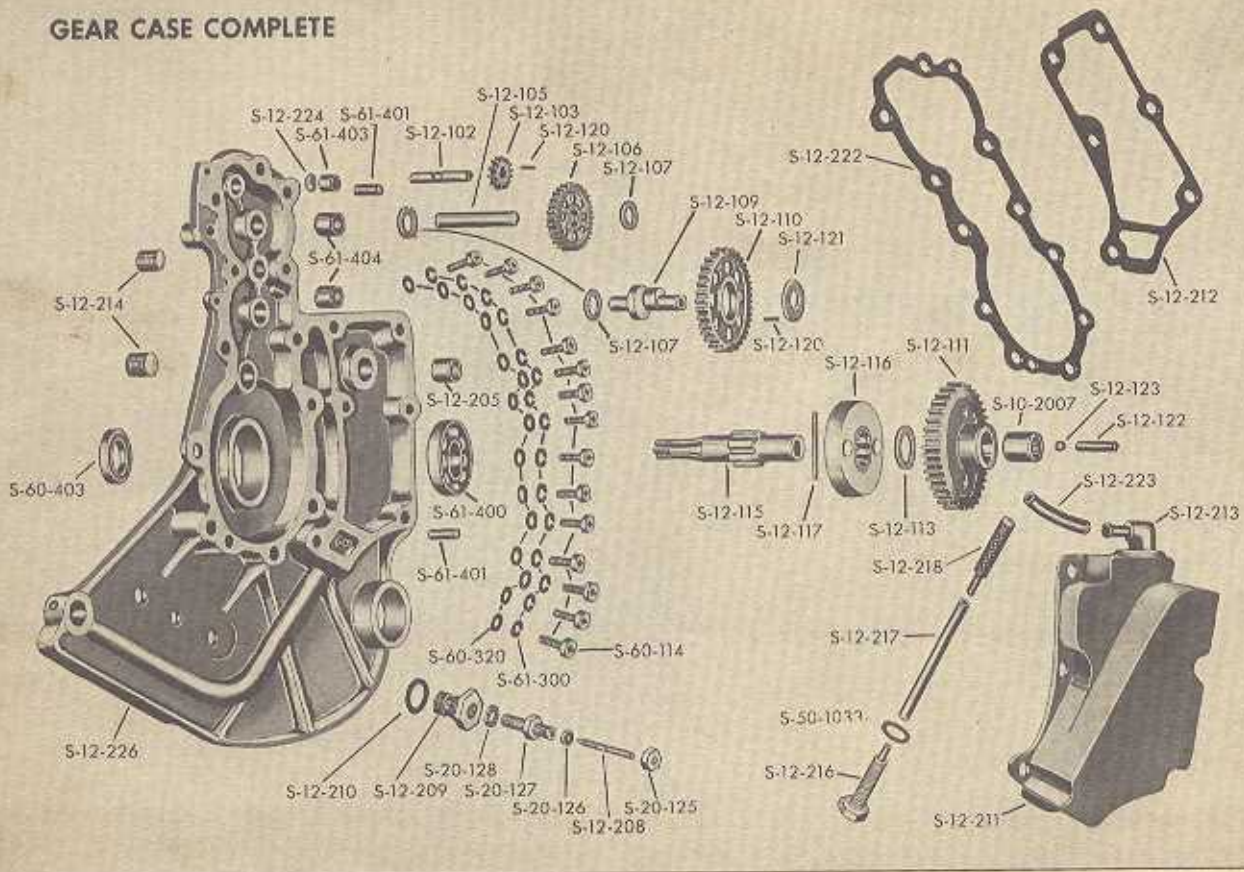

Page 6

## GEAR CASE—ACCESSORY DRIVE

NO. REQ.	DESCRIPTION	MODEL NUMBERS	
		DO-101	DO-100
1	Shaft and Gear Assembly—Fuel Meter	S-12-101	←
1	Shaft—Fuel Meter	S-12-102	←
1	Pin—Shaft to Gear	S-12-120	←
1	Gear—Fuel Meter Drive	S-12-103	←
1	Shaft and Gear Assembly—Idler	S-12-104	←
1	Shaft—Idler	S-12-105	←
1	Gear—Idler Shaft	S-12-106	←
2	Washer—Thrust	S-12-107	←
1	Shaft and Gear Assembly—Fuel Pump	S-12-108	←
1	Shaft—Fuel Pump	S-12-109	←
1	Pin—Shaft to Gear	S-12-120	←
1	Gear—Fuel Pump Shaft	S-12-110	←
1	Washer—Thrust	S-12-107	←
1	Washer—Thrust	S-12-121	←
1	Gear Assembly—Clutch	S-12-111	←
1	Bearing—Clutch Gear Needle	S-10-2007	←
1	Washer—Clutch Gear to Shaft Thrust	S-12-113	←
1	Shaft Assembly—Clutch	S-12-114	←
1	Shaft—Clutch	S-12-115	←
1	Jaw—Clutch Driven Member	S-12-116	←
1	Pin—Jaw to Clutch Shaft Groove	S-12-117	←
1	Ball— $\frac{1}{4}$ " dia.	S-12-123	←
1	Pin—Steel $\frac{3}{8}$ " x $1\frac{1}{2}$ "	S-12-122	←
1	Gear Case Cover Assembly Complete	Not available as an Assembly	S-12-200
1	Cover Assembly—Gear Case	S-12-226	S-12-201
2	Bearing—Fuel Pump and Idler Shaft Needle	S-61-404	←
1	Plate—Fuel Meter Shaft Thrust	S-12-224	←
1	Bearing—Fuel Meter Shaft Needle	S-61-403	←
1	Bearing—Crankshaft Needle	S-12-205	←
1	Bearing—Clutch Shaft Ball	S-61-400	←

## CONT.:

NO. REQ.	DESCRIPTION	MODEL NUMBERS	
		DO-101	DO-100
1	Seal—Oil	S-60-403	←
2	Pin—Dowel	S-61-401	←
1	Needle Valve Assembly Complete	S-12-206	←
1	Needle Valve Assembly	S-12-207	←
1	Body—Needle Valve	S-20-127	←
1	Valve—Needle	S-12-208	←
1	Nut—Needle Valve Gland	S-20-125	←
1	Packing—Gland Nut	S-20-126	←
1	Case—Needle Valve Assembly	S-12-209	←
1	Gasket—Needle Valve Body to Case	S-20-128	←
1	Gasket—Needle Valve Case to Gear Case Cover	S-12-210	←
1	Reservoir—Oil	S-12-211	←
1	Gasket—Oil Reservoir to Gear Case Cover	S-12-212	←
6	Screw—Oil Reservoir to Gear Case Cover	S-60-114	←
6	Washer—Oil Reservoir to Gear Case Cover Screw	S-60-320	←
6	Lockwasher—Oil Reservoir to Gear Case Cover Screw	S-61-300	←
1	Elbow—90° $\frac{3}{8}$ " Turned End—Pressure Inlet	S-12-213	←
2	Plug—Filler	S-12-214	←
1	Pick Up Assembly—Oil	S-12-215	←
1	Tube—Oil Feed	S-12-216	←
1	Washer—Tube Head to Oil Reservoir Sealing	S-50-1033	←
1	Tube—Oil Pick Up	S-12-217	←
1	Filter Assembly—Oil	S-12-218	←
1	Gasket—Gear Case Cover to Gear Case Half of Crankcase	S-12-222	←
9	Screw—Gear Case Cover to Gear Case Half of Crankcase	S-60-114	←
9	Washer—Gear Case Cover to Gear Case Half of Crankcase	S-60-320	←
9	Lockwasher—Gear Case Cover to Gear Case Half of Crankcase	S-61-300	←
1	Tubing—Pressure Inlet Flexible	S-12-223	←

## INTERCHANGEABILITY

**Gear Case Cover:** Part S-12-226 is the same as Part S-12-201 except the former is machined on the abutment plate to accommodate the "DF" chain. By filing-out "DF" chain clearance on Part S-12-201 it becomes interchangeable with Part S-12-226. Part S-12-226 can be used on either DO-101 or DO-100 engines.

Page 7

## DRIVE SPROCKET and COVER

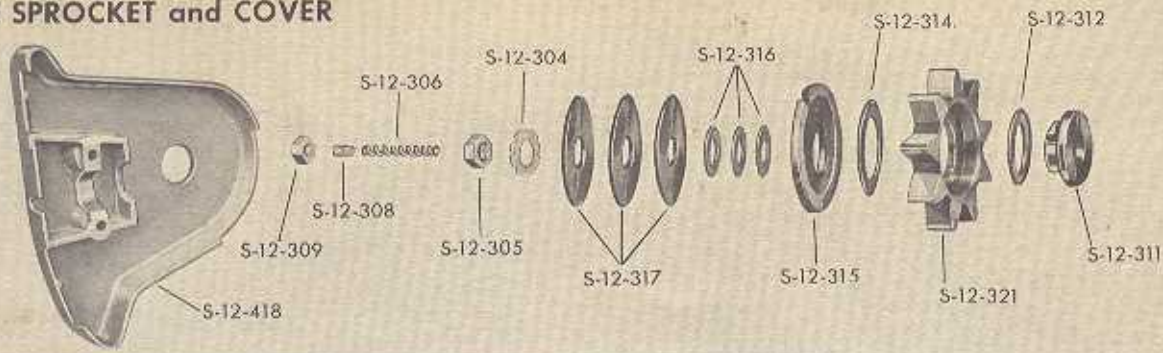

## TENSIONING DEVICES

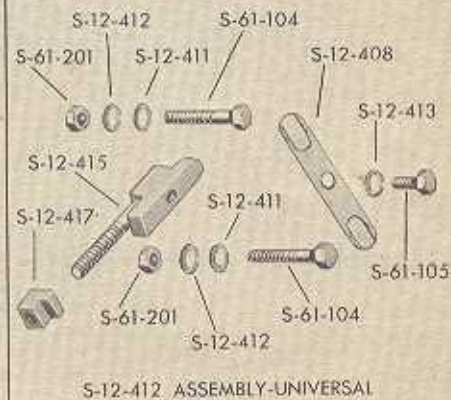
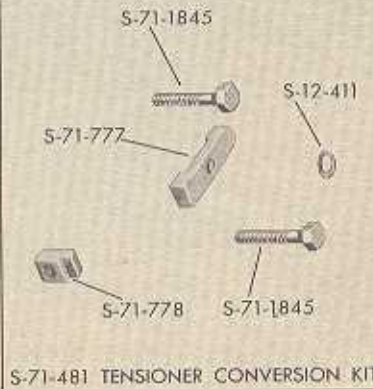
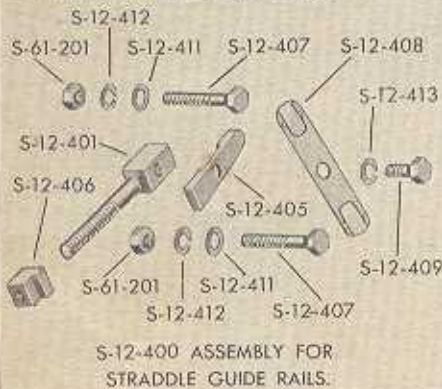

Page 8

## DRIVE SPROCKET

NO. REQ.	DESCRIPTION	MODEL NUMBERS	
		DO-101	DO-100
1	Sprocket Assembly—Safety	S-12-320 (9 pt.)	S-12-310 (7 pt.)
1	Hub—Sprocket	S-12-311	—
1	Plate—Inner Clutch	S-12-312	—
1	Sprocket	S-12-321 (9 pt.)	S-12-313 (7 pt.)
1	Plate—Outer Clutch	S-12-314	—
1	Washer—Pressure	S-12-315	—
2-3	Washer—Steel (0.015")	S-12-316	—
3	Washer—Spring	S-12-317	—
1	Lockwasher—Jamnut Splined	S-12-304	—
1	Jamnut—Sprocket Retaining	S-12-305	—
1	Spring—Clutch Pressure	S-12-306	—
1	Screw—Clutch Spring Retaining	S-12-308	—
1	Locknut—Clutch Spring Retaining Screw	S-12-309	—

## TENSIONING DEVICE

NO. REQ.	DESCRIPTION	MODEL NUMBERS	
		DO-101	DO-100
1	Device Assembly—Chain Tensioning	S-12-414	S-12-400
1	Anchor Assembly—Tension Screw	not sup.	S-12-401
1	Key—Guide Bar	not sup.	S-12-405
1	Screw Assembly—Key and Tensioning	S-12-415	not sup.
1	Block—Tensioning	S-12-417	S-12-406
2	Screw—Guide Rail and Sprocket Cover	S-61-104	S-12-407
1	Plate—Locking	S-12-408	—
1	Screw—Locking Plate to Tension Screw Anchor	not sup.	S-12-409
1	Screw—Locking Plate to Guide Bar Key	S-61-105	not sup.
1	Lockwasher—Locking Plate Screw	S-12-413	—
1	Cover—Sprocket	S-12-418	S-12-410
2	Nut—Guide Rail to Sprocket Cover Screw	S-61-201	—
2	Washer—Guide Rail to Sprocket Cover Screw	S-12-411	—
2	Lockwasher—Guide Rail to Sprocket Cover Screw	S-12-412	—

Part No. S-12-321 Sprocket (9 point) is used with "DF" (Fast Cut)  $\frac{3}{4}$ " pitch chains only. Engine Models DO-101 or DO-100 using "S" (Straddle), "C" (Chisel) or "L" (Leader) type chains require the 7 point Sprocket Part No. S-12-313.

Early Model DO-100 engines manufactured prior to August 1948, did not have on them the Safety Sprocket Assembly. They had a plain Sprocket Part No. S-12-300 which is now obsolete. During the DO-100 Modernization Program (1948-49) plain Sprockets Part No. S-12-300 were replaced by improved Safety Sprocket Assemblies Part No. S-12-310.

Tensioner Conversion Kit Part No. S-71-841 includes the following Parts:—

- 1—Key—Part No. S-71-777
- 1—Block—Tensioning—Part No. S-71-778
- 2—Screw—Guide Rail & Sprocket Cover—Part No. S-71-1845
- 1—Screw—Locking Plate to Tensioning Screw Anchor—Part No. S-71-779
- 1—Washer (For S-71-779 Screw)—Part No. S-12-411

Model DO-100 engines with "S" (Straddle) type Guide Rails were equipped with Tensioning Device Assembly Part No. S-12-400. By replacing parts in this assembly with those included in the Tensioner Conversion Kit Part No. S-71-841, heavier thickness grooved type Guide Rails 30" or "DF" type can be installed on the Model DO-100 engines.

Tensioning Device Assembly Part No. S-12-414 as supplied on DO-101 engines is a universal tensioner which can be used with all type Guide Rails on either DO-100 or DO-101 engines.

Page 9

# FUEL TANK AND FUEL SYSTEM

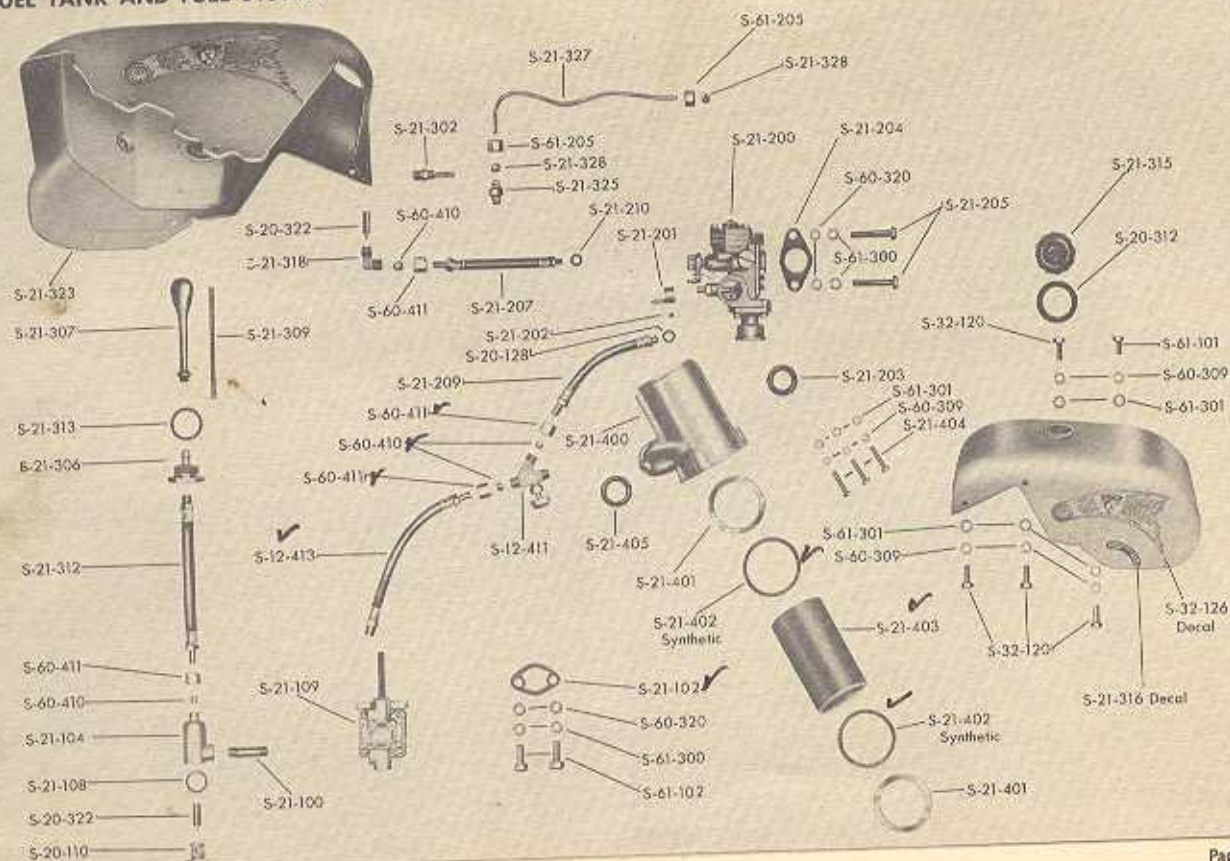

Page 10

## FUEL SYSTEM

NO. REQ.	DESCRIPTION	MODEL NUMBERS	
		DO-101	DO-100
1	<b>Tank Assembly—Fuel</b>	not available as an Assembly	S-21-300
1	Tank—Fuel	S-21-323	S-21-301
2	Decal—Operation & Lubrication	S-32-126	—
1	Decal—Start—Run	S-21-316	—
1	Check Valve & Strainer Assembly	not sup.	S-21-302
1	Flexible Feed Assembly—Complete	not sup.	S-21-305
1	Fitting	S-21-306	—
1	Pick Up—Fuel	S-21-307	—
1	Spring—Fuel Pick Up	S-21-309	—
1	Line Assembly—Fuel Tank to Fuel Pump—Flexible	S-21-311	—
1	Line—Fuel Tank to Fuel Pump—Flexible	S-21-312	—
1	Nut—Fuel Line Gland	S-60-411	—
1	Bushing—Fuel Line	S-60-410	—
1	Gasket—Fitting to Tank	S-21-313	—
1	Fuel Filter and 90° Elbow Assembly	S-21-317	—
1	Elbow and Filter Anchor Assembly	S-21-318	—
1	Element—Filter	S-20-322	—
1	Cap Assembly—Fuel Tank	S-21-314	—
1	Gasket—Fuel Tank Cap	S-20-312	—
1	Cap—Fuel Tank	S-21-315	—
1	Connector—Male— $\frac{3}{16}$ "	S-21-325	not sup.
1	Line Assembly—Bleed	S-21-326	not sup.
1	Line—Bleed	S-21-327	not sup.
2	Sieve—Fuel Line Compression	S-21-328	not sup.
2	Nut—Fuel Line Compression	S-61-205	not sup.
4	Screw—Fuel Tank Fastening	S-32-120	—
1	Screw—Fuel Tank Fastening (one nearest Air Cleaner)	S-61-101	—
5	Washer—Fuel Tank Fastening Screw	S-61-301	—
5	Lockwasher—Fuel Tank Fastening Screw	S-60-309	—
1	Housing—Air Cleaner	S-21-400	—
2	Washer—Retaining—Steel	S-21-401	—
2	Washer—Synthetic	S-21-402	—
1	Element—Filter	S-21-403	—

## CONT.:

NO. REQ.	DESCRIPTION	MODEL NUMBERS	
		DO-101	DO-100
3	Screw—Air Cleaner Housing Fastening	S-21-404	—
3	Washer—Air Cleaner Housing Fastening Screw	S-61-301	—
3	Lockwasher—Air Cleaner Housing Fastening Screw	S-60-309	—
1	"O" Ring—Air Cleaner to Fuel Meter	S-21-405	—
1	Shut-Off Valve Assembly—Primer	S-21-411	—
1	Line Assembly—Primer Flexible Fuel	S-21-412	—
1	Bushing—Fuel Line	S-60-410	—
1	Line—Primer Flexible Fuel	S-21-413	—
1	Nut—Fuel Line Gland	S-60-411	—

## INTERCHANGEABILITY

Fuel Tank: Parts S-21-323 and S-21-301 are completely interchangeable. Fuel system on DO-101 engines includes a Bleed Line Assembly not included on DO-100 engines.





# FUEL METER

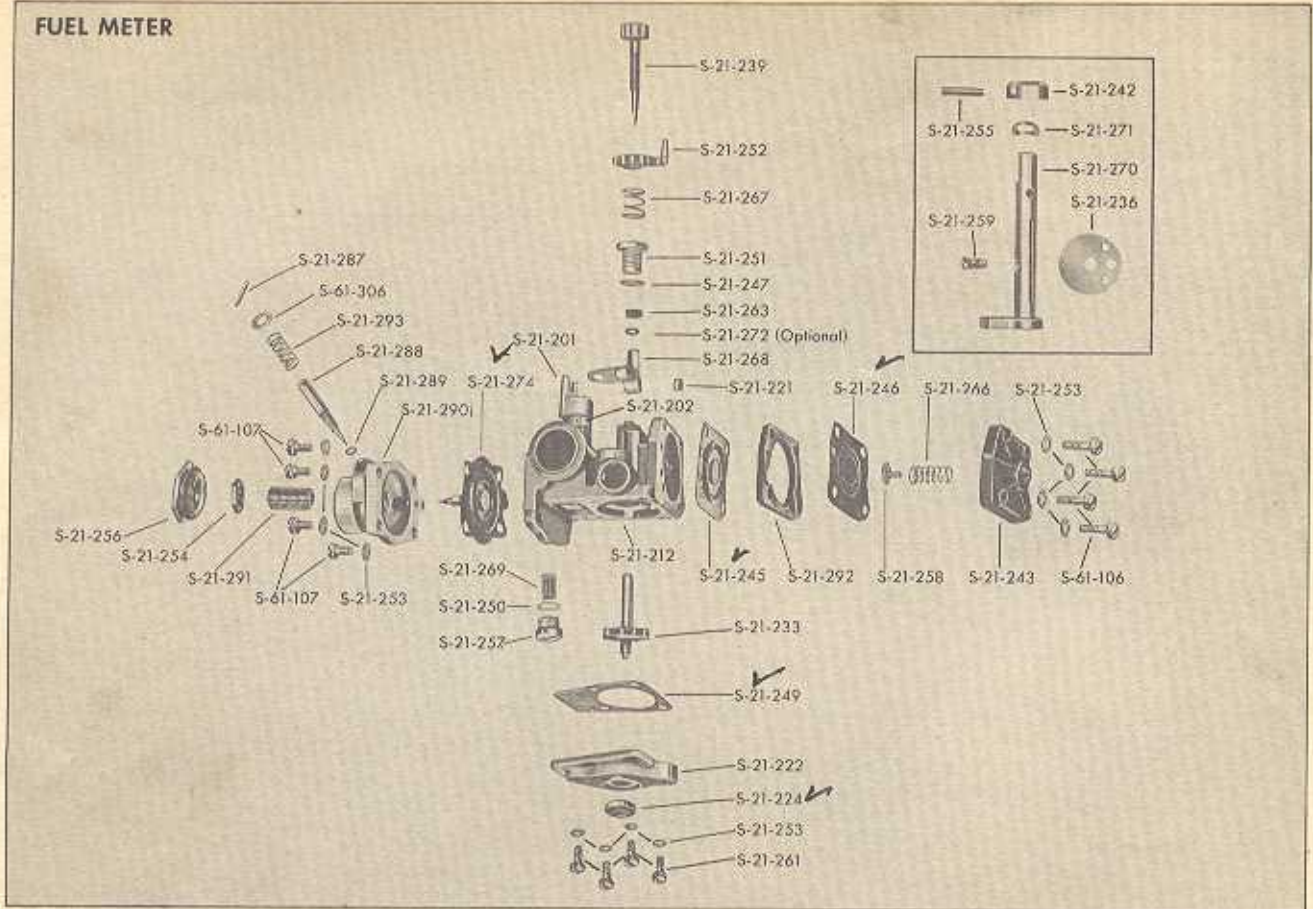

## FUEL METER

NO. REQ.	DESCRIPTION	MODEL NUMBERS	
		DO-101	DO-100
1	Meter Assembly—Fuel	S-21-285	S-21-200
1	Main Body Assembly	S-21-212	+
1	Reducer—Fuel Return	S-21-221	+
2	Pin—Dowel—Cover Locating	S-21-225	+
1	Cover Assembly—Impeller	S-21-222	+
1	Seal—Impeller Shaft	S-21-224	+
1	Diaphragm & Needle Valve Mix. Con. Assem.	S-21-274	+
1	Impeller and Shaft Assembly—Fuel	S-21-233	+
1	Shaft & Cam Assembly—Throttle	S-21-236	+
1	Valve Adj. Metering Jet Needle Assembly	S-21-239	+
1	Valve Assembly—Idle Needle	S-21-286	not sup.
1	Pin—Groove—Valve Needle	S-21-287	not sup.
1	Valve—Idle Needle	S-21-288	not sup.
1	"O" Ring—Idle Needle Valve Packing	S-21-289	not sup.
1	Spring—Idle Needle Valve	S-21-293	not sup.
1	Washer—Idle Needle Valve	S-61-306	not sup.
1	Collar—Throttle Shaft	S-21-242	+
1	Cover—Discharge Diaphragm	S-21-243	+
1	Cover—Mixture Control Needle Valve	S-21-290	S-21-244
1	Diaphragm—Discharge	S-21-245	+
1	Diaphragm—Fuel Cutoff	S-21-246	+
1	Gasket—Meter Adj. Needle Seat	S-21-247	+
1	Gasket—Mixture Control Cover Plug	S-21-248	+
1	Gasket—Impeller Cover	S-21-249	+
1	Gasket—Fuel Strainer	S-21-250	+
1	Guide—Adj. Metering Needle Valve	S-21-251	+
1	Lever—Adj. Metering Needle Valve	S-21-252	+
1	Lockwasher—Screw	S-21-253	+
1	Nut—Mixture Control Needle Valve Seat Lock	S-21-254	+
1	Pin—Groove—Throttle Stop	S-21-255	+
1	Plug—Mixture Control Cover	S-21-256	+
1	Plug—Fuel Strainer	S-21-257	+
1	Plunger—Fuel Cutoff	S-21-258	+
1	Screw—Throttle Valve Att.	S-21-259	+
4	Screw—Discharge Diaphragm Cover Att.	S-61-106	S-21-260
4	Screw—Impeller Cover Att.	S-21-261	+
4	Screw—Mix. Cont. Cover Att.	S-61-107	S-21-262

## CONT.:

NO. REQ.	DESCRIPTION	MODEL NUMBERS	
		DO-101	DO-100
1	Seal—Adj. Metering Needle Valve	S-21-263	+
1	Seat—Mixture Con. Needle Valve	S-21-291	S-21-264
1	Spacer—Fuel Cutoff Diaphragm	S-21-292	S-21-265
1	Spring—Fuel Cutoff Plunger	S-21-266	+
1	Spring—Adj. Metering Needle Valve	S-21-267	+
1	Spring—Lock Adj.—Needle Valve Lever	S-21-268	+
1	Strainer—Fuel	S-21-269	+
1	Valve—Throttle	S-21-270	+
1	Washer—Spring—Throttle Play	S-21-271	+
1	Washer—Metering Jet Needle Seal (optional)	S-21-272	+
1	Adaptor—Throttle	S-21-201	+
1	Screw—Socket Head Cup Point Set	S-21-202	+
1	"O" Ring—Fuel Meter to Intake Manifold (see page 10)	S-21-203	+
1	Gasket—Fuel Meter to Gear Case Cover (see page 10)	S-21-204	+
2	Screw—Fuel Meter to Gear Case Cover (see page 10)	S-21-205	+
2	Washer—Fuel Meter to Gear Case Cover Screw (see p. 10)	S-60-320	+
2	Lockwasher—Fuel Meter to Gear Case Cov. Screw (see p. 10)	S-61-330	+
1	Line Assembly—Fuel Bleed Flexible (see page 10)	S-21-206	+
1	Line—Fuel Bleed Flexible (see page 10)	S-21-207	+
1	Gasket—Fuel Bleed Line (see page 10)	S-21-210	+
1	Nut—Fuel Line Gland (see page 10)	S-60-411	+
1	Bushing—Fuel Line (see page 10)	S-60-410	+
1	Line Assembly—Fuel Inlet Flexible (see page 10)	S-21-208	+
1	Line—Fuel Inlet Flexible (see page 10)	S-21-209	+
1	Gasket—Fuel Inlet Line (see page 10)	S-20-128	+
1	Nut—Fuel Line Gland (see page 10)	S-60-411	+
1	Bushing—Fuel Line (see page 10)	S-60-410	+

### INTERCHANGEABILITY

Fuel Meter: Parts S-21-285 and S-21-200 are physically different and their various component parts are not interchangeable in all instances, but the meters as a complete unit are fully interchangeable on both DO-101 and DO-100 engines.



# STARTER AND FAN

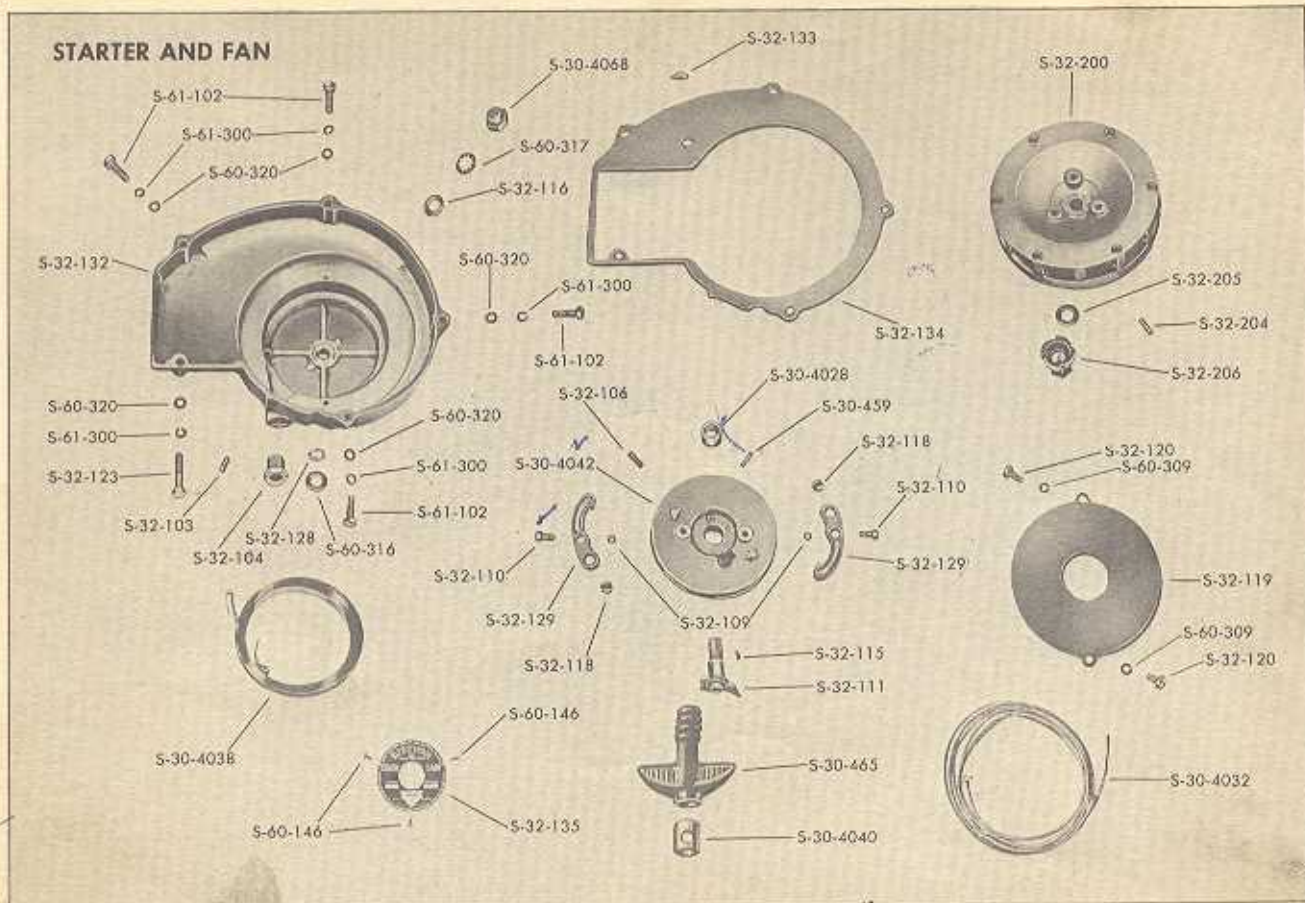

## STARTER AND FAN

NO. REQ.	DESCRIPTION	MODEL NUMBERS	
		DO-101	DO-100
1	<b>Starter &amp; Fan Housing Assembly Complete</b>	S-32-130	S-32-100*
1	Starter & Fan Housing Assembly	S-32-131	S-32-101*
1	Starter & Fan Housing	S-32-132	S-32-102*
1	Pin—Housing Anchor	S-32-103	—
1	Guide—Cable	S-32-104	—
1	Spring—Starter Coil	S-30-4038	—
1	Sheave Assembly—Starter	S-32-105	—
1	Sheave—Starter	S-30-4042	—
1	Pin—Sheave Anchor	S-30-459	—
1	Pin—Sheave Retaining	S-32-106	—
1	Bearing—Sheave Shaft Needle	S-30-4028	—
1	Cable Assembly—Starter	S-30-4032	—
2	Guard—Thread	S-32-109	—
2	Screw—Starter Sheave	S-32-110	—
1	Shaft Assembly—Starter Sheave	S-32-111	—
1	Washer—Chapmanized	S-60-316	—
1	Key—Sheave Shaft to Housing	S-32-115	—
1	Washer—Starter Sheave Shaft	S-32-116	—
1	Shim—Starter Sheave Shaft (optional)	S-32-128	—
1	Lockwasher—Acorn Nut	S-60-317	—
1	Nut—Acorn	S-30-4068	—
2	Pawl Assembly—Starter	S-30-4120	S-30-4035
2	Pawl—Starter	S-32-129	S-32-117
2	Magnet—Starter Pawl	S-32-118	—
1	Plate—Starter Friction	S-32-119	—
2	Screw—Friction Plate to Housing	S-32-120	—
2	Lockwasher—Friction Plate to Housing Screw	S-60-309	—
1	Handle Assembly—Starter Cable	S-30-465	S-32-125
1	Handle—Starter Cable	not sup.	S-32-121
1	Reinforcement—Starter Cable Handle	not sup.	S-32-124
1	Insert—Starter Cable Handle	S-30-4040	—
1	Screen—Check Valve	S-32-133	not sup.
1	Plate—Starter & Fan Housing to Crankcase Sealing	S-32-134	S-32-122
4	Screw—Starter & Fan Housing to Crankcase	S-61-102	—
1	Screw—Starter & Fan Housing to Crankcase (Long)	S-32-123	—
5	Washer—Starter & Fan Housing to Crankcase Screw	S-60-320	—
5	Lockwasher—Starter & Fan Housing to Crankcase Screw	S-61-300	—

## CONT.:

NO. REQ.	DESCRIPTION	MODEL NUMBERS	
		DO-101	DO-100
1	Plate—Name	S-32-135	S-32-127
3	Screw—Name Plate Drive	S-60-146	—
1	Fan Assembly—Cooling	S-32-200	—
1	Key—Fan to Crankshaft	S-32-204	—
1	Washer—Ratchet to Fan	S-32-205	—
1	Ratchet—Starter	S-32-206	—

\* Discontinued—No longer available from factory.

### INTERCHANGEABILITY

**Starter and Fan Housing:** Assemblies Parts S-32-130, S-32-131 and S-32-132 for DO-101 engines and Assemblies Parts S-32-100, S-32-101 and S-32-102 for DO-100 engines are the same except for a 1/8" drain hole which is included in the former Housings. Assemblies Parts S-32-130, S-32-131 and S-32-132 can be used on both DO-101 and DO-100 engines. By drilling a 1/8" drain hole in the bottoms of Housings S-32-100, S-32-101 and S-32-102 they can be used on either DO-101 or DO-100 engines.

**Starter Pawl:** Parts S-32-129 and S-32-117 and Assemblies S-30-4120 and S-30-4035 are completely interchangeable.

**Starter Cable Handle:** Assemblies Parts S-30-465 and S-32-125 are completely interchangeable.

## FRONT HANDLE and BOW SAW ATTACHMENT

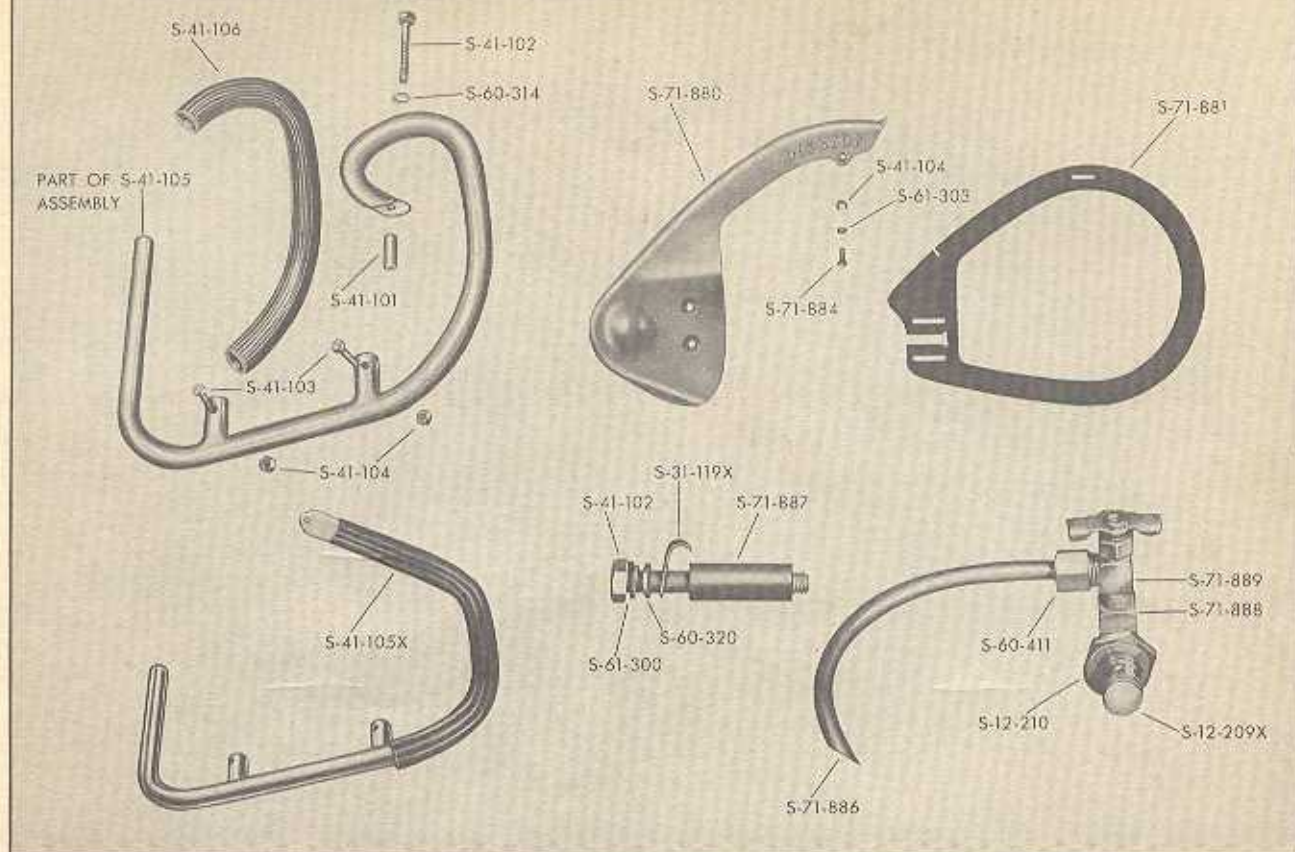

Page 20

## FRONT HANDLE

NO. REQ.	DESCRIPTION	MODEL NUMBERS	
		DO-101	DO-100
1	Handle Assembly—Front	S-41-105X	S-41-105
1	Grip—Handle	S-41-106	—
1	Spacer—Front Handle to Casting	S-41-101	—
1	Screw—Spacer	S-41-102	—
1	Lockwasher—Spacer Screw Shakeproof	S-60-314	—
2	Screw—Handle Fastening	S-41-103	—
2	Nut—Handle Fastening—Elastic Stop	S-41-104	—

### INTERCHANGEABILITY

**Front Handle:** Parts S-41-105X and S-41-105 can be installed on either DO-101 or DO-100 engines. Part S-41-105 cannot be used with the Bow Attachment. All DO-101 engines are equipped with Part S-41-105X handles so Bow Attachments may be installed without changing handles.

## REAR HANDLE and SHORTING SWITCH

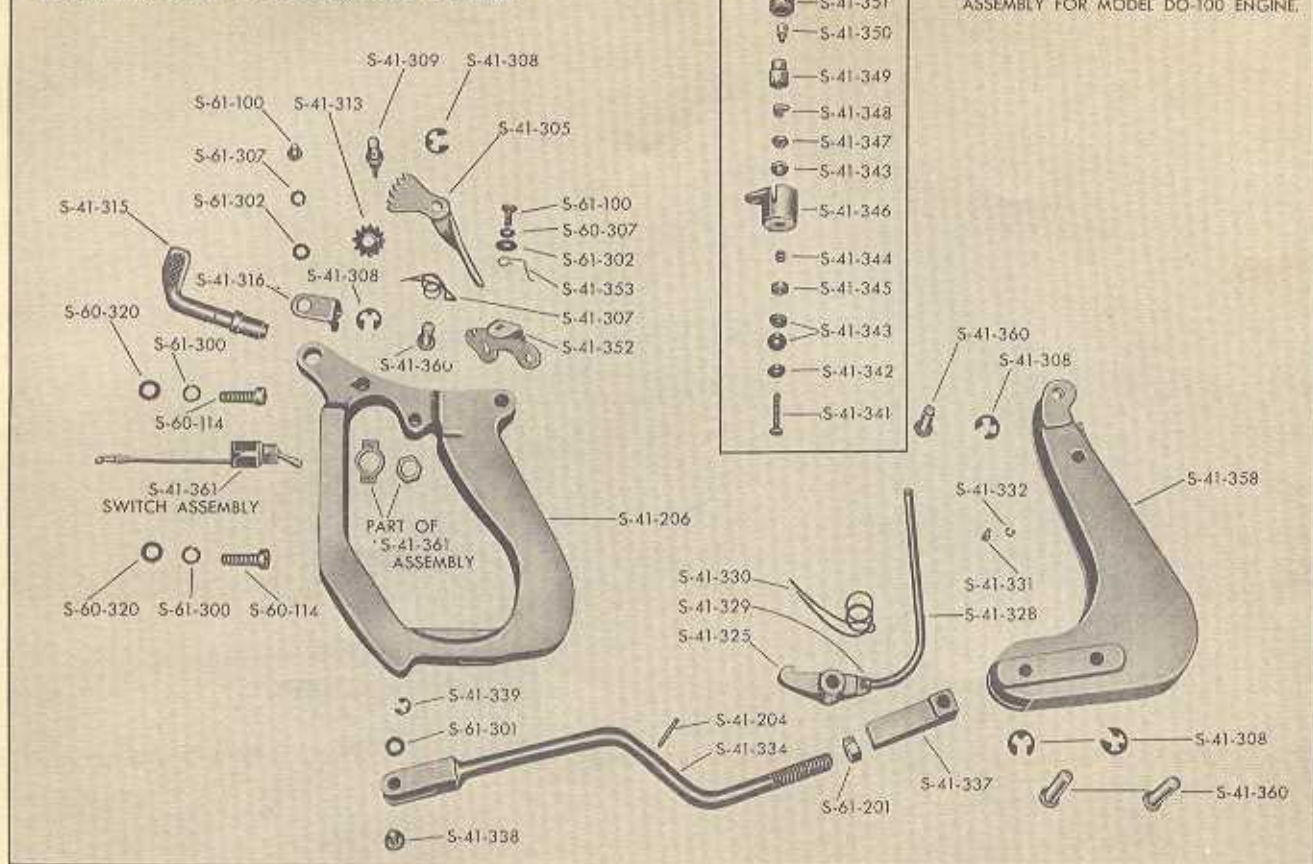

Page 22

## REAR HANDLE, CLUTCH CONTROL, AND SHORTING SWITCH

NO. REQ.	DESCRIPTION	MODEL NUMBERS	
		DO-101	DO-100
1	Handle Assembly Complete—Rear	Not available as an Assembly	S-41-200
1	Handle Assembly—Rear	S-41-205	S-41-201
1	Handle Assembly—Groove Pin & Rear	S-41-206	S-41-202
1	Pin—Groove	S-41-204	—
1	Lever—Throttle	S-41-305	—
1	Lock—Throttle	S-41-352	—
1	Spring—Tension	S-41-353	—
1	Pin—Throttle Lever to Handle	S-41-306	—
1	Spring—Throttle	S-41-307	—
1	Snap Ring—Throttle Lever to Handle Pin	S-41-308	—
1	Shaft Assembly—Throttle	S-41-309	—
1	Gear—Throttle	S-41-313	—
1	Snap Ring—Throttle Shaft to Handle	S-41-308	—
1	Control Handle—Fuel Mixture	S-41-315	—
1	Control Fork—Fuel Mixture	S-41-316	—
1	Screw—Fork to Control Handle	S-61-100	—
1	Washer—Fork to Control Handle Screw	S-61-302	—
1	Lockwasher—Fork to Control Handle Screw	S-60-307	—
1	Handle Assembly Complete—Clutch Control	S-41-357	S-41-318
1	Handle Assembly—Clutch Control	S-41-358	S-41-319
1	Lever Assembly Complete—Latch	S-41-324	—
1	Lever Assembly—Latch	S-41-325	—
1	Rod—Clutch Release	S-41-328	—
1	Rivet—Release Rod to Latch Lever	S-41-329	—
1	Spring—Latch Lever Locking	S-41-330	—
1	Pin—Latch Lever to Clutch Control Handle	S-41-360	S-41-306
1	Snap Ring—Latch Lever to Clutch Control Handle Pin	S-41-308	—
1	Pin—Release Yoke to Rod	S-41-331	—
1	Snap Ring—Release Yoke to Rod Pin	S-41-332	—
1	Pin—Clutch Control Handle to Rear Handle	S-41-360	S-41-306
1	Snap Ring—Clutch Control Handle to Rear Handle	S-41-308	—
1	Rod Assembly Complete—Clutch Control	S-41-333	—
1	Rod Assembly—Clutch Control	S-41-334	—
1	Nut—Connector to Rod Lock	S-61-201	—
1	Connector—Control Rod to Clutch Control Handle	S-41-337	—
1	Pin—Connector to Clutch Control Handle	S-41-360	S-41-306

NO. REQ.	DESCRIPTION	MODEL NUMBERS	
		DO-101	DO-100
1	Snap Ring—Connector to Clutch Control Handle Pin	S-41-308	—
1	Pin—Control Rod to Cam Control Lever	S-41-338	—
1	Washer—Control Rod to Cam Control Lever Pin	S-61-301	—
1	Snap Ring—Control Rod to Cam Control Lever Pin	S-41-339	—
1	Switch Assembly—Shorting (Button type)	not sup.	S-41-340
1	Screw—Shorting Switch	not sup.	S-41-341
1	Washer—Steel	not sup.	S-41-342
3	Washer—Insulating	not sup.	S-41-343
1	Bushing—Insulating	not sup.	S-41-344
1	Bushing—Steel	not sup.	S-41-345
1	Adaptor—Shorting Switch to Handle	not sup.	S-41-346
1	Nut—Shorting Screw	not sup.	S-41-347
1	Spring—Switch Base to Nut	not sup.	S-41-348
1	Base—Shorting Switch Cap	not sup.	S-41-349
1	Nut—Ground Screw End	not sup.	S-41-350
1	Cap—Insulating Push Button	not sup.	S-41-351
3	Lockscrew—Adaptor to Rear Handle	S-61-100	—
1	Lockwasher—Adaptor to Rear Handle	S-60-307	—
1	Washer—Adaptor to Rear Handle	S-61-302	—
1	Switch Assembly—Shorting (Toggle type)	S-41-361	not sup.
2	Screw—Rear Handle to Fan Housing	S-60-114	—
2	Washer—Rear Handle to Fan Housing Screw	S-60-320	—
2	Lockwasher—Rear Handle to Fan Housing Screw	S-61-300	—

### INTERCHANGEABILITY

**Rear Handle:** Part S-41-206 can be used on either DO-101 or DO-100 engines. Part S-41-202 cannot be used on DO-101 engines unless a 1/8" hole is drilled in the mounting flange for the Shorting Switch S-41-361.

**Clutch Control Handle:** Part S-41-358 is wider than S-41-319, however either handle can be used on either DO-101 or DO-100 engines. When Part S-41-358 is used it requires 3 longer pins Part S-41-360. S-41-319 requires 3 short pins Part S-41-306.

**Shorting Switch:** Part S-41-340 is a Button type switch and Part S-41-361 is a Toggle type switch. To install the Part S-41-361 switch on a DO-100 engine it is necessary to drill a 1/8" hole in the mounting Pad of the rear handle and replace the shorting switch wire with Part S-31-127.

Page 23

## TOOLS AND ACCESSORIES

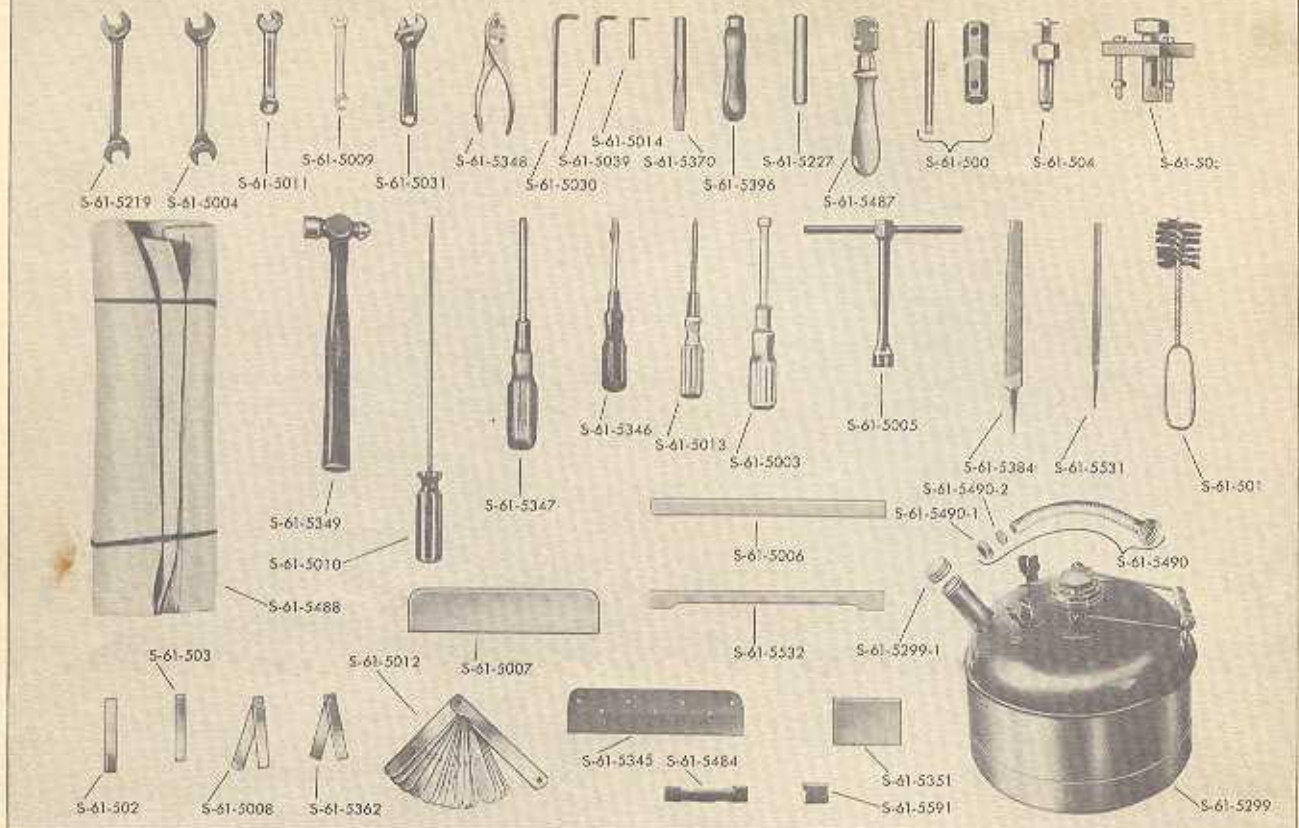

Page 24

## TOOLS AND ACCESSORIES

NO. REQ.	DESCRIPTION	MODEL NUMBERS	
		DO-101	DO-100
*	Wrench—Spark Plug	S-61-500	—
*	Brush—Air Cleaner—Bristle	S-61-501	—
*	Gauge—Spark Plug Feeler—.025"	S-61-502	—
*	Gauge—Breaker Point Feeler—.020"	S-61-503	—
*	Gauge—Timing	S-61-504	—
*	Puller—Fan Wheel	S-61-505	—
*	Handbook—Operator's	S-61-5001	—
*	Catalog—Parts	S-61-5002	—
*	Wrench—Spinifite Socket— $\frac{3}{16}$ "	S-61-5003	—
*	Wrench—Box & Open End— $\frac{3}{16}$ "	S-61-5004	—
*	Wrench—Special "Tee" Handle— $\frac{3}{16}$ "	S-61-5005	—
*	Bar—Joint & Set— $\frac{1}{2}$ " x $\frac{1}{2}$ " x 7"	S-61-5006	—
*	Runway—Chain—2" x 8" x 14 gauge—for "S" Chains	S-61-5007	—
*	Gauge—Joint (0.015") & Set (0.135") for "S" Chains	S-61-5008	—
*	Wrench—Open End— $\frac{3}{16}$ " x $\frac{1}{2}$ "	S-61-5009	—
*	Screw Driver—Cabinet Type—8°	S-61-5010	—
*	Wrench—Ignition Open End— $\frac{3}{4}$ "	S-61-5011	—
*	Gauge—Multiple Blade Feeler	S-61-5012	—
*	Screw Driver—Phillips No. 1	S-61-5013	—
*	Wrench—Hex.— $\frac{3}{16}$ "	S-61-5014	—
*	Wrench—Allen— $\frac{3}{16}$ "	S-61-5030	—
*	Wrench—Adjustable—6"	S-61-5031	—
*	Wrench—Open End— $\frac{3}{16}$ " x $\frac{1}{2}$ "	S-61-5219	—
*	Stake—Riveting—L, S, and C Chain	S-61-5227	—
*	Can—Fuel—2 $\frac{1}{2}$ Gal.	S-61-5299	—
*	Cap for Rigid Spout on Fuel Can	S-61-5299-1	—
*	Runway—Chain—for "C", "L" & "DF" Chains	S-61-5345	—
*	Screw Driver—Std.—4°	S-61-5346	—
*	Screw Driver—Phillips No. 3	S-61-5347	—
*	Pliers—Combination—6"	S-61-5348	—
*	Hammer—Ball Pein—8 oz.	S-61-5349	—
*	Anvil—Riveting	S-61-5351	—
*	Gauge—Guide Rail Slot—for 30° Guide Rails only	S-61-5362	—
*	Chisel—Cold—5°	S-61-5370	—
*	File—Chain Saw—8° Mill Bastard—2 round edges	S-61-5384	—
*	Handle—File	S-61-5396	—

## CONT.:

NO. REQ.	DESCRIPTION	MODEL NUMBERS	
		DO-101	DO-100
*	Gauge—Set & Joint—for "L" type Chains	S-61-5484	—
*	Tool—Setting	S-61-5487	—
*	Roll—Canvas Tool	S-61-5488	—
*	Flexible Hose & Cap for Fuel Can	S-61-5490	—
*	Strainer Collar—for Flexible Spout	S-61-5490-1	—
*	Strainer—for Flexible Spout	S-61-5490-2	—
*	File—6"—for "C" Chain	S-61-5631	—
*	Gauge—Set—for "S" Chain	S-61-5632	—
*	Wrench—Allen— $\frac{3}{16}$ "	S-61-5639	—
*	Gauge—Hook Angle—for "L" Chain	S-61-5661	—

\*One each of these parts is included with each DO-101 Chain Saw Unit.

Page 25

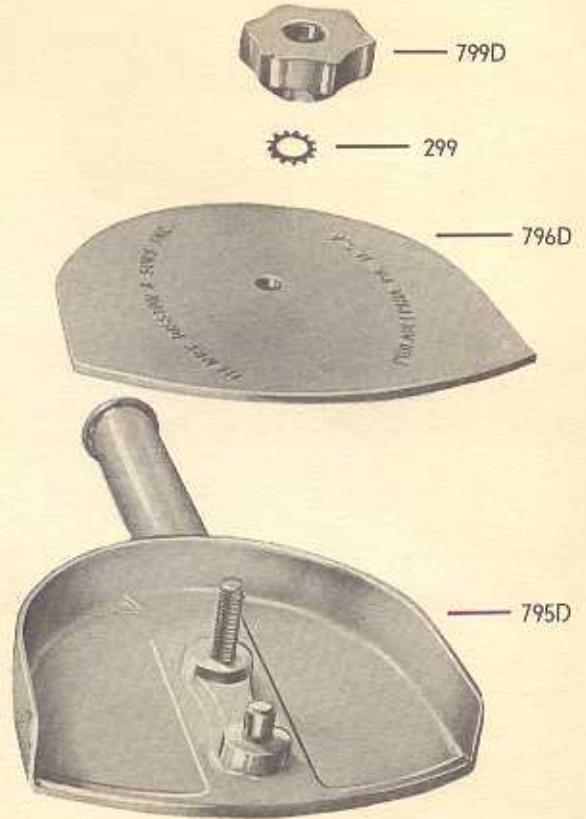
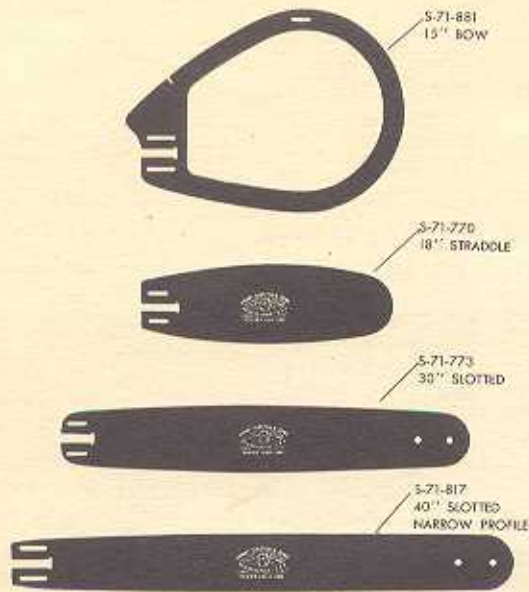

**GUIDE RAILS—DO-101 & DO-100**

CUTTING CAPACITY	DESCRIPTION (TYPE)	PART NUMBER
15"	Bow—Straddle—"S"	S-71-881
18"	Straddle—"S"	S-71-770
*20"	Slotted—"DF"	S-71-813
*24"	Straddle—"S"	S-71-772
*26"	Slotted—"DF"	S-71-814
*30"	Slotted—"L" or "C"	S-71-773
*32"	Slotted—"DF"	S-71-815
*36"	Slotted—"DF"	S-71-816
*40"	Slotted—"DF"	S-71-817

\*—Drilled for Supplementary Tail Stock Part No. S-71-763AD

Model DO-101 Saws are available with either Straddle or Slotted Guide Rails. Model DO-100 Saws were equipped with Straddle or 30" Slotted Guide Rails only. Slotted "DF" rails may be installed on Model DO-100 engines provided the Sprocket Cover and Gear Case Cover are filed-out for "DF" Chain Clearance and the 9 pt. "DF" Sprocket Part No. S-12-321 and Tensioner Kit Part No. S-71-841 are installed.

**SUPPLEMENTARY TAILSTOCKS—DO-101 & DO-100**

NO. REQ.	DESCRIPTION	PART NUMBER
1	Supplementary Tail Stock	S-71-763AD
1	Housing	S-71-795D
1	Cover	S-71-796D
1	Washer—Sha keproof—1/2"	S-71-229
1	Nut—Locking	S-71-799D

Parts S-71-797 Dowel, S-71-798 Cover Stud, S-71-105 Jamnut, S-71-315 Lockwasher, and S-71-776 Spacer Washer for the Discontinued Sand Cast Tailstock Part No. S-71-763A are still available as replacement parts.

# CUTTING CHAINS

## STRADDLE TYPE →

- S-71-754 Cutter—Right
- S-71-755 Cutter—Left
- S-71-756 Raker—Right
- S-71-757 Raker—Left
- S-71-758 Raker—Center
- S-71-759 Link—Connecting
- S-71-760 Rivet
- S-71-761 Link—Connecting (includes 2 rivets)

S CHAIN LENGTHS	
15° Cutting Capacity	S-71-882
18° Cutting Capacity	S-71-750
24° Cutting Capacity	S-71-752

S-71-762 Kit-Chain Replacement, Type S, consists of:

S-71-754	5	S-71-757	3
S-71-755	6	S-71-758	3
S-71-756	3	S-71-761	12

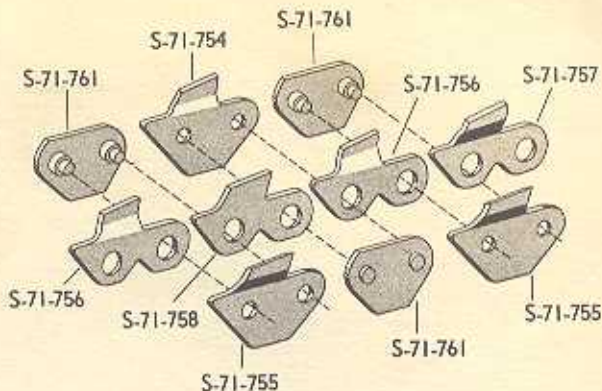

## ← LEADER TYPE

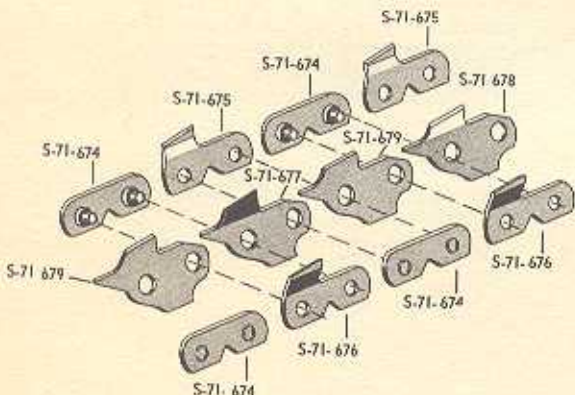

L CHAIN LENGTHS	
30° Cutting Capacity	S-71-451

(Can also be made from 2" L chain, Part No. 452, by removing one right cutter and one center raker where chain was originally joined.)

- S-71-674 Link—Connecting (supplied with two rivets)
- S-71-675 Cutter—Right
- S-71-676 Cutter—Left
- S-71-677 Raker—Left
- S-71-678 Raker—Right
- S-71-679 Raker—Center

S-71-682 Kit-Chain Replacement, Type L, consists of:

S-71-674	12	S-71-677	3
S-71-675	6	S-71-678	3
S-71-676	6	S-71-679	6

## FAST-CUT TYPE

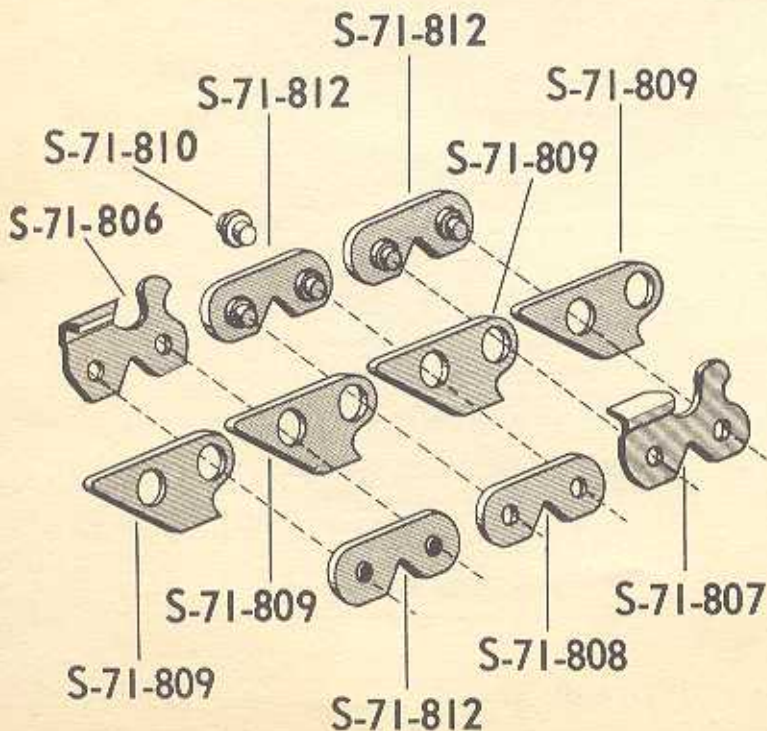

S-71-516 Replacement Kit, "DF" Chain—includes:	
3—S-71-806 Cutter, Right	
3—S-71-807 Cutter, Left	
6—S-71-808 Link, Side	
8—S-71-809 Link, Center	
12—S-71-810 Rivet	
12—S-71-812 Link, Side (with 2 rivets)	

S-71-517 Repair Kit, "DF" Chain—includes:	
1—S-71-806 Cutter, Right	
1—S-71-807 Cutter, Left	
2—S-71-808 Link, Side	
2—S-71-809 Link, Center	
4—S-71-810 Rivet	
2—S-71-812 Link, Side (with 2 rivets)	

S-71-806 Cutter, Right
S-71-807 Cutter, Left
S-71-808 Link, Side
S-71-809 Link, Center
S-71-810 Rivet
S-71-812 Link, Side (with 2 rivets)

DF Chain Lengths	
20° Cutting Capacity	S-71-818
26° Cutting Capacity	S-71-819
32° Cutting Capacity	S-71-820
36° Cutting Capacity	S-71-821
40° Cutting Capacity	S-71-822



## "DF" INSTALLATION KITS

**5-71-511 Installation Kit, "DF", 20"—includes:**

- 1—S-71-818 Chain, "DF", 20"
- 1—S-71-813 Guide Rail, "DF", 20"
- 1—S-12-321 Sprocket, "DF", 9 Pt.
- 1—S-71-841 Tensioner Conversion Kit

**5-71-512 Installation Kit, "DF", 26"—includes:**

- 1—S-71-819 Chain, "DF", 26"
- 1—S-71-814 Guide Rail, "DF", 26"
- 1—S-12-321 Sprocket, "DF", 9 Pt.
- 1—S-71-841 Tensioner Conversion Kit

**5-71-513 Installation Kit, "DF", 32"—includes:**

- 1—S-71-820 Chain, "DF", 32"
- 1—S-71-815 Guide Rail, "DF", 32"
- 1—S-12-321 Sprocket, "DF", 9 Pt.
- 1—S-71-841 Tensioner Conversion Kit

**5-71-514 Installation Kit, "DF", 36"—includes:**

- 1—S-71-821 Chain, "DF", 36"
- 1—S-71-816 Guide Rail, "DF", 36"
- 1—S-12-321 Sprocket, "DF", 9 Pt.
- 1—S-71-841 Tensioner Conversion Kit

**5-71-515 Installation Kit, "DF", 40"—includes:**

- 1—S-71-822 Chain, "DF", 40"
- 1—S-71-817 Guide Rail, "DF", 40"
- 1—S-12-321 Sprocket, "DF", 9 Pt.
- 1—S-71-841 Tensioner Conversion Kit

## GASKET SETS—DO-101 & DO-100

**Engine Gasket Set (Large Set) Part No. 5-61-5026**

Consists of:

- 1—S-11-114 Gasket—Special Bearing to Gear Case
- 1—S-11-117 Gasket—Crankcase to Crankcase—Large
- 1—S-11-118 Gasket—Crankcase to Crankcase—Small
- 1—S-11-403 Gasket—Cylinder to Crankcase
- 1—S-11-502 Gasket—Intake Manifold
- 1—S-11-701 Gasket—Exhaust Manifold
- 1—S-12-210 Gasket—Needle Valve Case to Gear Case Cover
- 1—S-12-212 Gasket—Oil Reservoir to Gear Case Cover
- 1—S-12-222 Gasket—Gear Case Cover to Crankcase
- 1—S-12-223 Tubing—Pressure Inlet, Flexible
- 1—S-20-128 Gasket—Needle Valve Body & Case
- 1—S-20-312 Gasket—Fuel Tank Cap
- 1—S-21-102 Gasket—Fuel Pump & Gear Case
- 1—S-21-108 Gasket—Container to Cartridge
- 1—S-21-203 "O" Ring—Fuel Meter to Intake Manifold
- 1—S-21-204 Gasket—Fuel Meter to Gear Case Cover
- 1—S-21-210 Gasket—Fuel Bleed Line
- 1—S-21-313 Gasket—Fitting to Tank
- 2—S-21-402 Washer—Synthetic
- 1—S-21-405 "O" Ring—Air Cleaner Housing to Fuel Meter
- 1—S-31-107 Gasket—Magneto Cover to Stator Plate
- 1—S-31-109 Washer—Felt
- 2—S-50-1033 Washer—Sealing—Oil Pick Up and Valve Check
- 3—S-60-403 Seal—Oil

**Engine Gasket Set (Small Set) Part No. 5-61-405**

Consists of:

- 1—S-11-117 Gasket—Crankcase to Crankcase—Large
- 1—S-11-118 Gasket—Crankcase to Crankcase—Small
- 1—S-11-403 Gasket—Cylinder to Crankcase
- 1—S-11-502 Gasket—Intake Manifold
- 1—S-11-701 Gasket—Exhaust Manifold
- 1—S-12-222 Gasket—Gear Case Cover to Gear Case Half of Crankcase
- 1—S-20-312 Gasket—Fuel Tank Cap
- 1—S-21-102 Gasket—Fuel Pump to Gear Case
- 1—S-21-204 Gasket—Fuel Meter to Gear Case Cover

- Bendix - Scintilla Magneto -  
Sidney, N.Y. USA  
Serial - 510515  
Model K1-10