



CLINTON CHAINSAWS

FIRST DIGIT-POWER HEADS

TYPE 55, 56, 57

SEC. II, Digit 1

PARTS CATALOG

Issued July, 1958

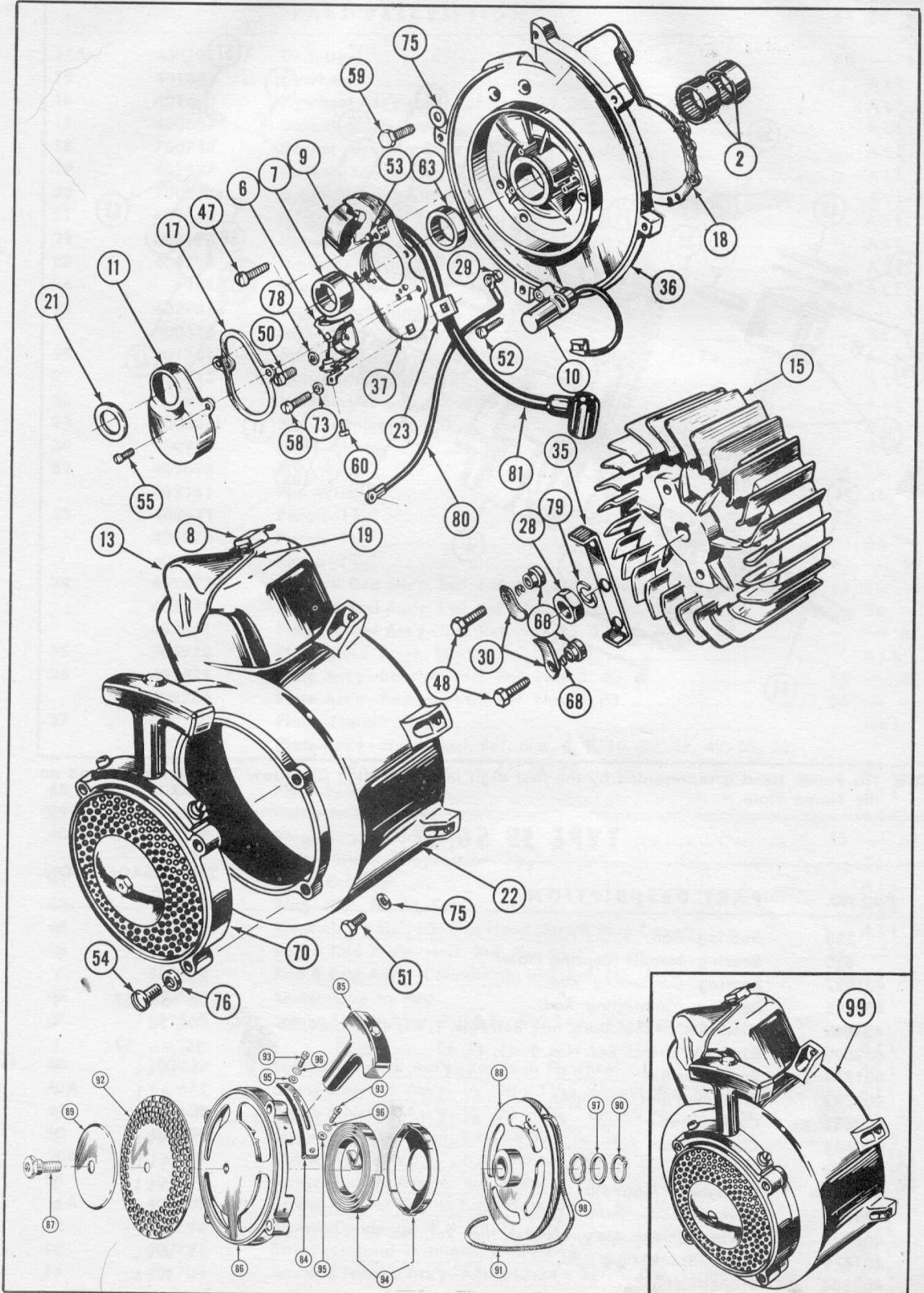

TYPE 55, 56, 57

PART DESCRIPTION			TYPE USAGE		
			55	56	57
14A	402727	Deflector	55	—	57
15	401681	Flywheel		ALL	
16	401680	Flywheel Ass'y—Incl. Ref. Nos. 15, 30, 35, 48, 66, 68		ALL	
17	400609	Gasket—Dust Cover		ALL	
18	700743	Gasket—Bearing Plate to Cylinder Block		ALL	
19	401987	Gasket—Spark Plug Cover		ALL	
20	700038	Gasket—Muffler to Block		ALL	
21	401568	Grommet—Dust Cap (Rubber)		ALL	
22	401677	Housing—Blower, Incl. Ref. Nos. 8, 13, 19, 44		ALL	
23	400795	Insulator—Terminal		ALL	
24	958	Key—Flywheel		ALL	
25	402701	Lock—Piston Ring	55	—	57
	400616	Lock—Piston Ring	—	56	—
26	401761	Muffler Ass'y—Incl. Ref. Nos. 5, 12, 27, 56, 67, 71, 74		ALL	
27	402235	Nut—Muffler, #10-32 x 1/4"		ALL	
28	838	Nut—Starter Cup, 7/16" x 20 Hex.		ALL	
29	400801	Nut—Terminal, #6-32		ALL	
30	700915	Pawl—Starter		ALL	
32	402673	Pin—Wrist	55	—	57
	402131	Pin—Wrist	—	56	—
33	402671	Piston—1 7/8"	55	—	—
	401076	Piston—2 1/8"	—	56	—
	402806	Piston—1 7/8"	—	—	57
34	402672	Piston & Rod Ass'y, Incl. Ref. Nos. 25, 32, 33, 39, 40, 45	55	—	—
	402132	Piston & Rod Ass'y, Incl. Ref. Nos. 25, 32, 33, 39, 40, 45	—	56	—
	402808	Piston & Rod Ass'y—Incl. Ref. Nos. 25, 32, 33, 39, 40, 45	—	—	57
35	700913	Plate—Base Pawl, Starter		ALL	
36	401675	Plate Ass'y—Bearing, Incl. Ref. Nos. 2, 63	55	—	57
	402286	Plate Ass'y—Bearing, Incl. Ref. Nos. 2, 63	56	—	—
37	400790	Plate—Stator		ALL	
	400692	Plate Ass'y—Stator, Incl. Ref. Nos. 6, 9, 10, 29, 37, 49, 52, 53, 58, 61, 63, 72, 73, 77, 78, 83		ALL	
38	402237	Plug—Spark		ALL	
39	663	Retainer—Wrist Pin		ALL	
40	402698	Ring—Piston, Compression, 1 7/8"	55	—	57
	400615	Ring—Piston, Compression, 2 1/8"	—	56	—
41	234	Ring—Retainer		ALL	
42	700893	Ring—(Cyl. Block), Seal		ALL	
44	401866	Rivet—1/8" x 3/16", LG. Flat Head (Spark Plug Cover)		ALL	
45	401770	Rod & Cap Ass'y—Incl. Ref. No. 46	55	—	—
	400093	Rod & Cap Ass'y—Connecting, Incl. Ref. No. 46	—	56	57
46	400585	Screw—Cap to Rod		ALL	
47	401566	Screw & L.W. Assy—P.H.S.T., #10-24 1", Mag. Ass'y to Brg. Plate		ALL	
48	701028	Screw & Nylock Ass'y—Pawls to Flywheel		ALL	
48A	671	Screw & Nylock Ass'y—1/4"-20 x 1 1/2", Blower Hsg. to Strut Brace		ALL	
49	401630	Screw & Nylock Ass'y—1/4"-20 x 1 3/8", Blower Hsg. to Tank	—	56	—
50	400799	Screw—Breaker Point, P.H. #8-32 x 3/16"		ALL	
50A	671	Screw—1/4"-20 x 1 1/2", F.H., Blower Hsg. to Bearing Plate	55	—	57
51	401708	Screw—Blower Hsg. to Brg. Plate, F.H.M. 1/4"-20 x 7/8" (Nylock)	55	—	57
51A	401708	Screw—Blower Hsg. to Brg. Plate, F.H.M. 1/4"-20 x 7/8" (Nylock)	—	56	—
52	400798	Screw—Condenser, F.H. #8-32 x 5/8"		ALL	
53	400791	Screw—Ground Terminal, #4-40 x 1/4"		ALL	
54	401704	Screw & Nylock Ass'y—F.H. #12-24 x 7/8", Starter to Blower Hsg.		ALL	

NOTE: Specify Model, Type Number and Serial Number when ordering Repair Parts.

FIRST DIGIT—POWER HEADS

TYPE 55,56,57

	PART DESCRIPTION	TYPE USAGE			Qty.
		55	56	57	
55	401565	Screw—Magneto Dust Cover, S.T. #6-32 x 3/8"	ALL		2
56	402529	Screw—Muffler Body to Block, S.H. 1/4"-20 x 3/4" N.C.	ALL		2
57	363	Screw—Muffler Cap to Body, 1/4"-20 x 1" S.H.H.	ALL		1
58	400797	Screw—Terminal, F.H. #6-32 x 3/4"	ALL		1
59	401941	Screw & Nylock Ass'y—H.H.C., 1/4" 20 x 7/8", Brg. Plate to Block	ALL		2
59A	400179	Screw & Nylock Ass'y—H.H.C. 1/4"-20 x 3/4", Brg. Plate to Block	—	56 57	4
60	400179	Screw—Breaker Terminal	ALL		1
60A	698	Screw—R.H.S.T. #8-32 x 3/8", Deflector to Block	ALL		2
61	400802	Screw & Nylock Ass'y—Breaker Terminal	ALL		1
62	402407	Seal—Oil (Cyl. Block)	ALL		1
63	257-1	Seal—Oil (Bearing Plate)	ALL		1
64	400198	Shim—Chankshaft, .002"	—	56 —	As req'd
65	515	Shim—Crankshaft, .005"	—	56 —	As req'd
66	700914	Spacer—Starter	ALL		2
67	*N.S.S.	Spark Arrestor & Screen Ass'y—Muffler	ALL		1
68	401865	Spring—Starter Pawl	ALL		2
69	402309	Spring—Muffler	ALL		2
70	402454	Starter Ass'y—Recoil—See Parts List below	ALL		1
71	401479	Tab Lock—Muffler to Block	ALL		1
72	400800	Washer—Breaker Spring, Screw	ALL		1
73	400803	Washer—Lock #8, Connector Wire	ALL		2
74	400624	Washer—Flat, #10, Muffler	ALL		1
74A	480	Washer—1/4", Blower Hsg. to Tank	ALL		1
75	657	Washer—Flat, 1/4", Brg. Plate to Block—4; Blower Hsg. to Brg. Plate—5	ALL		9
76	674	Washer—Starter to Blower Hsg.	ALL		4
77	400796	Washer—Insulator	ALL		1
78	192	Washer—Lock, #10, Mag. to Blower Plate	ALL		2
79	400874	Washer—7/16" I.D. (Crankshaft to Flywheel)	ALL		1
80	402719	Wire—Shorting	ALL		1
81	400794	Wire—Hi-Tension, Lead	ALL		1
82	402532	Wire—Lock	ALL		1
83	400793	Wire—Connector	ALL		1
		STARTER ASS'Y NO. 402454			
		Incl. Ref. Nos. 84 thru 98	ALL		
84	401834	Guide—Rope	ALL		1
85	700949	Handle—Starter	ALL		1
86	402459	Housing	ALL		1
87	402493	Plug—Grease	ALL		1
88	401869	Pulley	ALL		1
89	402457	Retainer—Screen	ALL		1
90	401947	Ring—Retaining	ALL		1
91	700943	Rope	ALL		1
92	402458	Screen	ALL		1
93	701016	Screw—#10-24 x 1/2" (Pull Guide to Starter Hsg.)	ALL		2
94	401835	Spring & Cup Ass'y	ALL		1
95	192	Washer—#10, Lock	ALL		2
96	400624	Washer—#10, Plain	ALL		2
97	401946	Washer—Steel, Retaining	ALL		1
98	401945	Washer—Wave	ALL		1
		NEW ENGINE			
99	402807	Power Head	55	— 57	1
	402805	Power Head	— 56	—	1

*Not serviced separately.

NOTE: Specify Model, Type Number and Serial Number when ordering Repair Parts.

This document was created with Win2PDF available at <http://www.daneprairie.com>.
The unregistered version of Win2PDF is for evaluation or non-commercial use only.